



Ridgmount Gardens

Bloomsbury, WC1E

£3,141.67 per month
(£725 per week)

Found on the 2nd floor (with lift) of this mansion block is a bright apartment boasting over 700ft² of living space. The property benefits from period features & access to communal gardens. Convenient for the Central & Northern Line. VIDEO VIEWING.



Ridgmount Gardens

Bloomsbury, WC1E

- Bright 2nd floor apartment
- Period mansion block
- Finished to a high standard throughout
- Close to Central Line & Goodge Street stations



This bright south facing apartment is on the 2nd floor of a period mansion block (with lift) convenient for Tottenham Court Road & Goodge Street tube stations. VIDEO VIEWING AVAILABLE.

Comprising of a large reception with feature fireplace, separate fully fitted kitchen, 2 double bedrooms and 1 bathroom. With access to communal gardens.

Minimum Term: 12 months
Deposit Required: £3,625.00
Local Authority: Camden
Council Tax Band: F
EPC Rating: C
Unfurnished

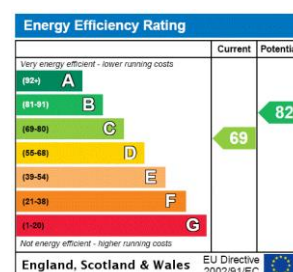

Chestertons Covent Garden Lettings

196 Shaftesbury Avenue
 Covent Garden
 London
 WC2H 8JF
 coventgarden@chestertons.co.uk
 02030408400
 chestertons.co.uk

Additional tenant charges apply (fees apply to non-AST tenancies only)
 Tenancy Agreement Fee: £300
 References per Tenant/Guarantor: £60
 Inventory check (approx. £100 – £250 inc. VAT)
 chestertons.co.uk/property-to-rent/applicable-fees

Ridgmount Gardens

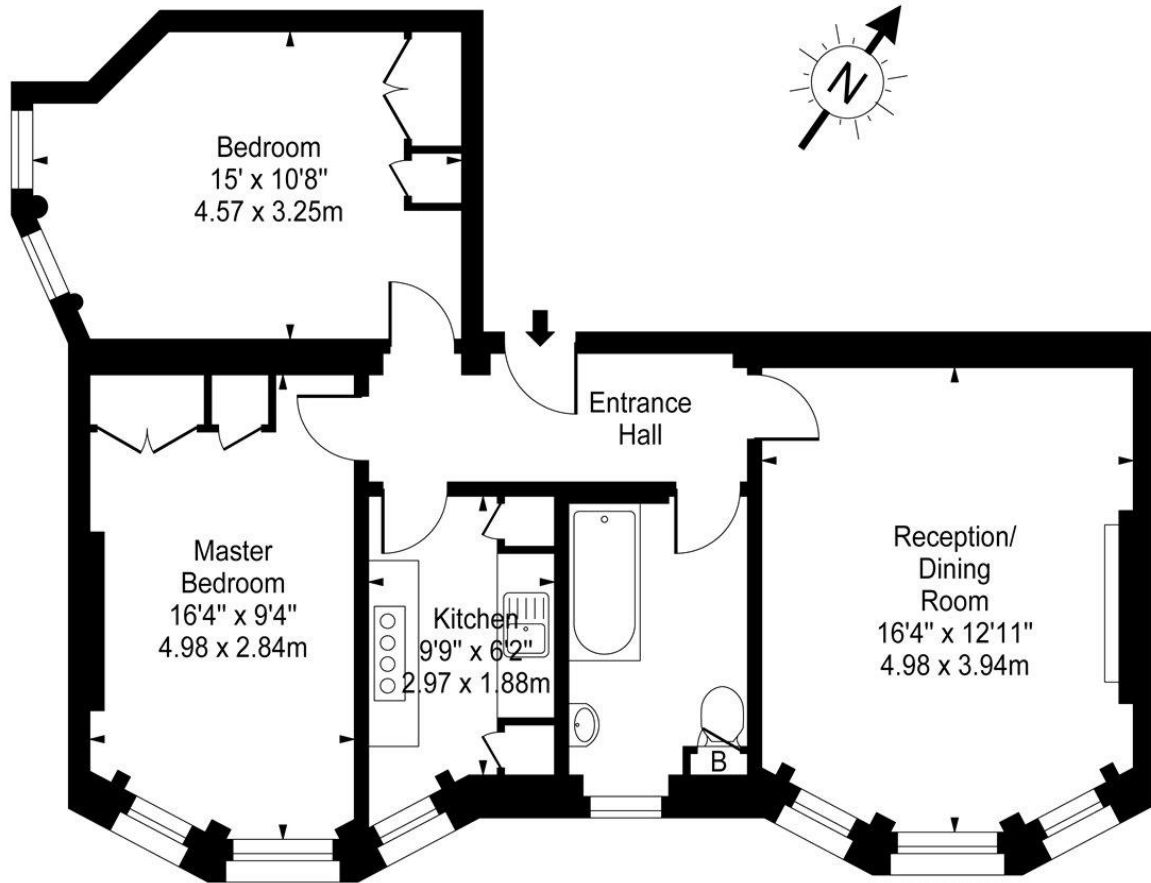

Second Floor

Approx Gross Internal Area 723 Sq Ft - 67.17 Sq M

For Illustration Purposes Only - Not To Scale

www.goldlens.co.uk

Ref. No. 005226M

