



Finzels Reach, Bristol , BS1

Monthly Rental Of £1,500

- **Modern one bed**
- **Riverside location**
- **Beatifully finished kitchen**
- **Floor to ceiling windows**
- **Ample storage**
- **Light and Contempary Feel**



Finzels Reach, Bristol , BS1

Modern and contemporary one bed city centre apartment in the exclusive Finzels Reach development. Superbly finished kitchen and bathroom suite and floor to ceiling windows throughout.

Kitchen / Living area

Modern kitchen and living area with floor to ceiling windows, measurements taken at widest.

21' 0" x 16' 6" (6.40m x 5.03m)

Bedroom

Large double bedroom with storage.

18' 0" x 11' 4" (5.48m x 3.45m)

Bathroom

Modern tiled bathroom

8' 0" x 6' 5" (2.44m x 1.95m)

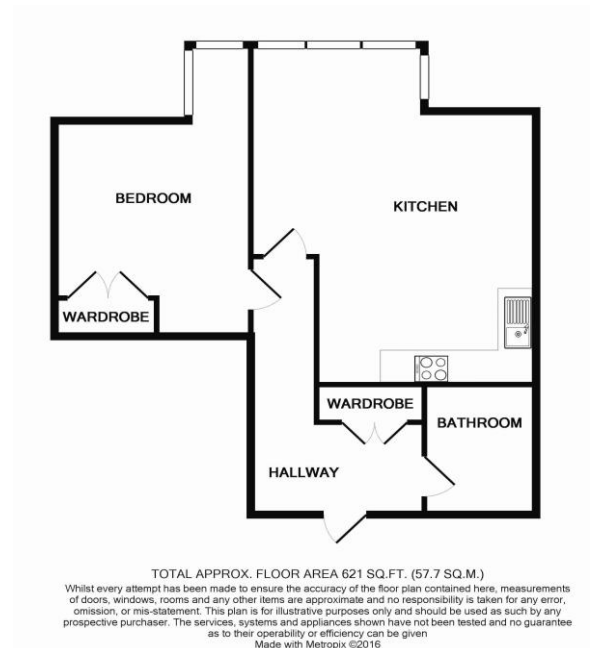

Energy Efficiency Rating		Current	Potential
Very energy efficient - lower running costs			
(92-100)	A		
(81-91)	B		
(69-80)	C	79	79
(55-68)	D		
(39-54)	E		
(21-38)	F		
(1-20)	G		
Not energy efficient - higher running costs			
England, Scotland & Wales		EU Directive 2002/91/EC	

Environmental Impact (CO ₂) Rating		Current	Potential
Very environmentally friendly - lower CO ₂ emissions			
(92-100)	A		
(81-91)	B		
(69-80)	C	75	75
(55-68)	D		
(39-54)	E		
(21-38)	F		
(1-20)	G		
Not environmentally friendly - higher CO ₂ emissions			
England, Scotland & Wales		EU Directive 2002/91/EC	

46 College Green, The Harbourside, Bristol BS1 5SH

0117 928 1900

info@harboursidepropertygroup.co.uk

Harbourside Property Group is a trading name for Harbourside Lettings Ltd. Registered in England No. 6592539. Harbourside Financial is directly authorised by the FCA. Particulars are set out as a general guide and do not constitute any part of a contract. No person acting for Harbourside Property Group or Harbourside Financial have any authority to give any representation or warranty in relation to this or any other property. H988