



Springfield House
Well Lane | Chepstow | Monmouthshire | NP16 6LP



Step inside

Springfield House

Guide price £2,000,000

This grand, modern-day mansion enjoys a secluded location in the idyllic Monmouthshire countryside, yet it is within easy reach of the A48, M4 and M48, ideal for commuting to Bristol, Cardiff, Newport and beyond.

Constructed to a high specification, the spacious property (approximately 9,537 sq ft) has recently undergone a comprehensive refurbishment. It has a stunning new kitchen, luxurious bathroom and en-suites, and has been stylishly redecorated throughout. All the double glazed windows and exterior glazed doors are newly installed and new carpets have been recently fitted throughout. The immaculately presented accommodation includes four reception rooms, five/six bedrooms and a two/three-bedroom annex, making it suitable for large families and multi-generational living. It also has the benefit of level wheelchair access and a recently-installed, well-maintained passenger lift to the first floor.

The property has been fitted out with high quality drapes, lighting and furnishings, carefully chosen by the vendors, one of whom is a professional interior designer. These are all available to purchase, subject to negotiation.

The L-shaped residence is situated in mature grounds of approximately 1.3 acres, in an elevated, south-facing position, just above the highly desirable, rural village of Llanvair Discoed. From the house and grounds, there are spectacular views over the Severn Estuary and also to Wentwood Forest, the largest ancient woodland in Wales and ninth largest in the UK, where there is excellent walking, mountain biking and hacking.

Llanvair Discoed, with its ancient church and village pub, lies just north of the A48 road, with easy access to the schools, shops and facilities in Caldicot (under 6 miles); to the market town of Chepstow (about 7 miles); to the pretty riverside town of Usk (8 miles) and to the city of Newport (10 miles). It falls within the catchment of the well-regarded Shirenewton Primary School. Independent schools in the area include the Haberdashers' Monmouth boys' and girls' schools, less than 20 minutes away. For golfers, the Celtic Manor Golf Course and St Pierre Golf Club are both 7 miles distant.

Step inside:-

The property is accessed from a quiet country lane through electrically-operated wrought iron entrance gates, with an intercom system. A sweeping, tree-lined, paved drive leads to the front of the house, where there is a turning circle and parking for six cars in front of a pair of integrated double garages.

Double glazed entrance doors, under a large and impressive portico, give access to a bright and airy, reception hall with Travertine flooring. The flexible, ground floor accommodation boasts four reception rooms. The magnificent drawing room has newly-laid oak flooring and a wood burner fitted into a handsome marble fireplace. The formal dining room has refurbished parquet flooring, cornicing, a central ceiling rose and double French doors leading though to a day room, which has oak flooring, large, floor-to-ceiling bay windows and glazed doors to the expansive sun terrace which runs along the front of the house. There is also a large family/TV room again with new oak flooring and LPG fire set into a decorative marble fireplace.

In addition to these reception rooms, there is a large, flexible space, from which a short flight of balustraded steps lead up to a mezzanine giving access to the single storey annex. The vendors suggest: "It is large enough for a grand piano, or would make an ideal music room or alternatively a reading room or games room." Furthermore, behind the integrated garages, with French doors to the back garden, is a home gym.

The stunning, new kitchen has a range of Symphony shaker-style units with marble work surfaces. There is a large central breakfast/work island and a comprehensive range of inbuilt appliances, plus an American-style fridge freezer, a wine cooler and a five-oven electric Aga. The attractive Carrara marble effect porcelain floor tiles used in the kitchen are carried through into the large, downstairs cloakroom, fitted with a marble-topped vanity unit. The utility room has fitted cupboards, a commercial Miele washing machine and commercial Miele tumble drier.



The property has ample storage and utility areas - there's a room which houses an additional fridge and freezer; a large cleaning cupboard; a wine cellar; a boiler room and a storage area for garden machinery.

From the main entrance hallway, stairs lead up to a spacious galleried landing with a feature arched window over. The fabulous principal suite has three large picture windows giving beautiful views over the garden and surrounding countryside to the Severn Estuary. "We get a very clear view of the old Severn bridge, which twinkles in the distance when it is lit up at night." The spacious bedroom has fitted cupboards, its own dressing room with bespoke fitted wardrobes, a make-up room and a luxurious en-suite shower room featuring a walk-in, waterfall shower and a marble-topped vanity unit.

The extremely spacious second principal bedroom shares the same views towards the Severn Estuary and has a dressing room with fitted, mirrored wardrobes. There are three further, beautifully presented double bedrooms, one with its own dressing room, and each with a stylishly fitted en-suite shower room. On this floor there is a further room, currently used as a home office, but which could be used as an additional bedroom.

The impressive family bathroom has Carrara marble effect porcelain floor tiles, an attractive double-sink vanity unit with a marble top and upstand and is fitted with a free-standing roll-top bath positioned under a large bay window. "The views are incredible. It is so private that you can sit in the bath, without the need for blinds or curtains, and enjoy the view over the fields towards Wentwood."

The annex, along one side of the property, can be accessed from the mezzanine but also has its own external door. It is currently arranged as guest accommodation but could be used separately from the main house. There is a kitchen, small WC and two double bedrooms, each with an en-suite shower room. The room being used as the lounge also has an en-suite shower room, so could be used as an additional bedroom. A further room that's being used as an office could then serve as the lounge.







Step outside

Springfield House

The property is set in well-tended grounds with large lawned areas front and back, featuring established trees and mature planting. There is a large raised sun terrace along the front of the property, another terrace at the back and an area of decking.

"On fine days, we have lunch on the front terrace, enjoying the views towards the Severn Estuary, over the trees and without a rooftop in the way. From the kitchen, there are French doors to the rear patio and from about 3 o'clock onwards, that' area is bathed in sunshine and that's where we entertain into the evenings."

DIRECTIONS

From Chepstow take the A48 road to Newport. Turn right signposted Llanvair Discoed and continue along the lane for just under a mile. On reaching Llanvair Discoed, take the second right into Well Lane and carry on for approximately 0.2 miles and the entrance gates to the property will be on your left hand side.



Approximate Gross Internal Area 886 Sq M/9537 Sq Ft

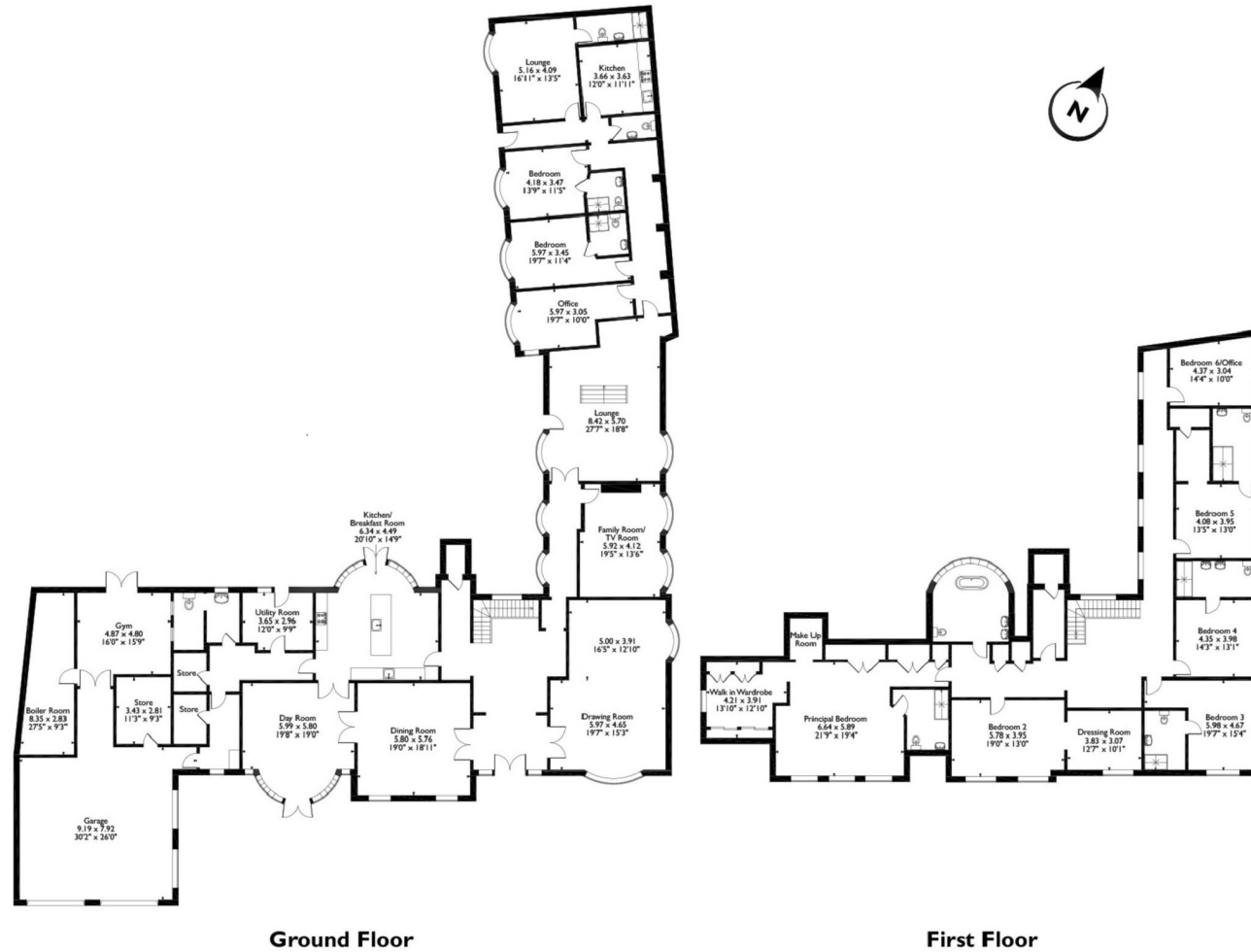

Please note that the location of doors, windows and other items are approximate and this floorplan is to be used for illustrative purposes only. Unauthorized reproduction is prohibited.

Postcode: NP16 6LP | Tenure: Freehold | Tax Band: I | Authority: Monmouthshire | Heating: Gas LPG | Drainage: Private



*Internet speed according to the BT Availability Service using the postcode and landline
All measurements are approximate and for general guidance only and whilst every attempt has been made to ensure accuracy, they must not be relied on. The fixtures, fittings and appliances referred to have not been tested and therefore no guarantee can be given that they are in working order. Internal photographs are reproduced for general information and it must not be inferred that any item shown is included with the property. Copyright© 2019 Fine & Country. Registered in England and Wales. Company Reg No. 09165140. Registered at 30 High Street, Chepstow, Monmouthshire NP16 5LJ

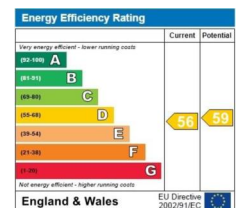



Fine & Country
Tel: 01291 629799
chepstow@fineandcountry.com
30 High Street, Chepstow, NP16 5LJ