



MacPhee & Partners

Plot at Croft 2 Bohuntin, Bohuntinville, Roy Bridge, PH31 4AH



PRICE GUIDE: £58,000

- Elevated Building Plot
- Stunning Views towards the Surrounding Mountains and Countryside
- Idyllic Rural Location
- Planning Permission in Principle for a Detached Property
 - Services Available Close to Site
 - Around 0.5 Acres

The sale offers an excellent opportunity to purchase an elevated building plot in the small settlement of Bohuntinville on the outskirts of Roy Bridge village. Enjoying stunning views over the surrounding countryside towards the Grey Corries and Nevis Range of mountains, the plot extends to around 0.5 acres and benefits from Planning Permission in Principle for a detached house. To the rear of the plot, there are 7 trees which are to be preserved.

Location

Bohuntinville is located amidst spectacular Highland scenery some 2 miles from Roy Bridge with its hotels, railway station and excellent nursery and primary school in the neighbouring village of Spean Bridge. Extra services and amenities are available a further 13 miles distant at the principal town of Fort William. Whilst the area offers seclusion, it is also an ideal base to take advantage of all the leisure and pleasure activities the area has to offer.

Planning Permission

Planning Permission in Principle was granted on 31st May 2018 (Ref:18/01759/PIP) for the erection of a detached dwellinghouse, formation of access and installation of a septic tank. Copies of this Planning Permission and approved plans are available on the Highland Councils website or on request with the selling agent.

Services

It will be the purchaser's responsibility to connect to the services. Electricity and water will be to the mains supply nearby the site whilst drainage will be to a private septic tank. It will also be the purchaser's responsibility to create the access track to the site.

Travel Directions

From Fort William, proceed north for 10 miles on the A82 Inverness Road. At Spean Bridge, turn right on to the A86 road, signposted Newtonmore, for 3 miles to Roy Bridge. In the village, turn left where signposted Glen Roy, Bohuntin & Brae Roy, passing St Margaret's Church. Continue on this road for approximately 1.5 miles, turning left where signposted Bohuntinville. The access to the plot is approximately 150 metres on the left hand side, just beyond Innis Beag and left of The Rowans.

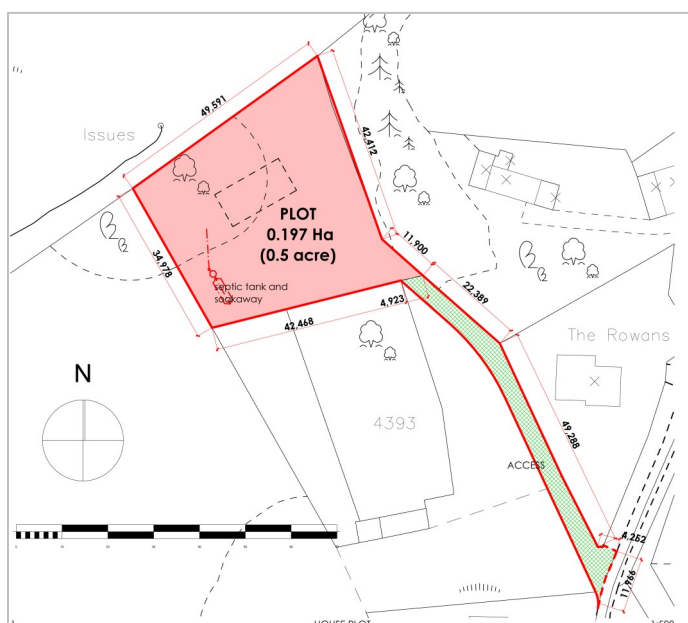

KEY:

The green shaded area indicates where the access road is to be formed, with a deed of servitude granted over this area. The pink shaded area indicates the actual plot site.



These particulars were prepared on the basis of our knowledge of the local area and, in respect of the property itself, information supplied to us by our clients. All reasonable steps were taken at the time of preparing these particulars to ensure that all details are accurate. All statements contained in the particulars are for information only and all parties should not rely on them as representations of fact; in particular:- (a) descriptions, measurements and dimensions are approximate only; (b) all measurements are taken at the widest points; and (c) all references to condition, planning permission, services, usage, construction, fixtures and fittings and moveable items contained in the property are for guidance only. Our clients may instruct us to set a closing date for offers and therefore if you wish to pursue interest in this property you should immediately instruct your solicitor to note interest with us. Our clients reserve the right to conclude a bargain for the sale of the subjects ahead of a closing date and will not be obliged to accept either the highest or indeed any offer for the subjects or any part thereof. All measurements are taken using a sonic tape measure and therefore may be subject to a small margin of error. None of the services or appliances have been checked by us and no warranty is given as to their condition. All arrangements to view must be made by prior appointment with MacPhee and Partners. MacPhee & Partners is a trading name of MacPhee & Partners LLP a Limited Liability Partnership registered in Scotland (SO305286) and having its Registered Office at Airds House, An Aird, Fort William, PH33 6BL. It is the responsibility of all prospective viewers to check with the agents prior to viewing the property to ensure that it is still available for sale, particularly with regard to long journeys or those viewings arranged some time in advance. Offers are invited in the style of the Scottish Standard Offer and incorporating the Scottish Standard Clauses (Edition 3).