

PRIME ESTATES

INDEPENDENT ESTATE AGENTS

167 - 169 Church Road, Yardley, Birmingham, B25
8UR
0121 783 3422
yardley@primeestatesuk.com



Fieldhead Road, Birmingham | Asking Price £170,000

**** IDEAL FIRST TIME BUY ** TWO DOUBLE BEDROOMS ** SOUGHT AFTER LOCATION ** IN NEED OF SOME UPDATING ****

AN OPPORTUNITY TO PURCHASE THIS HOME WHICH IS SITUATED IN A VERY POPULAR LOCATION FIELDHEAD ROAD, TYSELEY PROPERTIES ON THIS ROAD DO NOT STAY ON THE MARKET FOR LONG!! This terrace house is accessed via DRIVEWAY leading to front door the accommodation comprises:- hallway, LOUNGE, GUEST W.C, KITCHEN and rear garden. TWO BEDROOMS and BATHROOM to the first floor.

The property benefits double glazing and central heating both where specified.

CALL OUR YARDLEY OFFICE ON 0121-783-3422 FOR A VIEWING NOW!

Energy Performance Rating: awaiting

www.primeestatesuk.com

**** IDEAL FIRST TIME BUY ** TWO DOUBLE BEDROOMS ** SOUGHT AFTER LOCATION ** IN NEED OF SOME UPDATING ****

AN OPPORTUNITY TO PURCHASE THIS HOME WHICH IS SITUATED IN A VERY POPULAR LOCATION FIELDHEAD ROAD, TYSELEY PROPERTIES ON THIS ROAD DO NOT STAY ON THE MARKET FOR LONG!! This terrace house is accessed via DRIVEWAY leading to front door the accommodation comprises:- hallway, LOUNGE, GUEST W.C, KITCHEN and rear garden. TWO BEDROOMS and BATHROOM to the first floor.

The property benefits double glazing and central heating both where specified.

CALL OUR YARDLEY OFFICE ON 0121-783-3422 FOR A VIEWING NOW!

Energy Performance Rating: awaiting

Approach

Access is gained via driveway leading to:

Hallway

Door to:

Lounge

11'5 x 15'9 (3.48m x 4.80m)

Double glazed window to front and central heating radiator.

Kitchen

12'6 x 7'7 (3.81m x 2.31m)

Two double glazed windows to rear, door to rear. a range of wall base and drawer units with work surface over, stainless steel sink and drainer with taps over, central heating radiator and door to stairs.

FIRST FLOOR

Landing

Central heating radiator, loft access and doors to:

Bedroom One

12'7 x 8'4 (3.84m x 2.54m)

Double glazed window to rear, central heating radiator and over stairs storage cupboard

Bedroom Two

11' x 7'10 (3.35m x 2.39m)

Double glazed window to rear and central heating radiator.

Bathroom

8'11 x 7'4 (2.72m x 2.24m)

Double glazed frosted window to front, central heating radiator, suite comprising low level w.c, pedestal wash hand basin and panelled bath.

OUTSIDE

Rear Garden

With patio are and lawned area

Ground Floor

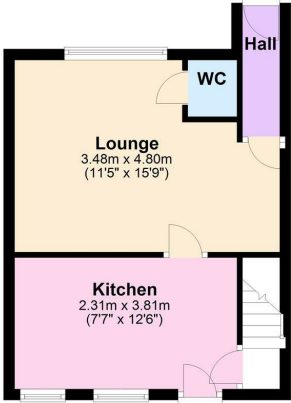

First Floor

