

TO-LET

£12,000 P/A

TERMS TO BE
NEGOTIATED



**TO-LET. FORMER DENTIST SURGERY
SUITABLE FOR A VARIETY OF
COMMERCIAL USES, SUBJECT TO
CONSENTS BEING OBTAINED.**

**High Street, Eastchurch
ME12 4DF**





GROUND FLOOR
939 sq. ft. (87.2 sq.m.) approx.

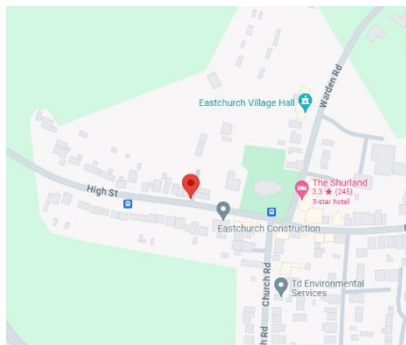
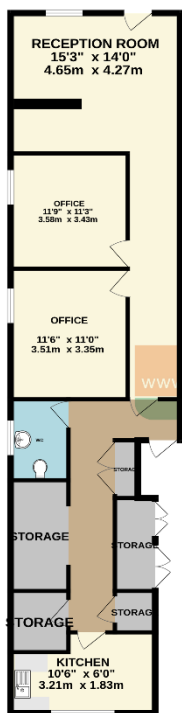

www.ruleandrule.co.uk
independent estate agents

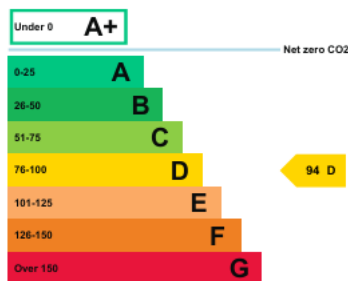

TOTAL FLOOR AREA: 939 sq. ft. (87.2 sq.m.) approx.
While every attempt has been made to ensure the accuracy of the floorplan contained here, measurements of doors, windows, stairs and any other items are approximate and no responsibility is taken for any error, omission or mis-statement. This plan is for illustrative purposes only and should be used as such by any prospective purchaser. The services, systems and appliances shown have not been tested and no guarantee is given for their regularity or efficiency can be given.
Made with Metagis CO2-24

Rule & Rule are pleased to offer this former dentist surgery, now available to let at £12,000 per annum on terms which can be negotiated.

The property comprises a single storey former bungalow with 6 separate rooms, all with nonslip flooring, plenty of power sockets, double glazing where stated and gas fired central heating. Suitable for a variety of uses subject to consent being obtained from Swale Borough Council.

Call Mark at the office to discuss terms.

MONEY LAUNDERING REGULATIONS 2007: Intending purchasers will be asked to produce identification and proof of financial status when an offer is received. We would ask for your co-operation in order that there will be no delay in agreeing the sale. **THE PROPERTY MISDESCRIPTIONS ACT 1991** - Rule and Rule has not tested any apparatus, equipment, fixtures and fittings or services and so cannot verify that they are in working order or fit for the purpose. A Buyer is advised to obtain verification from their Solicitor or Surveyor. References to the Tenure of a Property are based on information supplied by the Seller. Rule and Rule have not had sight of the title documents. A Buyer is advised to obtain verification from their Solicitor. You are advised to check the availability of this property before travelling any distance to view. We have taken every precaution to ensure that these details are accurate and not misleading. If there is any point which is of particular importance to you, please contact us and we will provide any information you require. This is advisable, particularly if you intend to travel some distance to view the property. The mention of any appliances and services within these details does not imply that they are in full and efficient working order. These particulars are in draft form awaiting Vendors confirmation of their accuracy. These details must therefore be taken as a guide only and approved details should be requested from the agents. Covenants may apply to this property.