

18 Stratton Road, Whalley Range, Manchester, M16 0BB





3 1 2 D

VIDEO TOUR AVAILABLE An attractive, THREE BEDROOM, extended, bay fronted semi-detached property. Situated on a popular tree-lined residential road off Manchester Road.

Within walking distance to local amenities of Chorlton on Manchester Road and Whalley Range on Clarendon Road, the Metrolink station on Rye Bank Road in Firswood giving you direct access into the city centre & Media city. Manley Park primary school nearby and Manley Park with a children's playground.

In brief the spacious accommodation comprises: porch, entrance hallway with a useful storage cupboard, a family room with a bay window to the front aspect, an extended lounge with French doors leading out into the rear garden, a through kitchen/dining room with a breakfast bar to the ground floor with access to the rear.

The first floor reveals a landing leading to three good sized bedrooms, a separate W.C and a three-piece bathroom with a shower cubicle. There is also access into the large loft space off the landing.

The property also benefits from being warmed by a Worcester combi boiler providing gas fired central heating, a paved driveway providing off road parking with double gates leading a further useful driveway, enclosed lawned rear garden with a paved patio.

Would ideally suit a professional couple or a young family due the location and early inspection is highly recommended.

£475,000





EPC Chart

Energy Efficiency Rating		Current	Potential
Very energy efficient - lower running costs			
(92 plus)	A		
(81-91)	B		
(69-80)	C		78
(55-68)	D	64	
(39-54)	E		
(21-38)	F		
(1-20)	G		
Not energy efficient - higher running costs			
England & Wales		EU Directive 2002/91/EC	



Tenure: Freehold Council Tax Band: C

Ground Floor

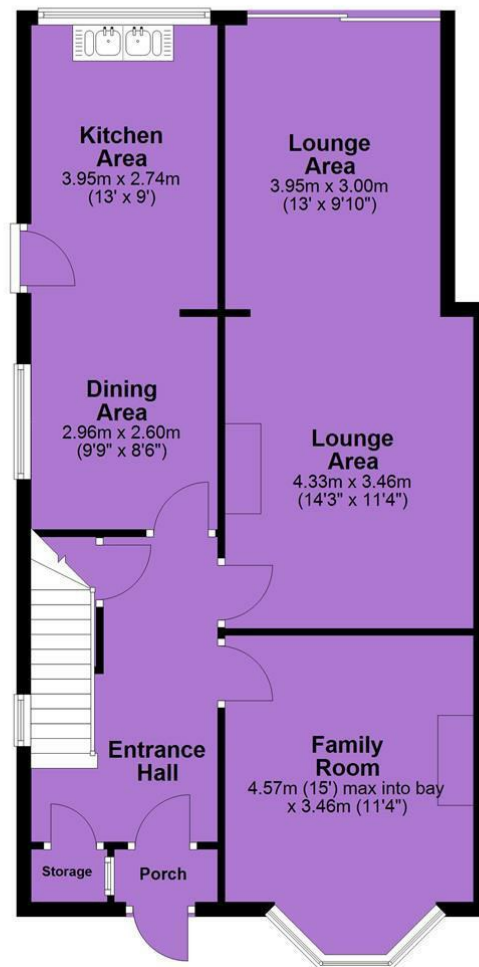

First Floor

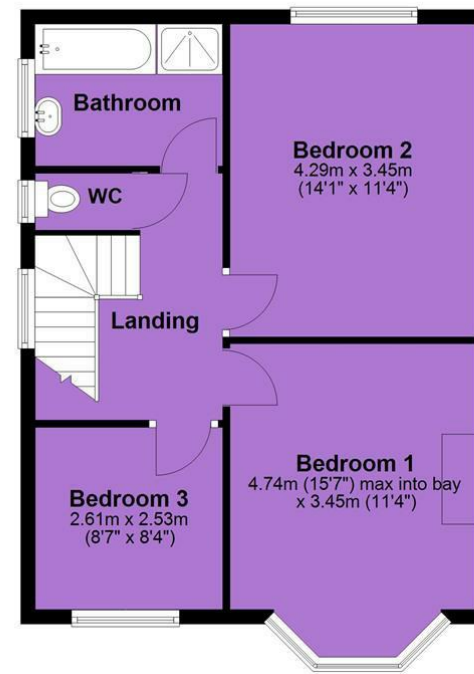

JP & Brimelow Estate Agents Ltd
430 Barlow Moor Road, Manchester, M21 8AD
Tel: 0161 8822233

E: sales@jpbrimelow.co.uk www.jpandbrimelow.co.uk



JP & Brimelow
ESTATE AGENTS

NOTICE: JP & Brimelow Estate Agents Ltd for themselves and for the vendors or lessors of this property whose agents they are give notice that:

- (i) the particulars are set out as a general outline only for the guidance of intending purchasers or lessees, and do not constitute, nor constitute part of, an offer or contract;
- (ii) all descriptions, dimensions, references to the condition and necessary permissions for use and occupation, and other details are given in good faith and are believed to be correct but any intending purchasers or tenants should not rely on them as statements or representations of fact but must satisfy themselves by inspection or otherwise as to the correctness of each of them;
- (iii) no person in the employment of JP & Brimelow Estate Agents Ltd has any authority to make or give any representation or warranty whatever in relation to this property.

jpandbrimelowestateagents

@jpandbrimelow

