

Apt 35 The Hawthorns 114 Edge Lane, Stretford, Trafford, M32 8QA



JP&Brimelow
ESTATE AGENTS

Asking Price £115,000



VIDEO TOUR AVAILABLE A well-presented and light, ONE DOUBLE BEDROOM, first floor apartment at the side of this purpose built-development on Edge Lane, overlooking the communal lawned gardens. Situated in this highly popular development for the over 55's with open views into Longford Park here in Stretford. Located between both the centre of Chorlton and Stretford with all its local amenities. Good bus routes, Stretford food hall and the Stretford Metrolink station on Edge Lane, giving you direct access into the city centre. This well-planned apartment consists of a communal entrance hallway, a communal lounge/dining room with a kitchen area, a lift and stairs to all floors, a private entrance hallway, a double bedroom, a three-piece shower room, a spacious lounge/dining room with views into the lawned gardens and a fitted kitchen area. The apartment is warmed by electric heating, has a 24-hour emergency care line response system, an on-site house manager, communal mature lawned gardens to the front, side and rear aspect and off-road parking to the rear aspect for both residents and visitors. OFFERED WITH NO VENDOR CHAIN.





EPC Chart

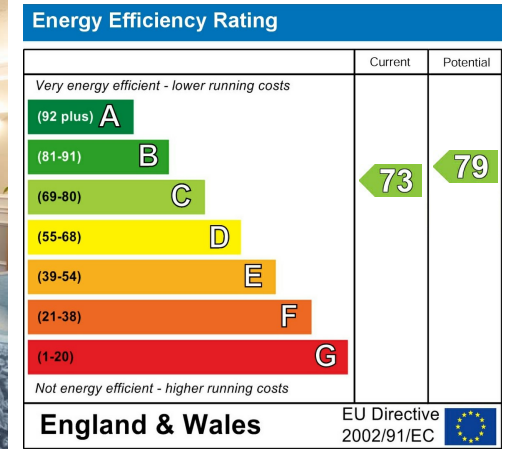

Tenure: **Leasehold** Council Tax Band: **B**

First Floor

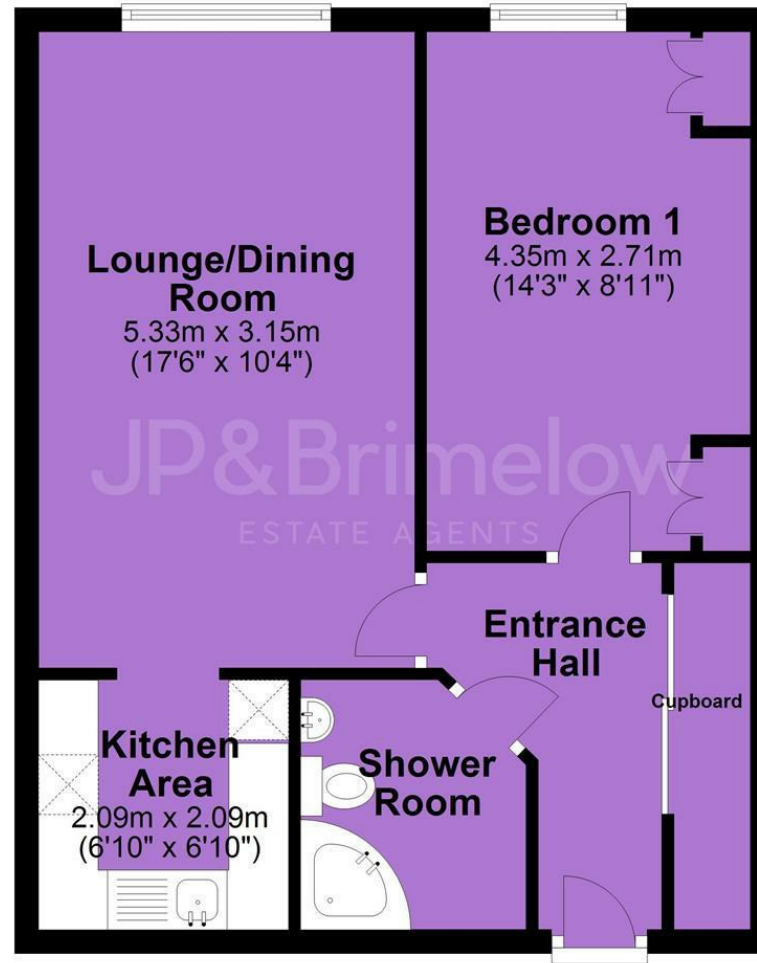

JP & Brimelow Estate Agents Ltd
430 Barlow Moor Road, Manchester, M21 8AD
Tel: 0161 8822233
E: sales@jpbrimelow.co.uk www.jpandbrimelow.co.uk



JP & Brimelow
ESTATE AGENTS

NOTICE: JP & Brimelow Estate Agents Ltd for themselves and for the vendors or lessors of this property whose agents they are give notice that:

- the particulars are set out as a general outline only for the guidance of intending purchasers or lessees, and do not constitute, nor constitute part of, an offer or contract;
- all descriptions, dimensions, references to the condition and necessary permissions for use and occupation, and other details are given in good faith and are believed to be correct but any intending purchasers or tenants should not rely on them as statements or representations of fact but must satisfy themselves by inspection or otherwise as to the correctness of each of them;
- no person in the employment of JP & Brimelow Estate Agents Ltd has any authority to make or give any representation or warranty whatever in relation to this property.

jpandbrimelowstateagents

@jpandbrimelow