

20 Swinfield Avenue, Chorlton Green, Manchester, M21 9FU



Offers In The Region Of £350,000

 2  1  1  D

VIDEO TOUR AVAILABLE A well-kept, TWO DOUBLE BEDROOM, period, mid terrace property situated on a quiet cul-de-sac location off Ivy Green Road in Chorlton Green. Within easy walking distance to the Meadows, backs onto allotments, Chorlton Nature Reserve, several fantastic primary schools and the highly popular Beech Road with all its independent shops, cafes, restaurants, bars and local amenities. The well-planned property boasts a lounge to the front aspect and a good-sized kitchen with views and access out into the rear enclosed garden. To the first floor there are two double bedrooms and a white three-piece bathroom suite. The property benefits from gas fired central heating, ceiling coving, and a rear enclosed garden.





EPC Chart

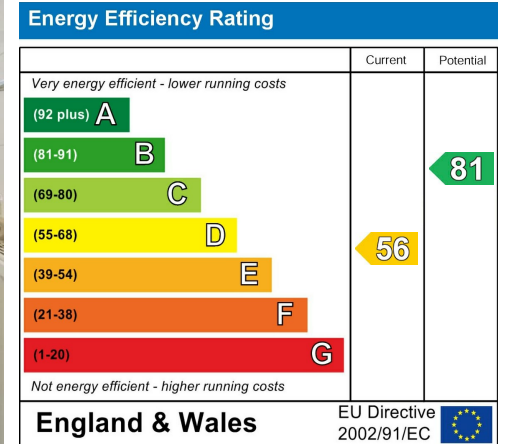

Tenure: **Freehold** Council Tax Band: **B**

Ground Floor



First Floor

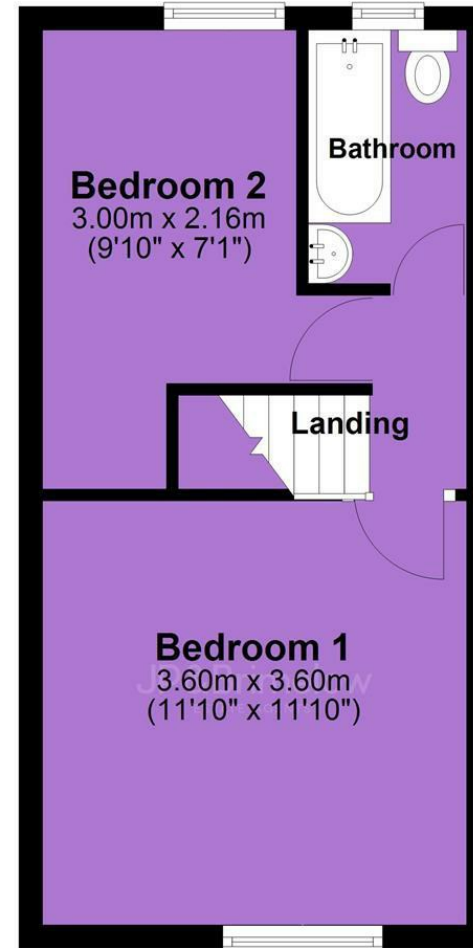

JP & Brimelow Estate Agents Ltd
 430 Barlow Moor Road, Manchester, M21 8AD
 Tel: 0161 8822233
 E: sales@jpbrimelow.co.uk www.jpandbrimelow.co.uk



JP & Brimelow
 ESTATE AGENTS

NOTICE: JP & Brimelow Estate Agents Ltd for themselves and for the vendors or lessors of this property whose agents they are give notice that:

- (i) the particulars are set out as a general outline only for the guidance of intending purchasers or lessees, and do not constitute, nor constitute part of, an offer or contract;
- (ii) all descriptions, dimensions, references to the condition and necessary permissions for use and occupation, and other details are given in good faith and are believed to be correct but any intending purchasers or tenants should not rely on them as statements or representations of fact but must satisfy themselves by inspection or otherwise as to the correctness of each of them;
- (iii) no person in the employment of JP & Brimelow Estate Agents Ltd has any authority to make or give any representation or warranty whatever in relation to this property.

jpandbrimelowestateagents

@jpandbrimelow