

Flat 5 Beech Mews, 123-125 Beech Road, Chorlton Green, Manchester, M21 9EQ



JP&Brimelow
ESTATE AGENTS

Offers In The Region Of £230,000



VIDEO TOUR AVAILABLE A beautifully presented and spacious ONE BEDROOM apartment, ideally located on the ever-popular Beech Road in the heart of Chorlton Green. This home is perfectly positioned, within walking distance of Beech Road's vibrant bars, restaurants, and boutique shops, as well as Chorlton Nature Reserve and the Meadows. Manchester City Centre, MediaCity, and the Metrolink are all easily accessible, making this an ideal location for both professionals and families. The accommodation is thoughtfully arranged and briefly comprises an entrance hallway with stairs to the first floor. A bright and spacious open lounge/fitted kitchen, a double bedroom with useful built in storage and a three-piece bathroom. The property benefits from off-road parking and a further features include gas-fired central heating and a well-maintained communal garden. Early viewing is highly recommended.





EPC Chart

Energy Efficiency Rating		
	Current	Potential
Very energy efficient - lower running costs		
(92 plus) A		
(81-91) B		
(69-80) C		
(55-68) D		
(39-54) E		
(21-38) F		
(1-20) G		
Not energy efficient - higher running costs		
England & Wales	EU Directive 2002/91/EC 	

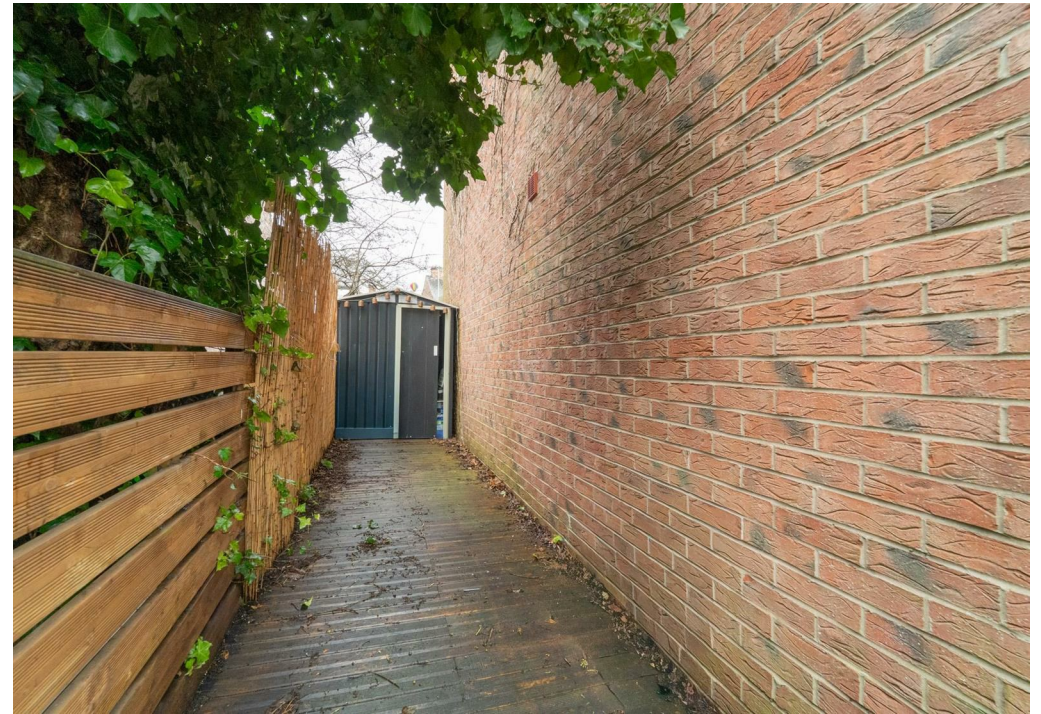

Tenure: **Leasehold** Council Tax Band: **A**

Ground Floor

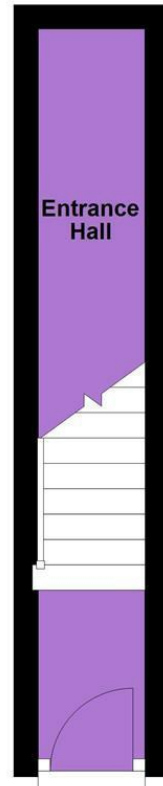

First Floor



JP & Brimelow Estate Agents Ltd
 430 Barlow Moor Road, Manchester, M21 8AD
 Tel: 0161 8822233
 E: sales@jpbrimelow.co.uk www.jpandbrimelow.co.uk



JP & Brimelow
 ESTATE AGENTS

NOTICE: JP & Brimelow Estate Agents Ltd for themselves and for the vendors or lessors of this property whose agents they are give notice that:

- (i) the particulars are set out as a general outline only for the guidance of intending purchasers or lessees, and do not constitute, nor constitute part of, an offer or contract;
- (ii) all descriptions, dimensions, references to the condition and necessary permissions for use and occupation, and other details are given in good faith and are believed to be correct but any intending purchasers or tenants should not rely on them as statements or representations of fact but must satisfy themselves by inspection or otherwise as to the correctness of each of them;
- (iii) no person in the employment of JP & Brimelow Estate Agents Ltd has any authority to make or give any representation or warranty whatever in relation to this property.

jpandbrimelowestateagents

@jpandbrimelow