

111, 1 Didsbury Gate Houseman Crescent, West Didsbury, Manchester, M20 2JP



JP&Brimelow
ESTATE AGENTS



3 2 1 C

VIDEO TOUR AVAILABLE We are delighted to present to the market this exceptional and distinctive THREE BEDROOM home, located within Didsbury Gate, one of the most desirable and prestigious developments in M20. This beautifully proportioned residence forms part of a Grade II listed conversion and is just a short walk from the lively Burton Road, renowned for its boutique shops, bars, and restaurants, as well as the Metrolink giving you access to city life.

Beautifully presented throughout this delightful property comprises an entrance porch leading into a welcoming hallway, a downstairs WC, a stylish kitchen/diner with impressive dual-aspect feature windows, and a spacious lounge with large windows overlooking the private front garden.

On the first floor, the landing opens into the master bedroom suite, which boasts dual-aspect windows with delightful garden views, a large three-piece en-suite shower room, practical storage space.

The second floor offers two further double bedrooms, one featuring fitted wardrobes and rooftop views. A spacious family bathroom completes this floor.

Positioned favourably within the secure manicured grounds this high spec home benefits from; plenty of storage space, two secure parking spaces, extensive well maintained, south facing gardens to the rear of the property and secure gated entry.

We highly recommend an internal inspection of this wonderful property to appreciate the standard of accommodation available.

Offered with no onward chain.

£525,000





EPC Chart

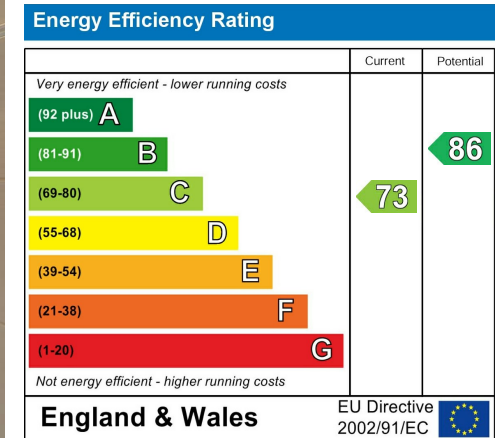

Tenure: Leasehold Council Tax Band: F

Ground Floor



First Floor



Second Floor

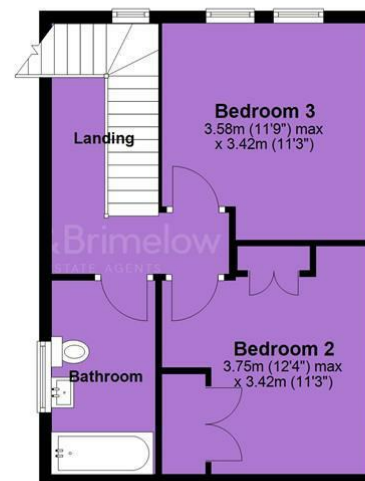

JP & Brimelow Estate Agents Ltd
430 Barlow Moor Road, Manchester, M21 8AD
Tel: 0161 8822233

E: sales@jpbrimelow.co.uk www.jpandbrimelow.co.uk



JP & Brimelow
ESTATE AGENTS

NOTICE: JP & Brimelow Estate Agents Ltd for themselves and for the vendors or lessors of this property whose agents they are give notice that:

- (i) the particulars are set out as a general outline only for the guidance of intending purchasers or lessees, and do not constitute, nor constitute part of, an offer or contract;
- (ii) all descriptions, dimensions, references to the condition and necessary permissions for use and occupation, and other details are given in good faith and are believed to be correct but any intending purchasers or tenants should not rely on them as statements or representations of fact but must satisfy themselves by inspection or otherwise as to the correctness of each of them;
- (iii) no person in the employment of JP & Brimelow Estate Agents Ltd has any authority to make or give any representation or warranty whatever in relation to this property.

jpandbrimelowestateagents

@jpandbrimelow

