

14 Cottonfield Road, Withington, Manchester, M20 4QW



JP&Brimelow
ESTATE AGENTS

Offers In The Region Of £400,000

 3  1  2  D

VIDEO TOUR AVAILABLE A delightful and immaculately presented, THREE BEDROOM, traditional, semi-detached property. Located off Heyscroft Road in Withington. The property is conveniently located near to Ladybarn Park and Mauldeth Road train station and within a short walk from The Christie, Fog Lane Park and Didsbury village, with its array of shops and amenities. In brief, the well-planned accommodation consists of; An entrance hall with useful storage cupboard, a dining area to the front aspect leading through to a lounge area which has views and access out into the rear enclosed garden. An extended and fitted kitchen with access out into the rear garden completes this floor. To the first floor the landing reveals three well-proportioned bedrooms, two of which benefit from built in wardrobes. A white three-piece shower room completes this lovely home. The property benefits from gas fired central heating, high ceilings throughout, a driveway providing off road parking and a rear enclosed garden. OFFERED WITH NO VENDOR CHAIN.





EPC Chart

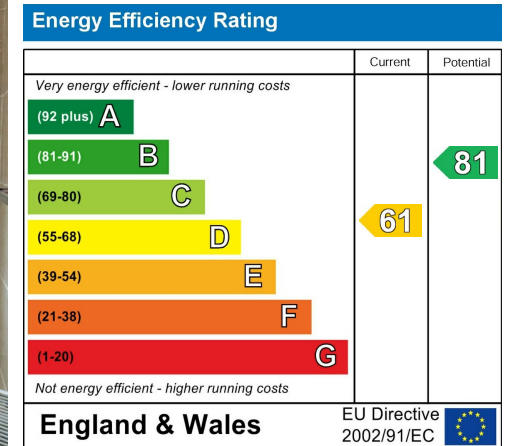

Tenure: **Freehold** Council Tax Band: **C**

Ground Floor

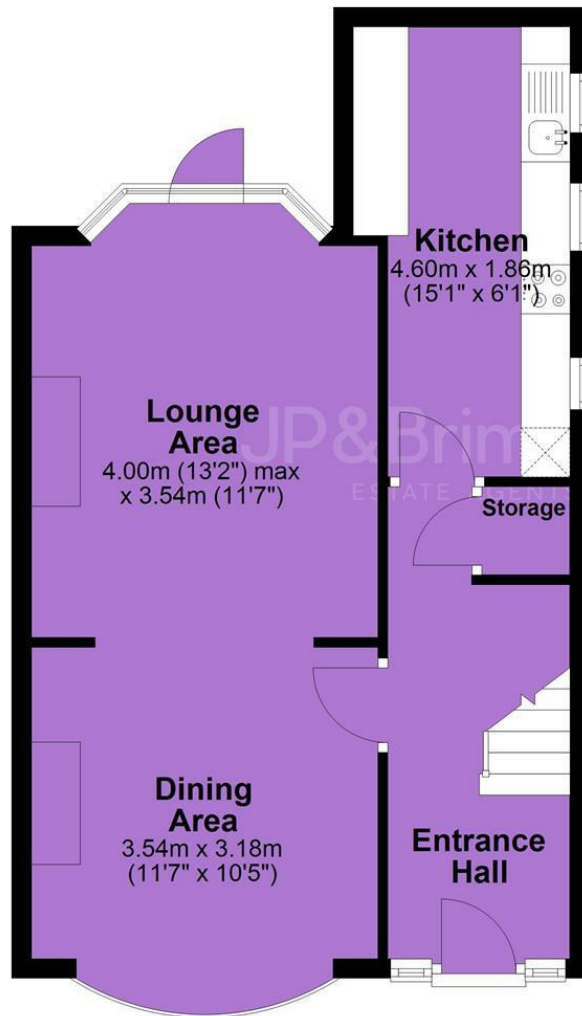

First Floor

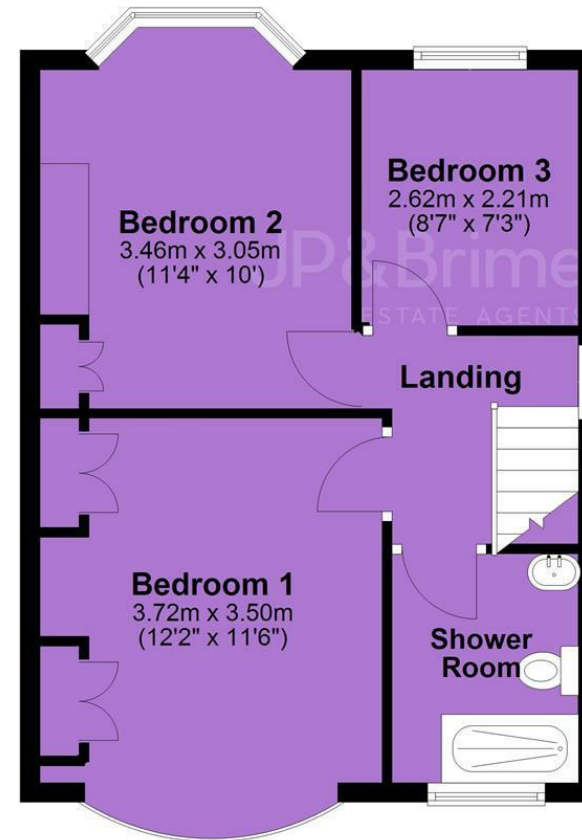

JP & Brimelow Estate Agents Ltd
430 Barlow Moor Road, Manchester, M21 8AD
Tel: 0161 8822233

E: sales@jpbrimelow.co.uk www.jpandbrimelow.co.uk



JP & Brimelow
ESTATE AGENTS

NOTICE: JP & Brimelow Estate Agents Ltd for themselves and for the vendors or lessors of this property whose agents they are give notice that:

- (i) the particulars are set out as a general outline only for the guidance of intending purchasers or lessees, and do not constitute, nor constitute part of, an offer or contract;
- (ii) all descriptions, dimensions, references to the condition and necessary permissions for use and occupation, and other details are given in good faith and are believed to be correct but any intending purchasers or tenants should not rely on them as statements or representations of fact but must satisfy themselves by inspection or otherwise as to the correctness of each of them;
- (iii) no person in the employment of JP & Brimelow Estate Agents Ltd has any authority to make or give any representation or warranty whatever in relation to this property.

jpandbrimelowestateagents

@jpandbrimelow