

115 Old Hall Lane, Fallowfield, Manchester, M14 6HL



JP&Brimelow
ESTATE AGENTS



3 1 3

VIDEO TOUR AVAILABLE An attractive and imposing THREE BEDROOM bay fronted semi-detached property positioned off Wilmslow Road overlooking Manchester Grammar School playfields. IN NEED OF COSMETIC UPDATING THROUGHOUT.

Located near Platt Fields Park, close to fantastic transport links, creating easy access to Manchester city centre and Manchester airport. Nearby to both Rusholme and Longsight high streets with a selection of restaurants, café and grocery stores.

This well-planned accommodation comprises; porch, entrance hallway, lounge with a bay window to the front aspect, dining room with a access out into the rear garden, a breakfast room with a downstairs W.C and a fitted kitchen completes the ground floor.

To the first floor there is a landing leading to three bedrooms, a separate W.C and a two-piece bathroom.

The property benefits from being warmed by both gas central heating and electric heating, high ceilings with ceiling coving, featured glazed windows, a paved driveway with double gates leading to a further driveway with a brock build garage, a good sized enclosed lawned garden with timber panelled fencing with the neighbouring properties.

OFFERED WITH NO VENDOR CHAIN.

Early inspection is highly recommended due to the location and space available.

£450,000





EPC Chart

| Energy Efficiency Rating | | |
|---|--|-----------|
| | Current | Potential |
| Very energy efficient - lower running costs | | |
| (92 plus) A | | |
| (81-91) B | | |
| (69-80) C | | |
| (55-68) D | | |
| (39-54) E | | |
| (21-38) F | | |
| (1-20) G | | |
| Not energy efficient - higher running costs | | |
| England & Wales | EU Directive 2002/91/EC  | |



Tenure: Freehold Council Tax Band: D

Ground Floor

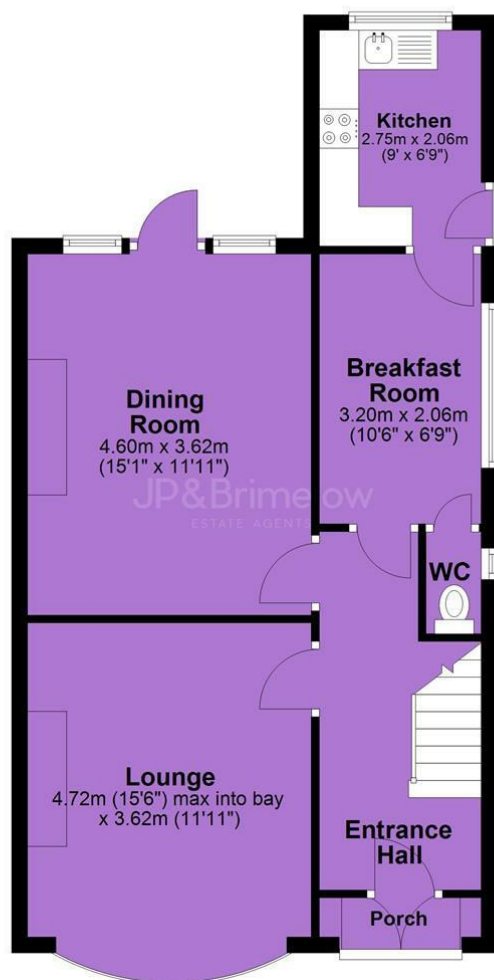

First Floor

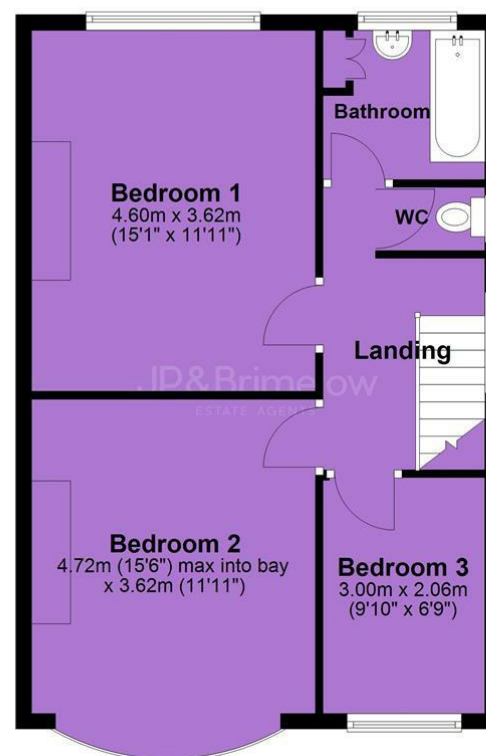

JP & Brimelow Estate Agents Ltd
430 Barlow Moor Road, Manchester, M21 8AD
Tel: 0161 8822233

E: sales@jpbrimelow.co.uk www.jpandbrimelow.co.uk



JP & Brimelow
ESTATE AGENTS

NOTICE: JP & Brimelow Estate Agents Ltd for themselves and for the vendors or lessors of this property whose agents they are give notice that:

- (i) the particulars are set out as a general outline only for the guidance of intending purchasers or lessees, and do not constitute, nor constitute part of, an offer or contract;
- (ii) all descriptions, dimensions, references to the condition and necessary permissions for use and occupation, and other details are given in good faith and are believed to be correct but any intending purchasers or tenants should not rely on them as statements or representations of fact but must satisfy themselves by inspection or otherwise as to the correctness of each of them;
- (iii) no person in the employment of JP & Brimelow Estate Agents Ltd has any authority to make or give any representation or warranty whatever in relation to this property.

jpandbrimelowestateagents

@jpandbrimelow

