

155 Ayres Road, Old Trafford, Trafford, M16 9NS



**JP&Brimelow**  
ESTATE AGENTS





4 1 2 D

\*\*\*VIDEO TOUR AVAILABLE\*\*\* A tastefully extended FOUR BEDROOM, traditional 1930's, bay fronted semi-detached property situated on a popular tree lined road off Seymour grove here in old Trafford.

Within strolling distance to the Trafford Bar Metrolink station, giving you direct access into the city centre, Media City and Manchester International Airport. Also close to the well-known Trafford centre.

A fifteen-minute walk to the popular bars, restaurants and cafés on Manchester Road in Chorlton. Just a short stroll to both Seymour Park and Hullard Park, with Seymour community primary school nearby and access to the secondary schools in Trafford.

The accommodation consists of ; a porch, an entrance hall with built in storage cupboard, a through lounge/dining room with a bay window to the front aspect, an extended fitted kitchen/breakfast/dining area with access into the rear paved garden.

Whilst to the first floor, a landing reveals four bedrooms, a two-piece bathroom and a separate W.C.

The property benefits from high ceilings, picture railings, is warmed by gas fired central heating, has a driveway providing off-road parking and a garage/utility room with power/lightning and access into the kitchen area. OFFERED WITH NO VENDOR CHAIN.

£450,000









## EPC Chart

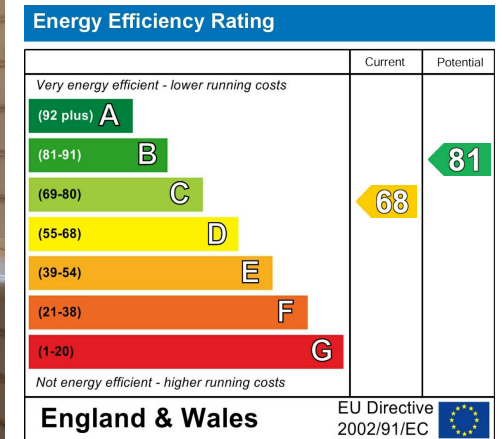

Tenure: Leasehold Council Tax Band: D

## Ground Floor

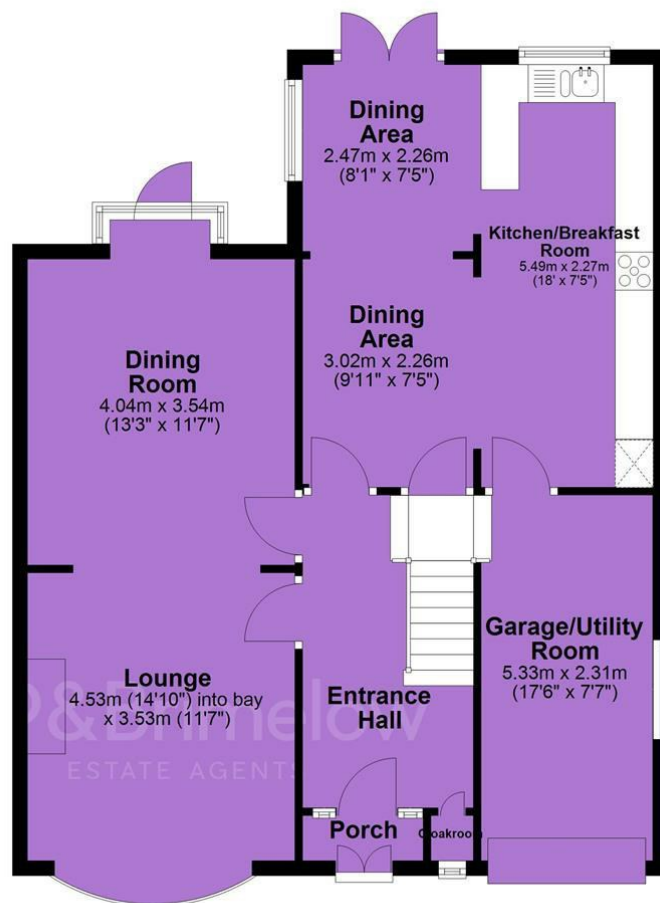

## First Floor



JP & Brimelow Estate Agents Ltd  
430 Barlow Moor Road, Manchester, M21 8AD  
Tel: 0161 8822233  
E: sales@jpbrimelow.co.uk www.jpandbrimelow.co.uk



**JP & Brimelow**  
ESTATE AGENTS

NOTICE: JP & Brimelow Estate Agents Ltd for themselves and for the vendors or lessors of this property whose agents they are give notice that:

- (i) the particulars are set out as a general outline only for the guidance of intending purchasers or lessees, and do not constitute, nor constitute part of, an offer or contract;
- (ii) all descriptions, dimensions, references to the condition and necessary permissions for use and occupation, and other details are given in good faith and are believed to be correct but any intending purchasers or tenants should not rely on them as statements or representations of fact but must satisfy themselves by inspection or otherwise as to the correctness of each of them;
- (iii) no person in the employment of JP & Brimelow Estate Agents Ltd has any authority to make or give any representation or warranty whatever in relation to this property.

jpandbrimelowestateagents

@jpandbrimelow



