

8 Shuttleworth Close, Whalley Range, Manchester, M16 8NN



JP&Brimelow
ESTATE AGENTS

Offers In The Region Of £280,000

2 1 1 c

VIDEO TOUR AVAILABLE A well-presented, TWO DOUBLE BEDROOM, mid terrace, property. Nicely tucked away just off Nettleford Road, on the borders of Whalley Range and Chorlton. Within a fifteen minute walk of the Metrolink Station on St Werburghs Road which gives you direct access into the City Centre/Media City, secondary schools on your doorstep, Whalley Range cricket and tennis club are located at the top of the road, close to universities, hospitals, and Manchester International Airport. In brief the property consists of; An entrance hall, a good sized lounge to the front aspect with a useful storage cupboard, double doors lead through to a modern fitted kitchen, which has views and access out into the delightful garden. Whilst to the first floor this property boasts two double bedrooms, one benefiting from built in wardrobes. A white three-piece bathroom suite completes this fabulous home. The property benefits from gas fired central heating, a rear enclosed garden and a driveway providing off road parking.





EPC Chart

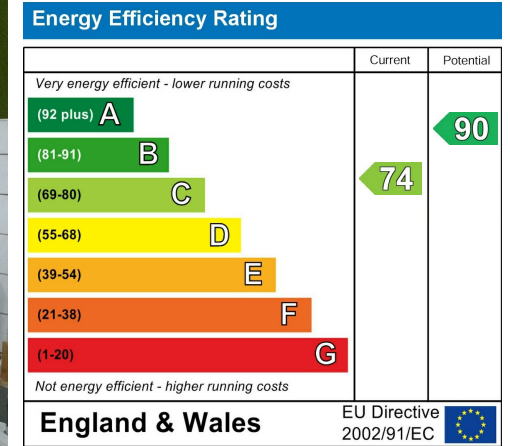

Tenure: **Freehold** Council Tax Band: **B**

Ground Floor

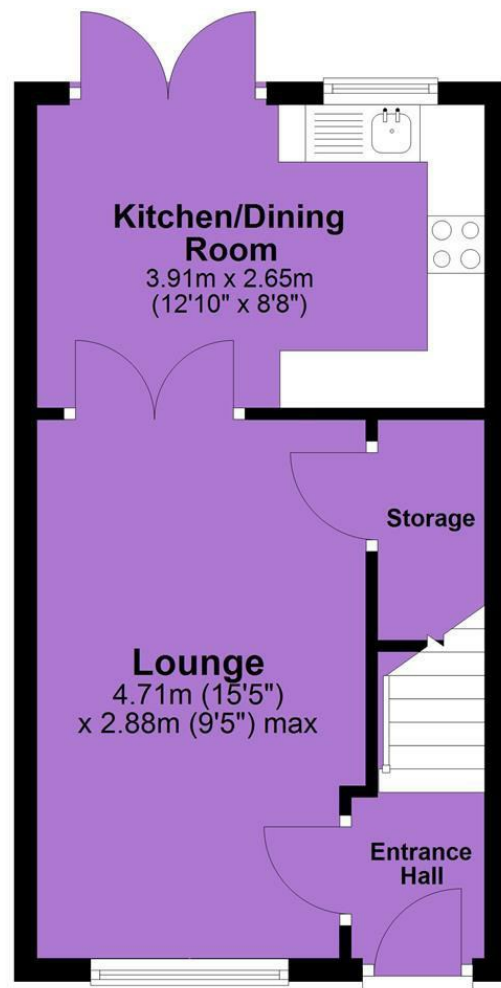

First Floor

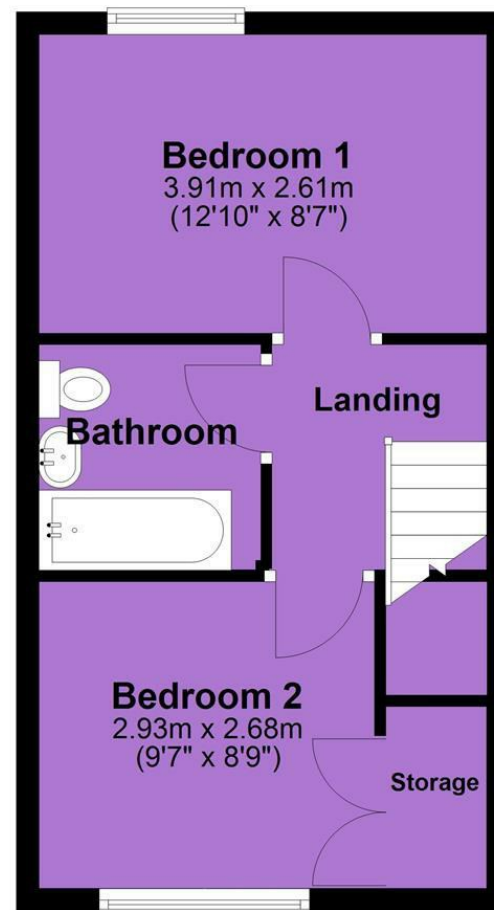

JP & Brimelow Estate Agents Ltd
430 Barlow Moor Road, Manchester, M21 8AD
Tel: 0161 8822233
E: sales@jpbrimelow.co.uk www.jpandbrimelow.co.uk



JP & Brimelow
ESTATE AGENTS

NOTICE: JP & Brimelow Estate Agents Ltd for themselves and for the vendors or lessors of this property whose agents they are give notice that:

- (i) the particulars are set out as a general outline only for the guidance of intending purchasers or lessees, and do not constitute, nor constitute part of, an offer or contract;
- (ii) all descriptions, dimensions, references to the condition and necessary permissions for use and occupation, and other details are given in good faith and are believed to be correct but any intending purchasers or tenants should not rely on them as statements or representations of fact but must satisfy themselves by inspection or otherwise as to the correctness of each of them;
- (iii) no person in the employment of JP & Brimelow Estate Agents Ltd has any authority to make or give any representation or warranty whatever in relation to this property.

jpandbrimelowestateagents

@jpandbrimelow