

7 Grange Road, Chorlton, Manchester, M21 9NZ





4 2 2 D

VIDEO TOUR AVAILABLE An immaculately presented and spacious FOUR DOUBLE BEDROOM mid terrace home. The property has been stylishly decorated by the current owners to offer modern living in a charming setting. Situated in a leafy location off Kensington Road in Chorlton, this property boasts impressive accommodations across three floors.

Just a short walk from Chorlton Village, offering a variety of local amenities such as restaurants, delis, shops and bars on Manchester Road. Conveniently close to the Metrolink stations on Wilbraham Road and Rye Bank Road in Firwood, providing direct access to the city centre and Media City at Salford Quays.

A stones throw from the popular Barbakan Deli and Unicorn supermarket on Manchester Road, both beloved by many. Longford Park is right at your doorstep with a children's play area, and a coffee shop and good primary schools are located close by.

The well-planned property consists of an entrance vestibule, an entrance hallway, a lounge with a bay window to the front aspect, stripped and varnished floor boards and a log burner. A family room which has a log burner and opens to a modern and fully fitted kitchen area which has views and access out into the rear enclosed garden.

To the first floor the landing reveals three well-proportioned bedrooms, one benefitting from built in wardrobes and a feature fireplace. A three-piece bathroom suite completes this floor.

Whilst to the second floor there is a large storage room and the principal bedroom which benefits from an en-suite shower room complete with walk in shower.

The property offers a wealth of original features such as stripped and varnished floor boards, picture railings, ceiling coving, cast iron fireplaces and high ceilings. Warmed by gas central heating and has both front and rear enclosed gardens.

£540,000





EPC Chart

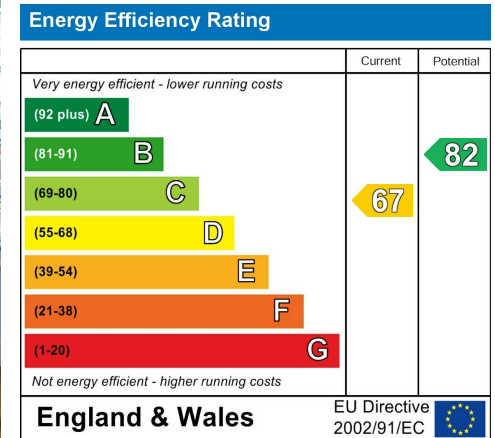

Tenure: Freehold Council Tax Band: B

Ground Floor

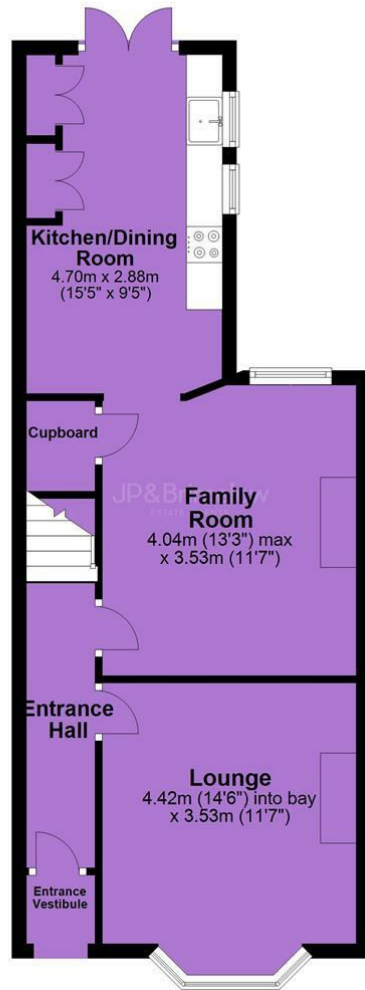

First Floor

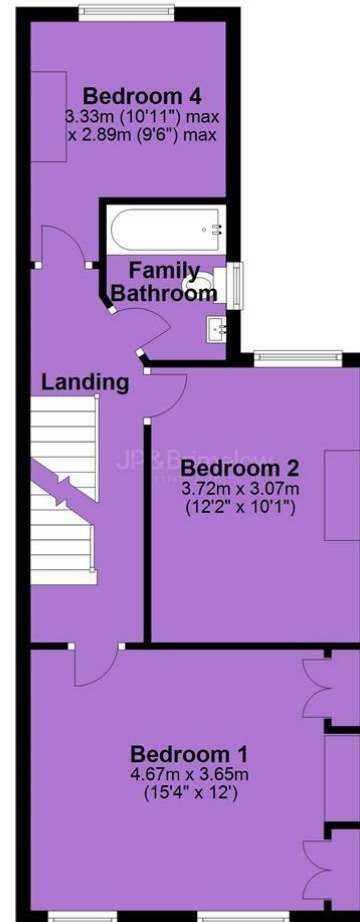

Second Floor

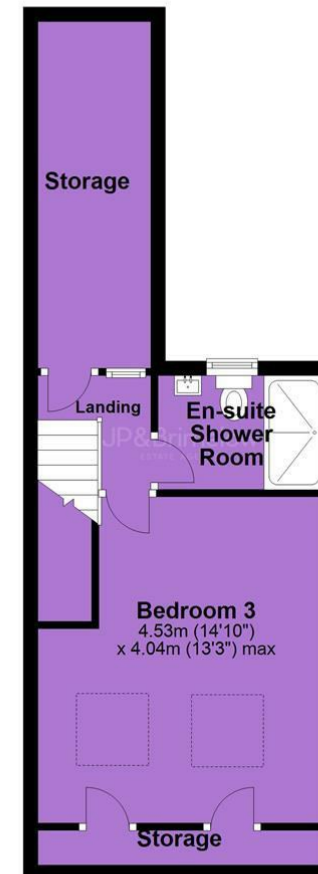

JP & Brimelow Estate Agents Ltd
430 Barlow Moor Road, Manchester, M21 8AD
Tel: 0161 8822233

E: sales@jpbrimelow.co.uk www.jpandbrimelow.co.uk



JP & Brimelow
ESTATE AGENTS

NOTICE: JP & Brimelow Estate Agents Ltd for themselves and for the vendors or lessors of this property whose agents they are give notice that:

- (i) the particulars are set out as a general outline only for the guidance of intending purchasers or lessees, and do not constitute, nor constitute part of, an offer or contract;
- (ii) all descriptions, dimensions, references to the condition and necessary permissions for use and occupation, and other details are given in good faith and are believed to be correct but any intending purchasers or tenants should not rely on them as statements or representations of fact but must satisfy themselves by inspection or otherwise as to the correctness of each of them;
- (iii) no person in the employment of JP & Brimelow Estate Agents Ltd has any authority to make or give any representation or warranty whatever in relation to this property.

jpandbrimelowestateagents

@jpandbrimelow

