

37 Emery Avenue, Chorlton, Manchester, M21 7LE



**JP&Brimelow**  
ESTATE AGENTS



# Offers In The Region Of £325,000

 3  1  1  D

\*\*\*VIDEO TOUR AVAILABLE\*\*\* A well-presented THREE BEDROOM, mid-terrace property positioned on a popular residential avenue, off Hardy Lane here in Chorlton. With Chorlton Water Park, Chorlton Park, and Chorlton Golf Club all on your doorstep. It is centrally located for transport links into the City Centre, Media City, and Manchester International Airport by both the Metrolink or bus route on Barlow Moor Road. The location is fantastic for both West Didsbury and Chorlton amenities and local primary schools, parks, and the motorway network. The well-planned accommodation consists of an entrance hall with stairs leading to the first floor, a spacious lounge area and fitted kitchen leading to the rear enclosed garden. A downstairs W.C completes this floor. To the first floor there is a landing leading to three good sized bedrooms and a three-piece bathroom. The property also benefits from off-road parking, gas fired central heating and both front and rear enclosed lawned gardens.







## EPC Chart

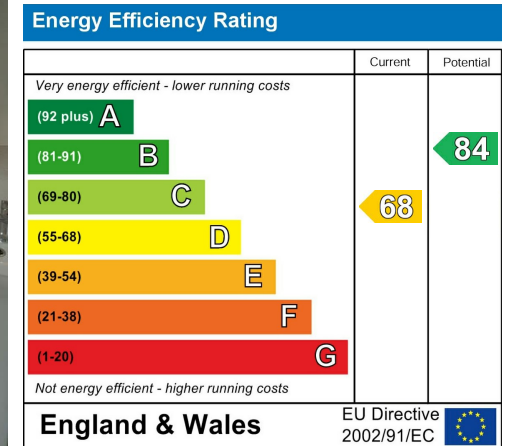

Tenure: **Freehold** Council Tax Band: **A**

## Ground Floor

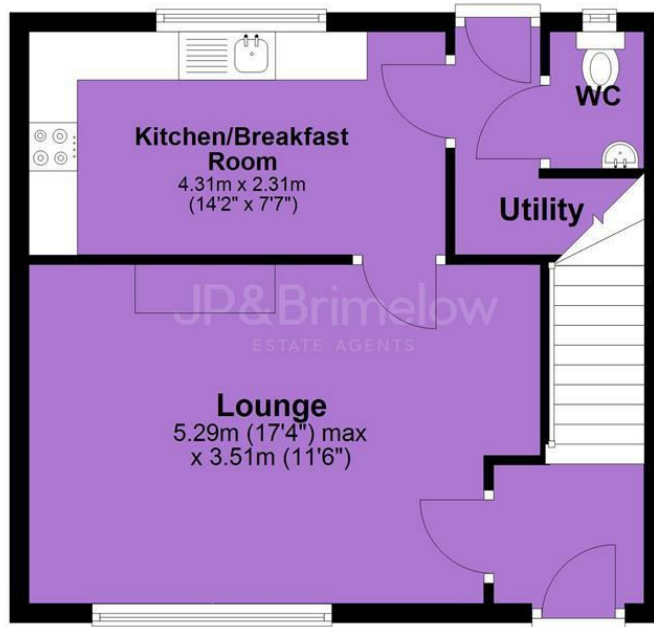

## First Floor

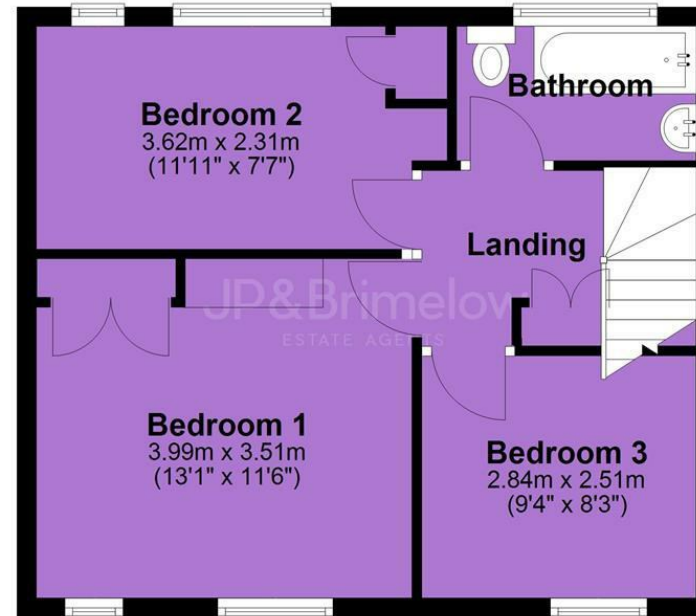

JP & Brimelow Estate Agents Ltd  
 430 Barlow Moor Road, Manchester, M21 8AD  
 Tel: 0161 8822233  
 E: sales@jpbrimelow.co.uk www.jpandbrimelow.co.uk



**JP & Brimelow**  
 ESTATE AGENTS

NOTICE: JP & Brimelow Estate Agents Ltd for themselves and for the vendors or lessors of this property whose agents they are give notice that:

- (i) the particulars are set out as a general outline only for the guidance of intending purchasers or lessees, and do not constitute, nor constitute part of, an offer or contract;
- (ii) all descriptions, dimensions, references to the condition and necessary permissions for use and occupation, and other details are given in good faith and are believed to be correct but any intending purchasers or tenants should not rely on them as statements or representations of fact but must satisfy themselves by inspection or otherwise as to the correctness of each of them;
- (iii) no person in the employment of JP & Brimelow Estate Agents Ltd has any authority to make or give any representation or warranty whatever in relation to this property.

jpandbrimelowestateagents

@jpandbrimelow