

Apt 11 Alnwick House 30 Dudley Road, Whalley Range, Manchester, M16 8DT



JP&Brimelow
ESTATE AGENTS

Offers In The Region Of £275,000

2 1 1 D

VIDEO TOUR AVAILABLE A light & well presented, TWO DOUBLE BEDROOMED, first floor apartment, with its own private roof terrace. This attractive, 18th century conversion of a cotton traders mansion is in the heart of Whalley Range off Wood Road. Walking distance to nearby independent bars and restaurants including 'The Hilary Step' bar and 'Jam Street Cafe' on Upper Chorlton Road, a Tesco Metro is a minute's walk away and fantastic transport links on Withington Road, giving you direct access into the City Centre. In brief the impressive accommodation comprises; large communal entrance hallway, private entrance hall, lounge/diner with an open plan fully fitted kitchen, two double bedrooms with patio doors leading out to roof terrace and a three piece family bathroom. The apartment benefits from an enclosed terrace with fantastic views available, double glazing, central heating, basement with a private secure storage room, gated allocated parking and lawned communal gardens. Will suit a professional or a couple and early viewing is highly recommended.





EPC Chart

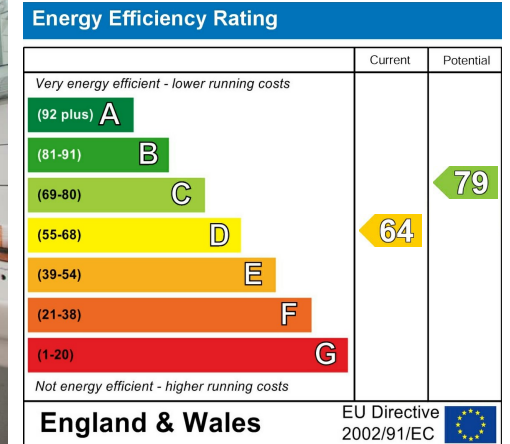

Tenure: **Leasehold** Council Tax Band: **B**

First Floor

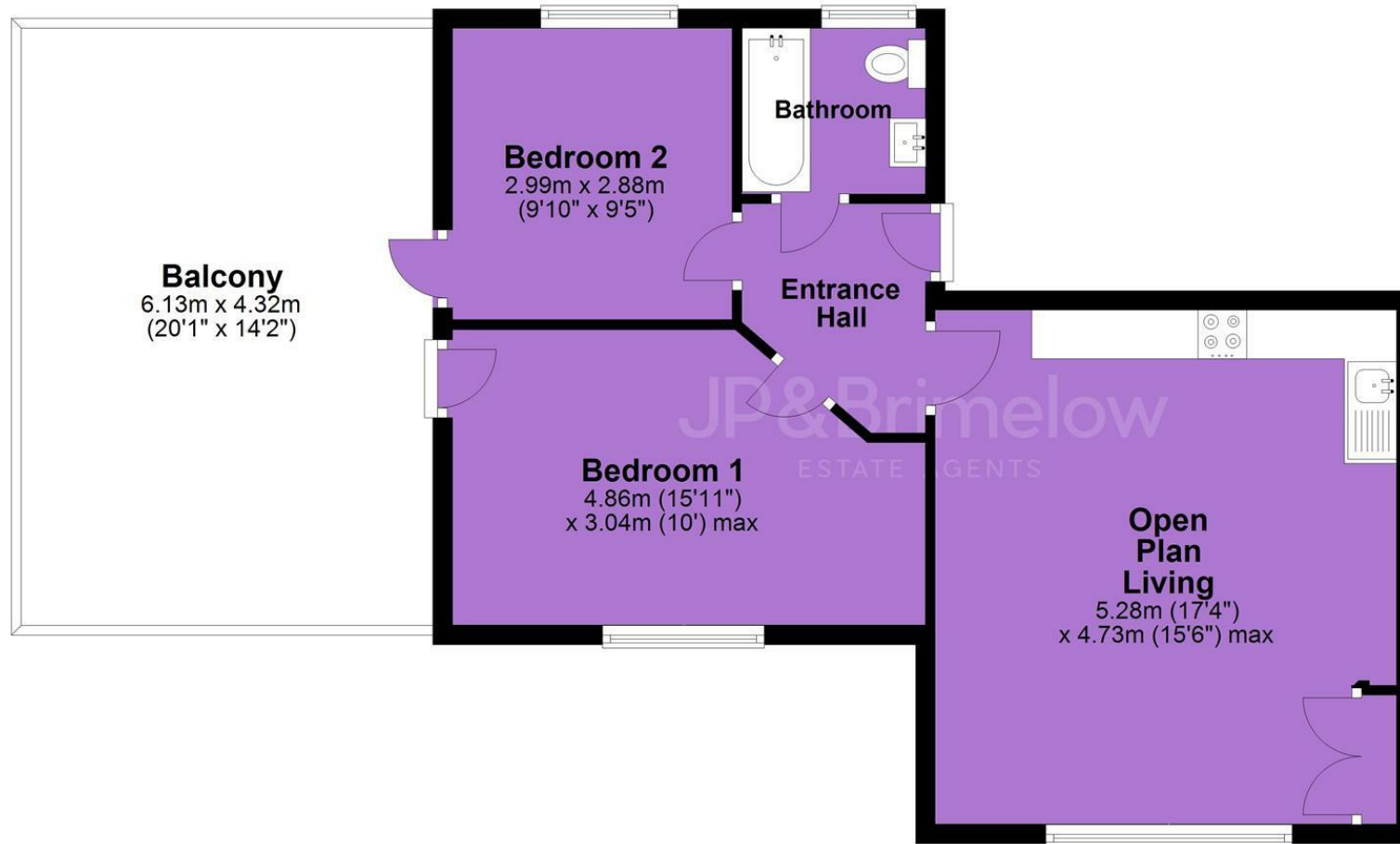

JP & Brimelow Estate Agents Ltd
 430 Barlow Moor Road, Manchester, M21 8AD
 Tel: 0161 8822233
 E: sales@jpbrimelow.co.uk www.jpandbrimelow.co.uk



JP & Brimelow
 ESTATE AGENTS

NOTICE: JP & Brimelow Estate Agents Ltd for themselves and for the vendors or lessors of this property whose agents they are give notice that:

- (i) the particulars are set out as a general outline only for the guidance of intending purchasers or lessees, and do not constitute, nor constitute part of, an offer or contract;
- (ii) all descriptions, dimensions, references to the condition and necessary permissions for use and occupation, and other details are given in good faith and are believed to be correct but any intending purchasers or tenants should not rely on them as statements or representations of fact but must satisfy themselves by inspection or otherwise as to the correctness of each of them;
- (iii) no person in the employment of JP & Brimelow Estate Agents Ltd has any authority to make or give any representation or warranty whatever in relation to this property.

jpandbrimelowestateagents

@jpandbrimelow