

48b Hall Street, Offerton, Stockport, SK1 4DA



Offers In The Region Of £150,000

 3  1  1  D

****VIDEO TOUR AVAILABLE**** A bright and spacious THREE DOUBLE BEDROOM, duplex apartment over the first and second floor with a private entrance to the rear of this converted semi-detached property on Hall Street. Situated in a highly popular residential area of Offerton, within a 10-minute walk of St Thomas Recreation Park on Webb Lane. A 5-minute drive from the bustling centre of Stockport where you can enjoy the bars, restaurants and the selection of shops. Stockport train and bus stations are a further 10-minute's drive and a bus stop situated outside the property connects you to the centre of Stockport. This well-planned accommodation consists of access to the rear via a flight of stairs to a private entrance hallway to the rear, an open plan lounge/dining room/modern fitted kitchen, a third bedroom/office, a modern fitted three-piece white bathroom with a cupboard. Stairs lead to the second floor, where you will find a landing leading to two double bedrooms. Close to the M60 motorway connecting you to the M62/M56 and easy access to Manchester International Airport. The property is warmed by electric central heating, has resident parking to the rear aspect and communal recycling bin storage. OFFERED WITH NO VENDOR CHAIN.





EPC Chart

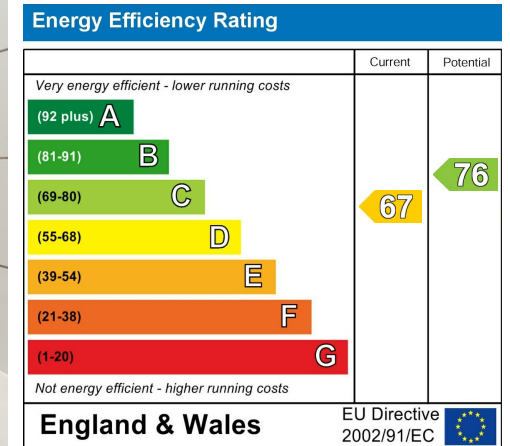

Tenure: **Leasehold** Council Tax Band: **A**

First Floor



Second Floor

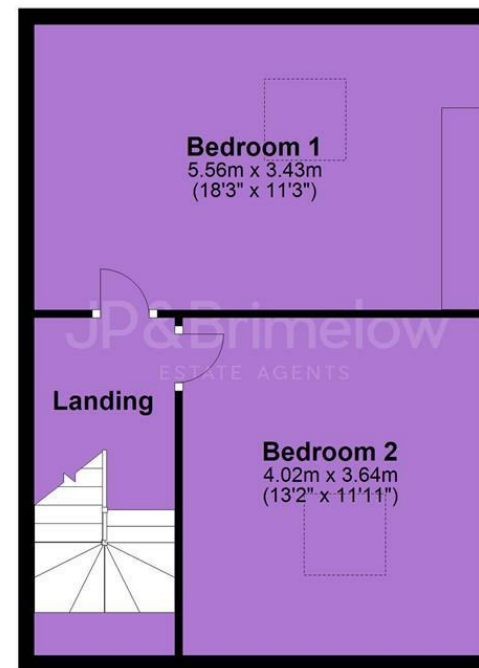

JP & Brimelow Estate Agents Ltd
430 Barlow Moor Road, Manchester, M21 8AD
Tel: 0161 8822233

E: sales@jpbrimelow.co.uk www.jpandbrimelow.co.uk



JP & Brimelow
ESTATE AGENTS

NOTICE: JP & Brimelow Estate Agents Ltd for themselves and for the vendors or lessors of this property whose agents they are give notice that:

- (i) the particulars are set out as a general outline only for the guidance of intending purchasers or lessees, and do not constitute, nor constitute part of, an offer or contract;
- (ii) all descriptions, dimensions, references to the condition and necessary permissions for use and occupation, and other details are given in good faith and are believed to be correct but any intending purchasers or tenants should not rely on them as statements or representations of fact but must satisfy themselves by inspection or otherwise as to the correctness of each of them;
- (iii) no person in the employment of JP & Brimelow Estate Agents Ltd has any authority to make or give any representation or warranty whatever in relation to this property.

jpandbrimelowestateagents

@jpandbrimelow