

28a Edge Lane, Chorlton, Manchester, M21 9JY



JP&Brimelow
ESTATE AGENTS

Offers In The Region Of £325,000

2 1 1 D

VIDEO TOUR AVAILABLE A cozy and inviting, TWO DOUBLE BEDROOM end-terrace property, situated on Edge Lane on the borders of Chorlton and Stretford and within walking distance to all local amenities, Metrolink stations, Longford Park, Chorlton nature reserve and good local primary and secondary schools nearby. The well-planned property consists of an entrance hallway, a lounge with a bay window to the front aspect, a fully fitted kitchen/dining room to the rear with access into the private enclosed rear garden. Whilst to the first floor there is a landing leading to two double bedrooms and a three-piece shower room. The property also benefits from both front and rear enclosed gardens, as well as a rear driveway, providing off-road parking and is warmed by gas fired central heating.





EPC Chart

Energy Efficiency Rating		Current	Potential
Very energy efficient - lower running costs			
(92 plus)	A		85
(81-91)	B		
(69-80)	C	68	
(55-68)	D		
(39-54)	E		
(21-38)	F		
(1-20)	G		
Not energy efficient - higher running costs			
England & Wales		EU Directive 2002/91/EC	



Tenure: **Leasehold** Council Tax Band: **B**

Ground Floor

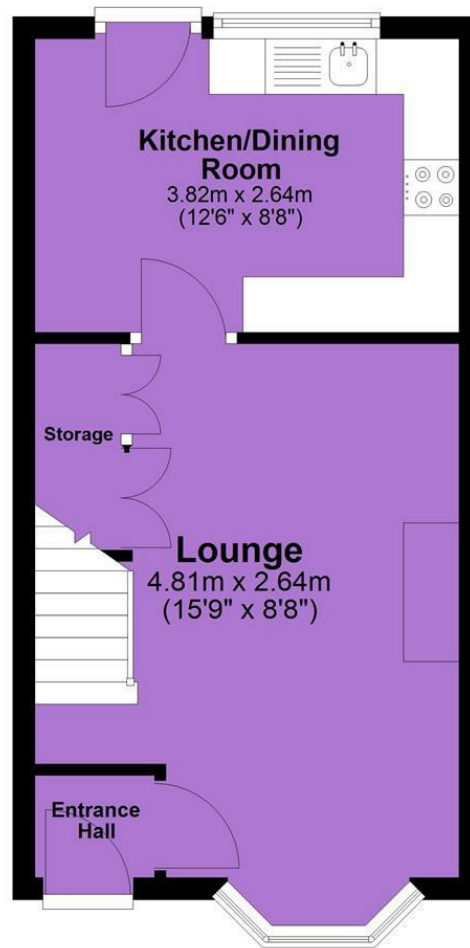

First Floor



JP & Brimelow Estate Agents Ltd
430 Barlow Moor Road, Manchester, M21 8AD
Tel: 0161 8822233
E: sales@jpbrimelow.co.uk www.jpandbrimelow.co.uk



JP & Brimelow
ESTATE AGENTS

NOTICE: JP & Brimelow Estate Agents Ltd for themselves and for the vendors or lessors of this property whose agents they are give notice that:

- (i) the particulars are set out as a general outline only for the guidance of intending purchasers or lessees, and do not constitute, nor constitute part of, an offer or contract;
- (ii) all descriptions, dimensions, references to the condition and necessary permissions for use and occupation, and other details are given in good faith and are believed to be correct but any intending purchasers or tenants should not rely on them as statements or representations of fact but must satisfy themselves by inspection or otherwise as to the correctness of each of them;
- (iii) no person in the employment of JP & Brimelow Estate Agents Ltd has any authority to make or give any representation or warranty whatever in relation to this property.

jpandbrimelowestateagents

@jpandbrimelow