

9 Redwing Avenue, Chorlton, Manchester, M21 7JS



**JP&Brimelow**  
ESTATE AGENTS



# Offers In The Region Of £395,000

 3  2  1  B

\*\*\*VIDEO TOUR AVAILABLE\*\*\* An immaculately presented & spacious, THREE BEDROOM, modern, semi-detached property positioned on this popular residential development off Darley Avenue. Chorlton Water Park and the Chorlton-Cum-Hardy Golf Club are on your doorstep, centrally located for transport links into the City Centre or Manchester Airport by the Metrolink station on Barlow Moor Road. The location is fantastic for both West Didsbury & Chorlton amenities and local primary schools, parks and the motorway network. In brief the well-planned accommodation comprises of; an entrance hallway, a downstairs W.C, a stunning fully fitted kitchen and a lounge/dining room with access out into the rear lawned garden. To the first floor there are three well-proportioned bedrooms, the master bedroom benefits from a three-piece en-suite shower room and a modern white three-piece family bathroom. The property benefits from enclosed lawned gardens with a paved patio area, a spacious driveway providing off-road parking, warmed by gas fired central heating and has solar panels providing efficient green energy. Would suit a professional couple or first-time buyer due to the location.







## EPC Chart

Energy Efficiency Rating		Current	Potential
Very energy efficient - lower running costs			
(92 plus) <b>A</b>		<b>88</b>	<b>90</b>
(81-91) <b>B</b>			
(69-80) <b>C</b>			
(55-68) <b>D</b>			
(39-54) <b>E</b>			
(21-38) <b>F</b>			
(1-20) <b>G</b>			
Not energy efficient - higher running costs			
England & Wales		EU Directive 2002/91/EC	



Tenure: **Leasehold** Council Tax Band: **C**

## Ground Floor



## First Floor

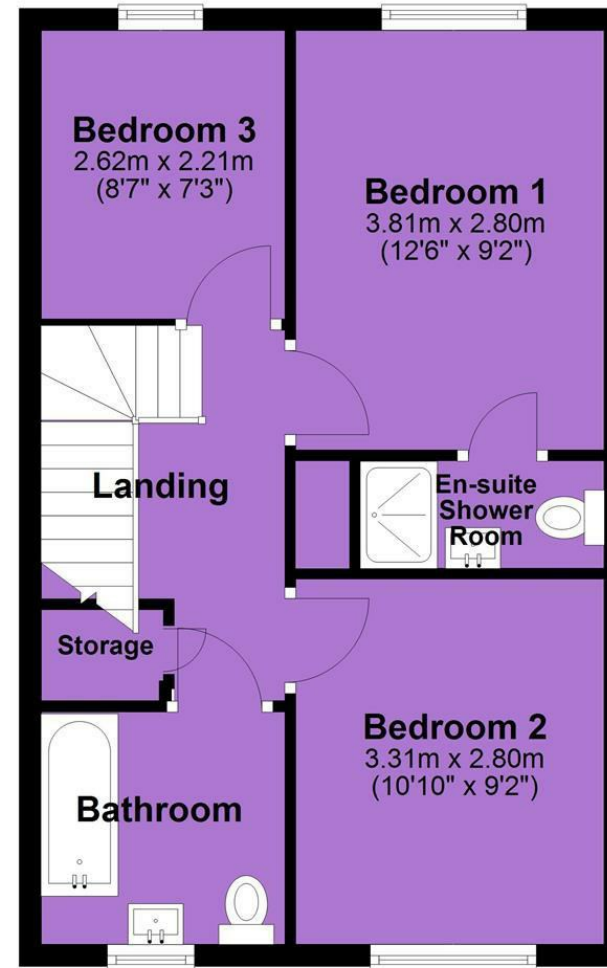

JP & Brimelow Estate Agents Ltd  
430 Barlow Moor Road, Manchester, M21 8AD  
Tel: 0161 8822233  
E: sales@jpbrimelow.co.uk www.jpandbrimelow.co.uk



**JP & Brimelow**  
ESTATE AGENTS

NOTICE: JP & Brimelow Estate Agents Ltd for themselves and for the vendors or lessors of this property whose agents they are give notice that:

- (i) the particulars are set out as a general outline only for the guidance of intending purchasers or lessees, and do not constitute, nor constitute part of, an offer or contract;
- (ii) all descriptions, dimensions, references to the condition and necessary permissions for use and occupation, and other details are given in good faith and are believed to be correct but any intending purchasers or tenants should not rely on them as statements or representations of fact but must satisfy themselves by inspection or otherwise as to the correctness of each of them;
- (iii) no person in the employment of JP & Brimelow Estate Agents Ltd has any authority to make or give any representation or warranty whatever in relation to this property.

jpandbrimelowestateagents

@jpandbrimelow