

158 Horton Road, Fallowfield, Manchester, M14 7QF



**JP&Brimelow**  
ESTATE AGENTS



# Offers In The Region Of £220,000

🛏 2 🚿 1 🛏 2 ☰ C

\*\*\*VIDEO TOUR AVAILABLE\*\*\* A well-presented & spacious TWO DOUBLE BEDROOM, period mid terraced property situated off Lloyd Street South in Fallowfield. Situated a short drive from Manchester city centre, with good transport links via bus routes, close to Platt Lane Park with a selection of sports activities. Positioned nearby to Fallowfield triangle offering café, shops and convenient stores and Claremont Primary School nearby. This well-planned accommodation consists; an entrance hallway, a family room to the front aspect with bespoke fitted furniture, a lounge/dining room opening to an extended fitted kitchen with solid oak wooden worktops to the ground floor. Whilst to the first floor there is a landing leading to two double bedrooms and a white three-piece shower room. The property benefits from a security alarm, warmed by combi boiler providing gas fired central heating and rear enclosed courtyard style garden with an outhouse.







## EPC Chart

Energy Efficiency Rating		
	Current	Potential
<i>Very energy efficient - lower running costs</i>		
(92 plus) <b>A</b>		
(81-91) <b>B</b>		<b>88</b>
(69-80) <b>C</b>	<b>72</b>	
(55-68) <b>D</b>		
(39-54) <b>E</b>		
(21-38) <b>F</b>		
(1-20) <b>G</b>		
<i>Not energy efficient - higher running costs</i>		
England & Wales		EU Directive 2002/91/EC



Tenure: **Freehold** Council Tax Band: **A**

## Ground Floor



## First Floor

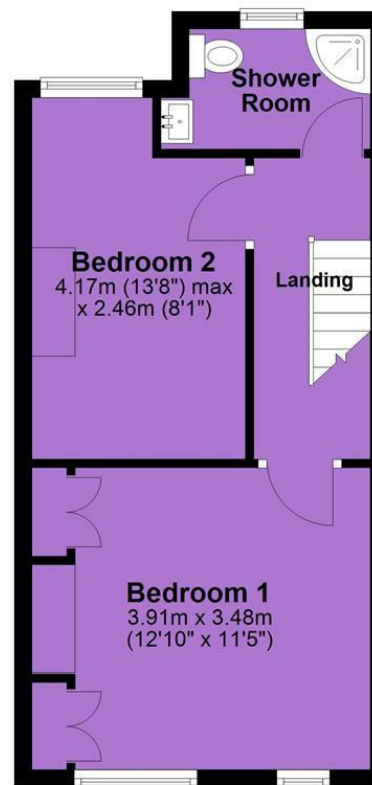

JP & Brimelow Estate Agents Ltd  
430 Barlow Moor Road, Manchester, M21 8AD  
Tel: 0161 8822233  
E: sales@jpbrimelow.co.uk www.jpandbrimelow.co.uk



**JP & Brimelow**  
ESTATE AGENTS

NOTICE: JP & Brimelow Estate Agents Ltd for themselves and for the vendors or lessors of this property whose agents they are give notice that:

- (i) the particulars are set out as a general outline only for the guidance of intending purchasers or lessees, and do not constitute, nor constitute part of, an offer or contract;
- (ii) all descriptions, dimensions, references to the condition and necessary permissions for use and occupation, and other details are given in good faith and are believed to be correct but any intending purchasers or tenants should not rely on them as statements or representations of fact but must satisfy themselves by inspection or otherwise as to the correctness of each of them;
- (iii) no person in the employment of JP & Brimelow Estate Agents Ltd has any authority to make or give any representation or warranty whatever in relation to this property.

jpandbrimelowestateagents

@jpandbrimelow