

197 Thornton Road, Fallowfield, Manchester, M14 7NS



JP&Brimelow
ESTATE AGENTS

Offers In The Region Of £210,000

2 1 2 D

VIDEO TOUR AVAILABLE A well-kept TWO DOUBLE BEDROOM, period mid terraced property. Situated off Lloyd Street South in Fallowfield. Located nearby to Fallowfield triangle offering café's, shops, a library and convenience stores. Just a short drive from Manchester city centre, with good transport links via bus routes. Close to Platt Lane Park, Hough End leisure centre in the direction of West Didsbury and Wilbraham Road Primary School nearby. This well-planned accommodation consists of; a porch, an entrance hall, a through lounge/dining room with useful storage cupboards and a tastefully extended fitted kitchen/breakfast with access out into the rear enclosed courtyard completes the ground floor. Whilst to the first floor there is a landing leading to two double bedrooms and a white three-piece family bathroom. The property benefits from a boarded loft space, warmed by gas fired central heating and a front and rear enclosed courtyard style garden with a paved patio. OFFERED WITH NO VENDOR CHAIN. Early viewing highly recommended due to the location on the road.





EPC Chart

Energy Efficiency Rating		Current	Potential
Very energy efficient - lower running costs			
(92 plus) A			88
(81-91) B			
(69-80) C			
(55-68) D			
(39-54) E			
(21-38) F			
(1-20) G			
Not energy efficient - higher running costs			
England & Wales		EU Directive 2002/91/EC 	



Tenure: **Freehold** Council Tax Band: **A**

Ground Floor



First Floor

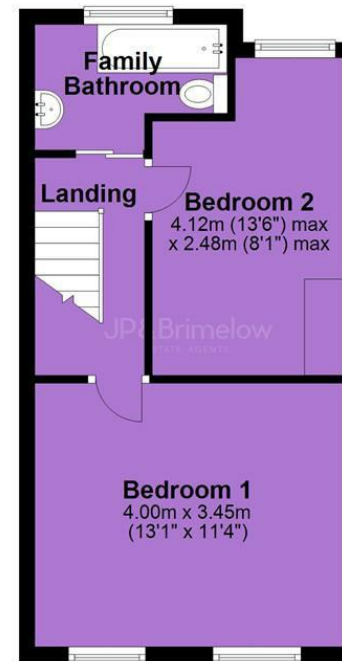

JP & Brimelow Estate Agents Ltd
430 Barlow Moor Road, Manchester, M21 8AD
Tel: 0161 8822233
E: sales@jpbrimelow.co.uk www.jpandbrimelow.co.uk



JP & Brimelow
ESTATE AGENTS

NOTICE: JP & Brimelow Estate Agents Ltd for themselves and for the vendors or lessors of this property whose agents they are give notice that:

- (i) the particulars are set out as a general outline only for the guidance of intending purchasers or lessees, and do not constitute, nor constitute part of, an offer or contract;
- (ii) all descriptions, dimensions, references to the condition and necessary permissions for use and occupation, and other details are given in good faith and are believed to be correct but any intending purchasers or tenants should not rely on them as statements or representations of fact but must satisfy themselves by inspection or otherwise as to the correctness of each of them;
- (iii) no person in the employment of JP & Brimelow Estate Agents Ltd has any authority to make or give any representation or warranty whatever in relation to this property.

jpandbrimelowestateagents

@jpandbrimelow