

60 Talbot Road, Ladybarn, Manchester, M14 6TB



**JP&Brimelow**  
ESTATE AGENTS



# Offers In The Region Of £275,000

 3  1  2  E

\*\*\*VIDEO TOUR AVAILABLE\*\*\* A well proportioned, THREE BEDROOM, semi detached property. Situated on a desirable residential road in Ladybarn. Close by to amenities, fantastic transport links on Kingsway and with Mauldeth Road train station a short walk away giving you direct access to the city centre and Manchester airport and Liverpool. Mauldeth Road Primary School is also just a short distance away along with Ladybarn Park with its open green spaces. IN NEED OF COSMETIC UPDATING. The property consists of; A vestibule, an entrance hall with useful understairs storage, a dining room with box bay window to the front aspect which leads through to the lounge with patio doors leading out into the rear enclosed garden. A modern fitted kitchen with access out into the rear garden complete the ground floor. Whilst to the first floor the landing reveals three good sized bedrooms and a three-piece bathroom suite. The property benefits from gas fired central heating, a driveway proving off road parking and a rear enclosed garden. OFFERED WITH NO VENDOR CHAIN.







## EPC Chart

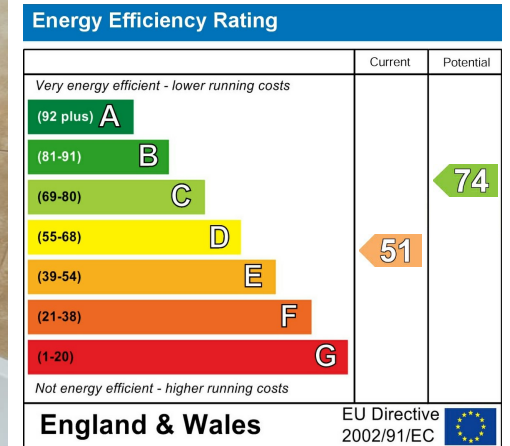

Tenure: **Freehold** Council Tax Band: **C**

## Ground Floor

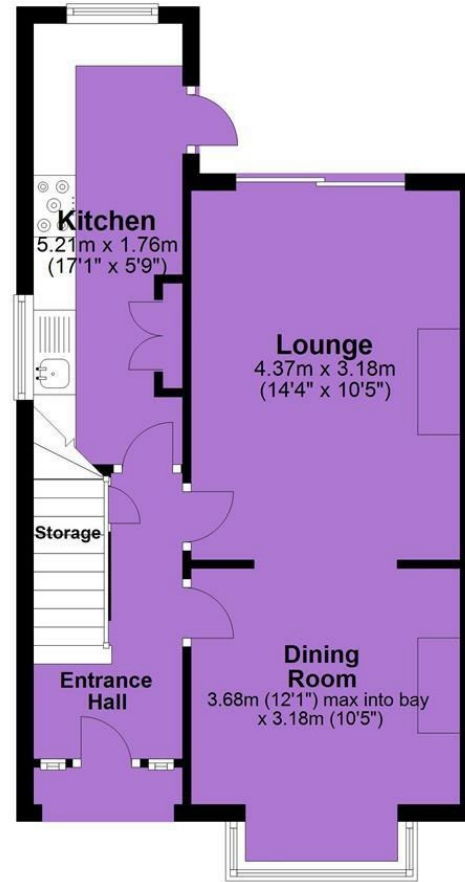

## First Floor

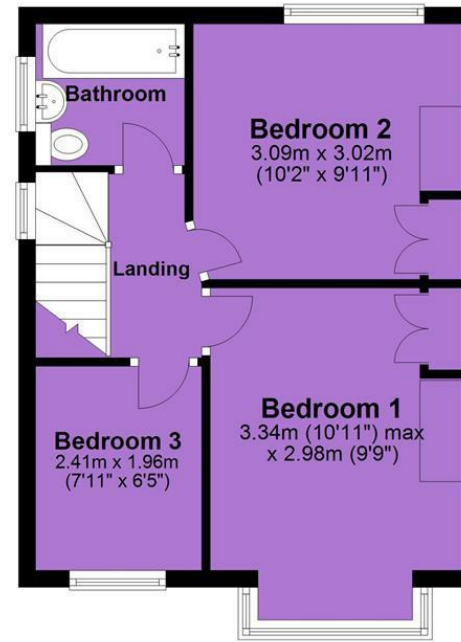

JP & Brimelow Estate Agents Ltd  
430 Barlow Moor Road, Manchester, M21 8AD  
Tel: 0161 8822233

E: sales@jpbrimelow.co.uk www.jpandbrimelow.co.uk



**JP & Brimelow**  
ESTATE AGENTS

NOTICE: JP & Brimelow Estate Agents Ltd for themselves and for the vendors or lessors of this property whose agents they are give notice that:

- (i) the particulars are set out as a general outline only for the guidance of intending purchasers or lessees, and do not constitute, nor constitute part of, an offer or contract;
- (ii) all descriptions, dimensions, references to the condition and necessary permissions for use and occupation, and other details are given in good faith and are believed to be correct but any intending purchasers or tenants should not rely on them as statements or representations of fact but must satisfy themselves by inspection or otherwise as to the correctness of each of them;
- (iii) no person in the employment of JP & Brimelow Estate Agents Ltd has any authority to make or give any representation or warranty whatever in relation to this property.

jpandbrimelowestateagents

@jpandbrimelow