

69 Provis Road, Chorlton Green, Manchester, M21 9EN



JP&Brimelow
ESTATE AGENTS

Offers In The Region Of £395,000



VIDEO TOUR AVAILABLE A beautifully presented & spacious TWO DOUBLE BEDROOM, period mid-terrace property in Chorlton Green. Located off the vibrant Beech Road. This bay-fronted home is within easy walking distance of all the independent shops, bars and restaurants and Beech Road Park. Transport links on Barlow Moor Road, give you direct access into the city centre and to Manchester airport. Chorlton Nature Reserve and excellent primary schools are also close by. In brief, this well-planned accommodation consists of an entrance hall leading to an open plan lounge/dining room with a bay window to the front aspect. An attractive fitted kitchen with access out into the rear enclosed lawned courtyard style garden complete the ground floor. Whilst to the first floor there is a landing leading to two double bedrooms and a modern three-piece family bathroom. The property is warmed by gas fired central heating and has an enclosed rear lawned garden with a decked patio terrace. This property will make an ideal home for either a first-time buyer or a professional couple due to its prime location.





EPC Chart

| Energy Efficiency Rating | | |
|--|---|-----------|
| | Current | Potential |
| <i>Very energy efficient - lower running costs</i> | | |
| (92 plus) A | | |
| (81-91) B | | 81 |
| (69-80) C | | |
| (55-68) D | 59 | |
| (39-54) E | | |
| (21-38) F | | |
| (1-20) G | | |
| <i>Not energy efficient - higher running costs</i> | | |
| England & Wales | EU Directive 2002/91/EC  | |



Tenure: **Freehold** Council Tax Band: **B**

Ground Floor



First Floor

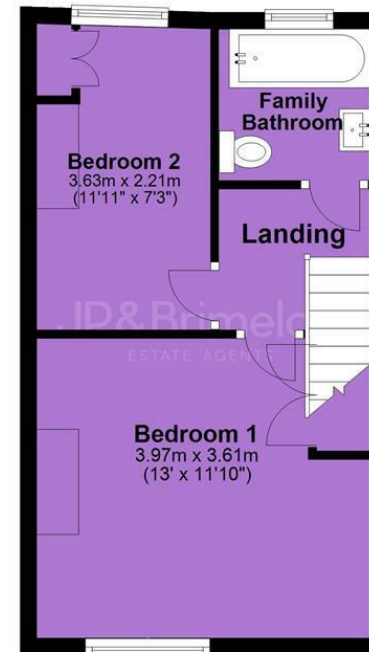

JP & Brimelow Estate Agents Ltd
430 Barlow Moor Road, Manchester, M21 8AD
Tel: 0161 8822233
E: sales@jpbrimelow.co.uk www.jpandbrimelow.co.uk



JP & Brimelow
ESTATE AGENTS

NOTICE: JP & Brimelow Estate Agents Ltd for themselves and for the vendors or lessors of this property whose agents they are give notice that:

- (i) the particulars are set out as a general outline only for the guidance of intending purchasers or lessees, and do not constitute, nor constitute part of, an offer or contract;
- (ii) all descriptions, dimensions, references to the condition and necessary permissions for use and occupation, and other details are given in good faith and are believed to be correct but any intending purchasers or tenants should not rely on them as statements or representations of fact but must satisfy themselves by inspection or otherwise as to the correctness of each of them;
- (iii) no person in the employment of JP & Brimelow Estate Agents Ltd has any authority to make or give any representation or warranty whatever in relation to this property.

jpandbrimelowstateagents

@jpandbrimelow