

Flat 3 Saxon Lodge Woodlands Road, Whalley Range, Manchester, M16 8WR



JP & Brimelow
ESTATE AGENTS

Offers In The Region Of £195,000



VIDEO TOUR AVAILABLE An attractive and beautifully presented ONE DOUBLE BEDROOM and office/nursery room, ground floor apartment. This detached period conversion is set within secure gated grounds. Located on Woodlands Road here in Whalley Range, off Wilbraham Road. Located close by to fantastic transport links into Manchester City centre via either the bus route on Wilbraham Road or Alexandra Road South. The Metrolink station on Wilbraham Road in Chorlton and the local motorway network. The well-planned accommodation consists of a communal entrance hallway, a private entrance hall, a lovely open plan lounge/dining room/fully fitted kitchen, one double bedroom and a office/nursery room the master benefiting from a three-piece en-suite shower room and storage cupboard. A fitted three-piece bathroom suite completes this delightful apartment. The apartment benefits from gas fired central heating, high ceilings and secure gated allocated parking.





EPC Chart

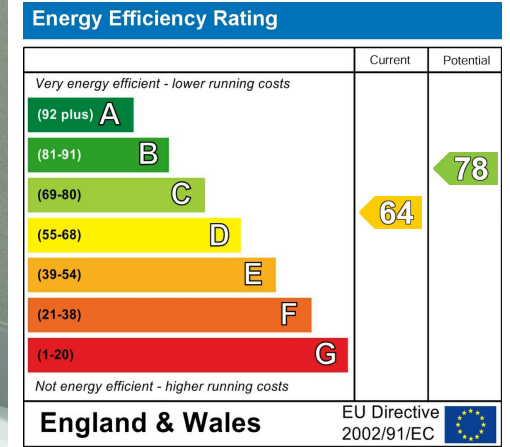

Tenure: **Leasehold** Council Tax Band: **A**

Ground Floor

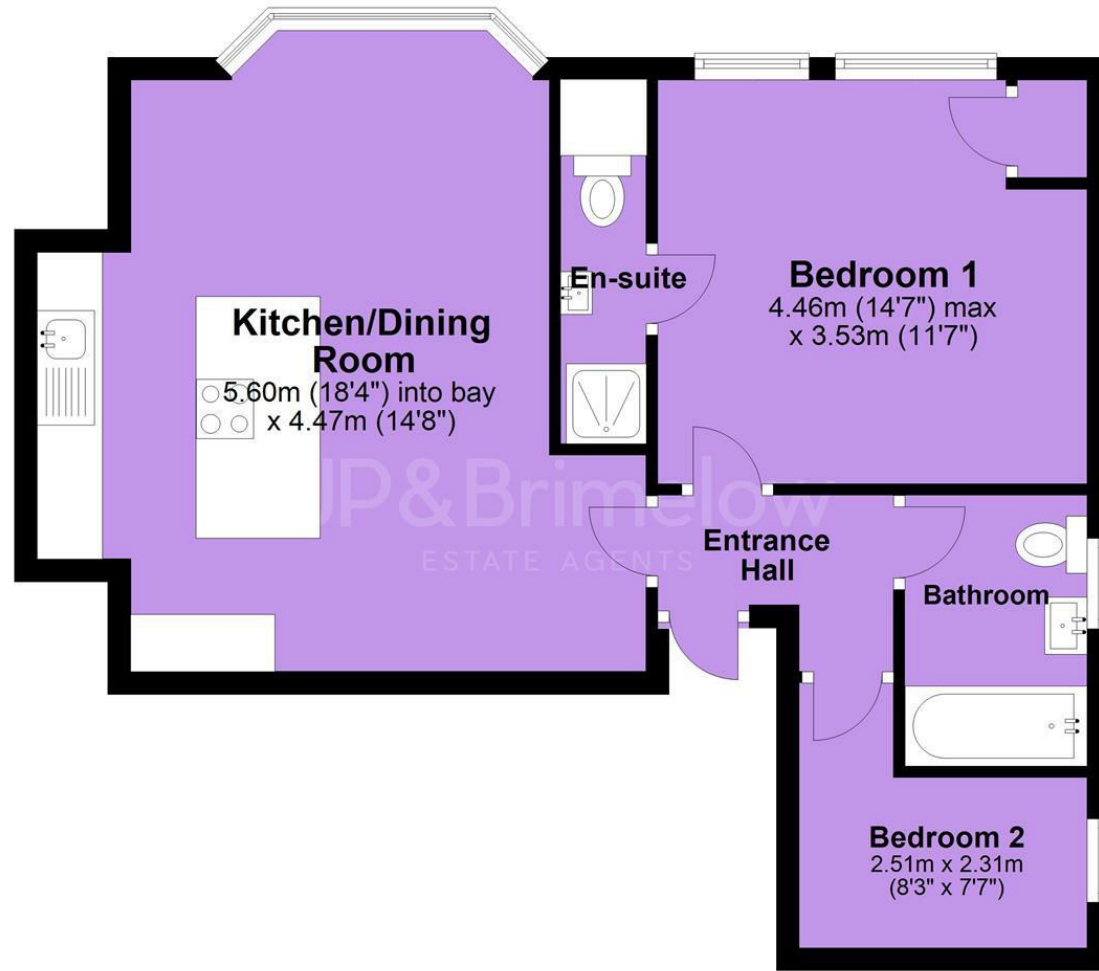

JP & Brimelow Estate Agents Ltd
430 Barlow Moor Road, Manchester, M21 8AD
Tel: 0161 8822233
E: sales@jpbrimelow.co.uk www.jpandbrimelow.co.uk



JP & Brimelow
ESTATE AGENTS

NOTICE: JP & Brimelow Estate Agents Ltd for themselves and for the vendors or lessors of this property whose agents they are give notice that:

- (i) the particulars are set out as a general outline only for the guidance of intending purchasers or lessees, and do not constitute, nor constitute part of, an offer or contract;
- (ii) all descriptions, dimensions, references to the condition and necessary permissions for use and occupation, and other details are given in good faith and are believed to be correct but any intending purchasers or tenants should not rely on them as statements or representations of fact but must satisfy themselves by inspection or otherwise as to the correctness of each of them;
- (iii) no person in the employment of JP & Brimelow Estate Agents Ltd has any authority to make or give any representation or warranty whatever in relation to this property.

jpandbrimelowstateagents

@jpandbrimelow