

Apt 20 Chorlton Plaza Chorlton Plaza, Manchester Road, Chorlton, Manchester, M21 9BG



JP & Brimelow
ESTATE AGENTS

Offers In The Region Of £250,000

🛏️ 2 🚿 2 🛋️ 1 ☰ D

VIDEO TOUR AVAILABLE A stylish & beautifully presented TWO DOUBLE BEDROOM APARTMENT positioned on the TOP FLOOR to the front aspect of this attractive modern development known as Chorlton Plaza. Located in the centre of Chorlton with its independent shops, restaurants and bars. All aspects of living in this energetic location have been considered, from the peace and tranquillity of nearby large open green spaces to the lively night-life of the thriving food and drink scene. Apartment 20 is one of the larger style two bedroom top floor properties within the development with a preferred corner position and dual aspect to both front and rear of the block. The accommodation comprises; a communal entrance hallway with a lift and stairs to all floors, a private entrance into the lounge/dining area, a fitted kitchen, two double bedrooms, master benefitting from a three-piece en-suite shower room and a further three-piece shower room. The apartment benefits from a camera intercom system, 1 x off street gated allocated off-street parking space, 4 x Solar panels on the roof, warmed by electric heating and additional storage cupboard completes this fantastic apartment. * building has no issues with regards the building safety act 2022*





EPC Chart

Energy Efficiency Rating		
	Current	Potential
<i>Very energy efficient - lower running costs</i>		
(92 plus) A		
(81-91) B		
(69-80) C		
(55-68) D	60	60
(39-54) E		
(21-38) F		
(1-20) G		
<i>Not energy efficient - higher running costs</i>		
England & Wales	EU Directive 2002/91/EC 	



Tenure: **Leasehold** Council Tax Band: **C**

Top Floor

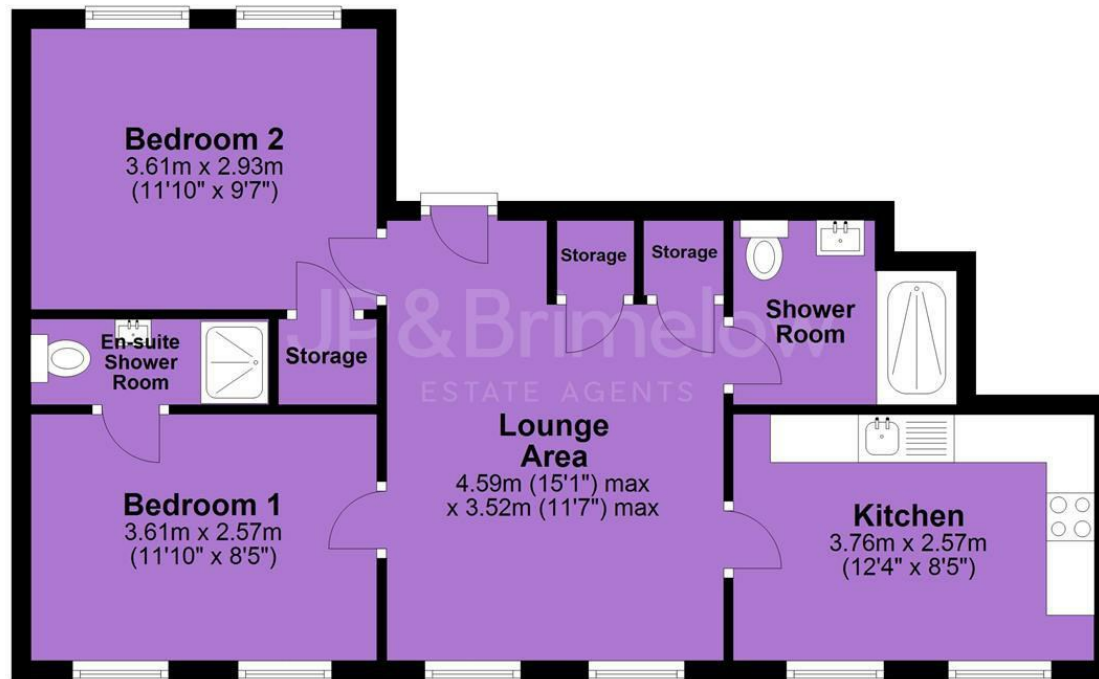

JP & Brimelow Estate Agents Ltd
430 Barlow Moor Road, Manchester, M21 8AD
Tel: 0161 8822233
E: sales@jpbrimelow.co.uk www.jpandbrimelow.co.uk



JP & Brimelow
ESTATE AGENTS

NOTICE: JP & Brimelow Estate Agents Ltd for themselves and for the vendors or lessors of this property whose agents they are give notice that:

- the particulars are set out as a general outline only for the guidance of intending purchasers or lessees, and do not constitute, nor constitute part of, an offer or contract;
- all descriptions, dimensions, references to the condition and necessary permissions for use and occupation, and other details are given in good faith and are believed to be correct but any intending purchasers or tenants should not rely on them as statements or representations of fact but must satisfy themselves by inspection or otherwise as to the correctness of each of them;
- no person in the employment of JP & Brimelow Estate Agents Ltd has any authority to make or give any representation or warranty whatever in relation to this property.

jpandbrimelowstateagents

@jpandbrimelow