

Apt 6, 637 Wilbraham Road, Chorlton, Manchester, M21 9JT



FOR SALE
JP&Brimelow
ESTATE AGENTS
0161 882 2233

JP&Brimelow
ESTATE AGENTS

Offers In The Region Of £215,000



VIDEO TOUR AVAILABLE An attractive and spacious, ONE DOUBLE BEDROOM, ground floor apartment within this bay fronted period Victorian semi-detached property. Situated in a leafy location here in Chorlton on a highly popular residential road. Within strolling distance to the both the centre of Chorlton and Beech Road, with all its independent shops, local amenities and parks. The Metrolink on Wilbraham Rd gives direct access into the City Centre and Media city. The well-planned accommodation consists of a communal entrance hallway, a private entrance, a lounge/dining to the front aspect, a fitted kitchen, a double bedroom with a bay window, and a three-piece bathroom suite. The property is warmed by gas fired central heating, has off road parking to the front aspect and well established communal lawned garden to the rear.





EPC Chart

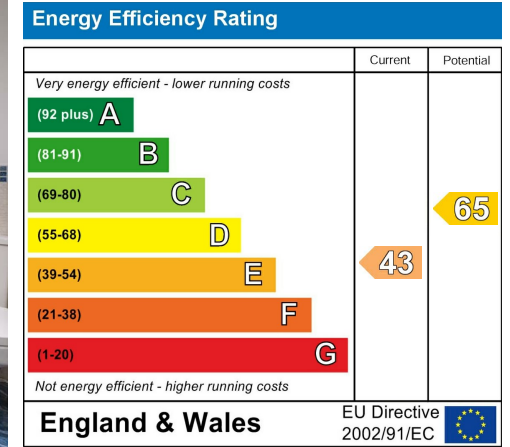

Tenure: **Leasehold** Council Tax Band: **B**

Ground Floor

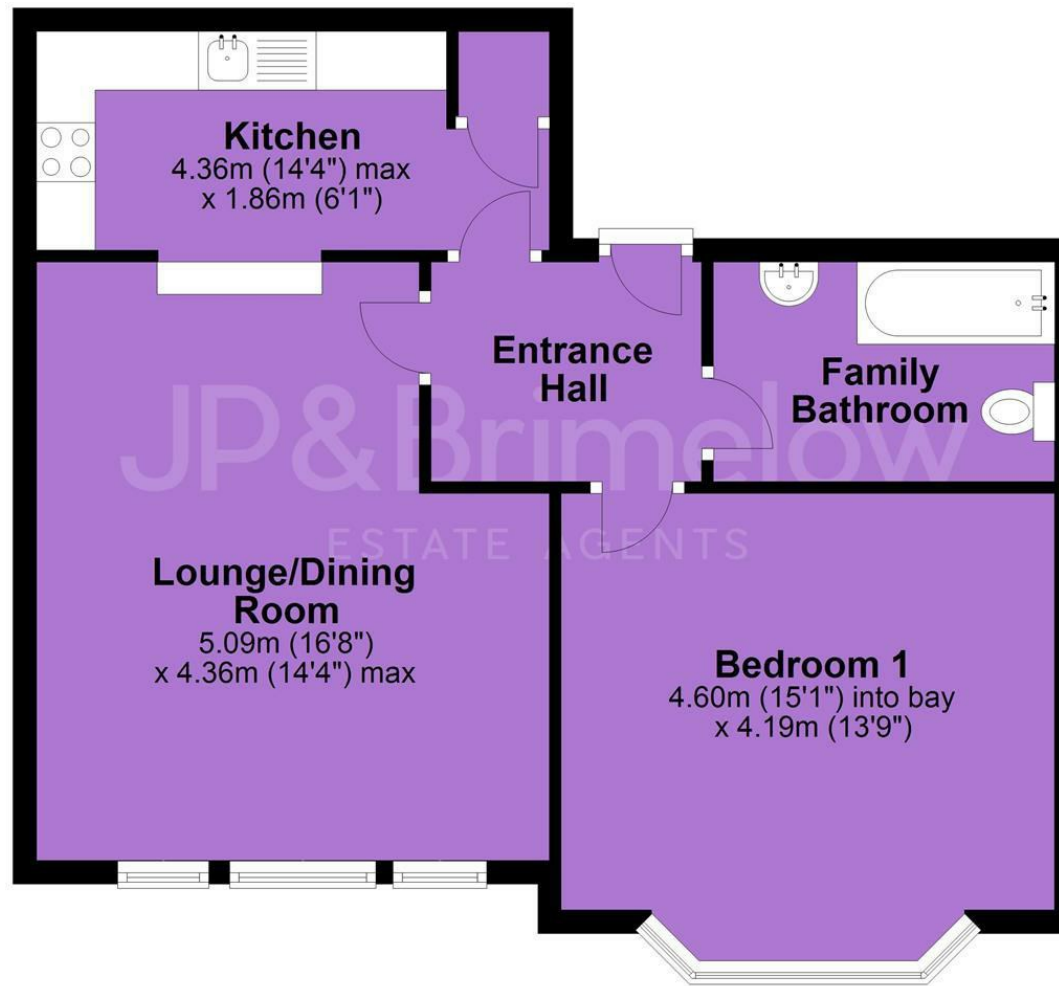

JP & Brimelow Estate Agents Ltd
430 Barlow Moor Road, Manchester, M21 8AD
Tel: 0161 8822233
E: sales@jpbrimelow.co.uk www.jpandbrimelow.co.uk



JP & Brimelow
ESTATE AGENTS

NOTICE: JP & Brimelow Estate Agents Ltd for themselves and for the vendors or lessors of this property whose agents they are give notice that:

- (i) the particulars are set out as a general outline only for the guidance of intending purchasers or lessees, and do not constitute, nor constitute part of, an offer or contract;
- (ii) all descriptions, dimensions, references to the condition and necessary permissions for use and occupation, and other details are given in good faith and are believed to be correct but any intending purchasers or tenants should not rely on them as statements or representations of fact but must satisfy themselves by inspection or otherwise as to the correctness of each of them;
- (iii) no person in the employment of JP & Brimelow Estate Agents Ltd has any authority to make or give any representation or warranty whatever in relation to this property.

 [jpandbrimelowstateagents](https://www.instagram.com/jpandbrimelowstateagents)

 [@jpandbrimelow](https://www.twitter.com/jpandbrimelow)