

64 Egerton Road South, Chorlton, Manchester, M21 0ZH



JP&Brimelow
ESTATE AGENTS

Offers In The Region Of £415,000

 3  1  2  D

VIDEO TOUR AVAILABLE A delightful and well-presented THREE BEDROOM, bay fronted semi-detached property boasting a large private rear garden. Situated on this highly popular residential road, off St Werburgh's Road in Chorlton. Within Strolling distance to the centre of Chorlton, Chorlton Park and Beech Road with an array of shops, bars and restaurants. Ideally located within a short walk of the Metrolink station on St Werburgh's Road, giving you easy access to The City Centre, Manchester Airport and Media City. In brief the accommodation consists of; A porch, an entrance hallway with W.C, a good-sized lounge with a bay window to the front aspect, a spacious dining room, fitted kitchen/ breakfast area with access out to the lawned rear garden. To the first floor there is a landing leading to three good sized bedrooms, two double rooms and one single. A white three-piece bathroom completes this lovely family home. The property benefits from gas central heating, has a driveway providing off road parking to the front aspect and gated access to a larger than average enclosed rear garden plus detached garage.





EPC Chart

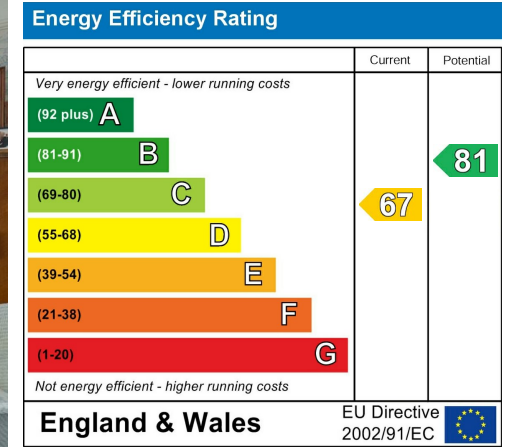

Tenure: **Freehold** Council Tax Band: **C**

Ground Floor

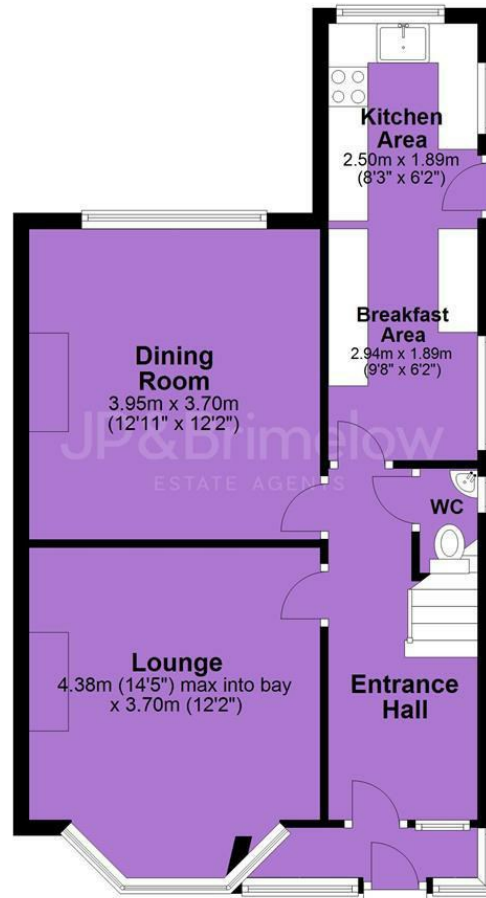

First Floor

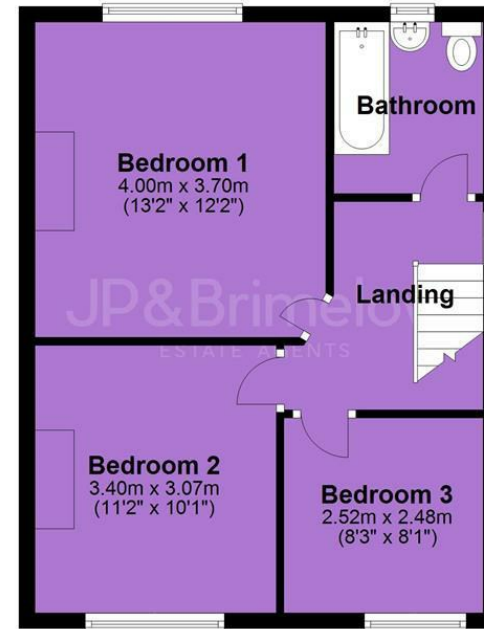

JP & Brimelow Estate Agents Ltd
430 Barlow Moor Road, Manchester, M21 8AD
Tel: 0161 8822233
E: sales@jpbrimelow.co.uk www.jpandbrimelow.co.uk



JP & Brimelow
ESTATE AGENTS

NOTICE: JP & Brimelow Estate Agents Ltd for themselves and for the vendors or lessors of this property whose agents they are give notice that:

- (i) the particulars are set out as a general outline only for the guidance of intending purchasers or lessees, and do not constitute, nor constitute part of, an offer or contract;
- (ii) all descriptions, dimensions, references to the condition and necessary permissions for use and occupation, and other details are given in good faith and are believed to be correct but any intending purchasers or tenants should not rely on them as statements or representations of fact but must satisfy themselves by inspection or otherwise as to the correctness of each of them;
- (iii) no person in the employment of JP & Brimelow Estate Agents Ltd has any authority to make or give any representation or warranty whatever in relation to this property.

jpandbrimelowstateagents

@jpandbrimelow