

10 Higson Avenue, Chorlton Green, Manchester, M21 9FW



JP&Brimelow
ESTATE AGENTS

Offers Over £350,000



****VIDEO TOUR AVAILABLE**** In the heart of Chorlton green, is the setting of this spacious TWO DOUBLE BEDROOM mid-terrace property, on Higson Avenue. This charming mid-terrace home boasts a prime location near the vibrant Beech Road. Providing a lively atmosphere and plenty of amenities at your doorstep with independent shops, bars and restaurants. Upon entering, you are greeted by an entrance hall with access to the open plan lounge/dining room with a bay window to the front aspect. A doorway leads to a fitted kitchen, which providing access into the rear garden. Whilst to the first floor the property offers a landing leading to two double bedrooms and a three-piece bathroom. Ladders provide access into the boarded loft room, providing ample useful storage space. The property is warmed by gas fired central heating and has both front and rear gardens.





EPC Chart

Energy Efficiency Rating		
	Current	Potential
<i>Very energy efficient - lower running costs</i>		
(92 plus) A		
(81-91) B		
(69-80) C		
(55-68) D		
(39-54) E		
(21-38) F		
(1-20) G		
<i>Not energy efficient - higher running costs</i>		
England & Wales	EU Directive 2002/91/EC 	



Tenure: **Freehold** Council Tax Band: **B**

Ground Floor

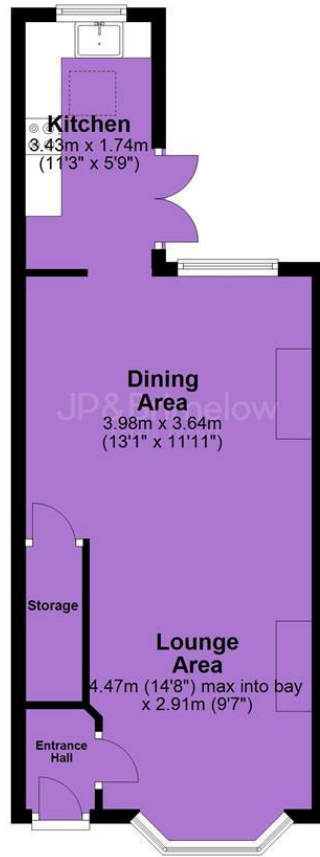

First Floor

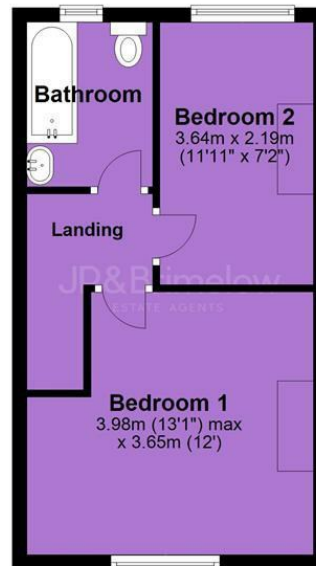

Second Floor



JP & Brimelow Estate Agents Ltd
430 Barlow Moor Road, Manchester, M21 8AD
Tel: 0161 8822233
E: sales@jpbrimelow.co.uk www.jpandbrimelow.co.uk



JP & Brimelow
ESTATE AGENTS

NOTICE: JP & Brimelow Estate Agents Ltd for themselves and for the vendors or lessors of this property whose agents they are give notice that:

- (i) the particulars are set out as a general outline only for the guidance of intending purchasers or lessees, and do not constitute, nor constitute part of, an offer or contract;
- (ii) all descriptions, dimensions, references to the condition and necessary permissions for use and occupation, and other details are given in good faith and are believed to be correct but any intending purchasers or tenants should not rely on them as statements or representations of fact but must satisfy themselves by inspection or otherwise as to the correctness of each of them;
- (iii) no person in the employment of JP & Brimelow Estate Agents Ltd has any authority to make or give any representation or warranty whatever in relation to this property.

jpandbrimelowstateagents

@jpandbrimelow