

22 Bolesworth Close, Chorlton Green, Manchester, M21 9BE



**JP&Brimelow**  
ESTATE AGENTS



# Offers In The Region Of £415,000

 3  1  2  D

\*\*\*VIDEO TOUR AVAILABLE\*\*\* A stylishly presented, THREE BEDROOM, modern, semi-detached property located in a highly popular residential area, off Kingshill Road in the heart of Chorlton Green. Within walking distance to good local primary schools, close to Beech Road with its cafe society and nearby to the Chorlton meadows and the Ees for walks, runs and cycling along the River Mersey. In brief the well-planned accommodation consists; entrance hallway, a lounge to the front aspect and a fitted kitchen/dining room completes the ground floor with access out into the enclosed lawned garden. To the first floor there is a landing leading to three bedrooms and a white three-piece family bathroom with a roll top bath. The property benefits from a gas fired central heating, a driveway providing off road parking, a lawned front and rear garden with a paved patio ideal for a table and chairs. \*\* Planning permission has been granted for a single story side extension, enquire for further details\*\*







## EPC Chart

Energy Efficiency Rating		Current	Potential
Very energy efficient - lower running costs			
(92 plus)	<b>A</b>		
(81-91)	<b>B</b>		<b>85</b>
(69-80)	<b>C</b>	<b>66</b>	
(55-68)	<b>D</b>		
(39-54)	<b>E</b>		
(21-38)	<b>F</b>		
(1-20)	<b>G</b>		
Not energy efficient - higher running costs			
<b>England &amp; Wales</b>			EU Directive 2002/91/EC 



Tenure: **Freehold** Council Tax Band: **C**

## Ground Floor



## First Floor

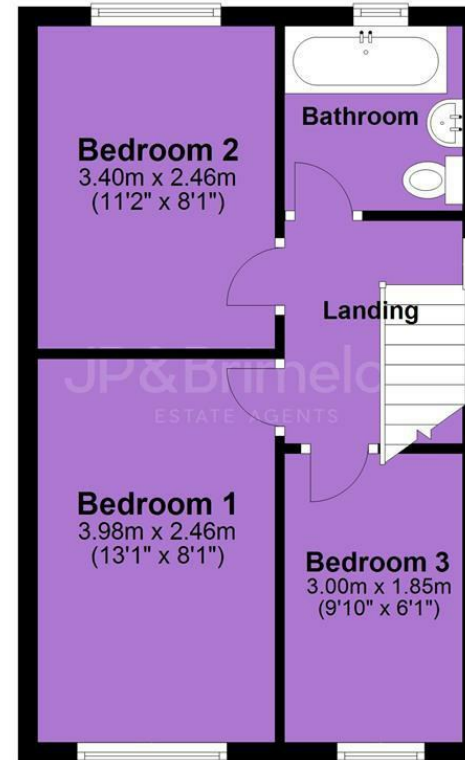

JP & Brimelow Estate Agents Ltd  
430 Barlow Moor Road, Manchester, M21 8AD  
Tel: 0161 8822233  
E: sales@jpbrimelow.co.uk www.jpandbrimelow.co.uk



**JP & Brimelow**  
ESTATE AGENTS

NOTICE: JP & Brimelow Estate Agents Ltd for themselves and for the vendors or lessors of this property whose agents they are give notice that:

- (i) the particulars are set out as a general outline only for the guidance of intending purchasers or lessees, and do not constitute, nor constitute part of, an offer or contract;
- (ii) all descriptions, dimensions, references to the condition and necessary permissions for use and occupation, and other details are given in good faith and are believed to be correct but any intending purchasers or tenants should not rely on them as statements or representations of fact but must satisfy themselves by inspection or otherwise as to the correctness of each of them;
- (iii) no person in the employment of JP & Brimelow Estate Agents Ltd has any authority to make or give any representation or warranty whatever in relation to this property.

jpandbrimelowstateagents

@jpandbrimelow