

26 Norview Drive, East Didsbury, Manchester, M20 5QF



JP & Brimelow
ESTATE AGENTS

Offers In The Region Of £380,000



VIDEO TOUR AVAILABLE This charming detached, THREE BEDROOM property offers a perfect blend of comfort and style. With three reception rooms, there's plenty of downstairs space. Nearby to a selection of local shops on Gawsorth Avenue, Parrswood complex with several restaurants, entertainment, and Parrswood High School. Parrswood train station can be found on Wilmslow Road with access to Manchester International Airport and the city centre. East Didsbury Metrolink Station can be found on Didsbury Road with parking available. This accommodation consists of a porch, an entrance hallway, a lounge, through to a dining room, a family room and a fitted kitchen to the ground floor. Whilst to the first floor there are two double bedrooms, a further single bedroom, currently being used as a shower room. A two-piece shower room and a separate W.C. The property boasts a stunning wrap around garden. Parking is a breeze with a driveway that includes a convenient car port, offering space for multiple vehicles. OFFERED WITH NO VENDOR CHAIN.





EPC Chart

Energy Efficiency Rating		
	Current	Potential
<i>Very energy efficient - lower running costs</i>		
(92 plus) A		
(81-91) B		
(69-80) C		
(55-68) D		
(39-54) E		
(21-38) F		
(1-20) G		
<i>Not energy efficient - higher running costs</i>		
England & Wales	EU Directive 2002/91/EC 	



Tenure: **Freehold** Council Tax Band: **C**

Ground Floor

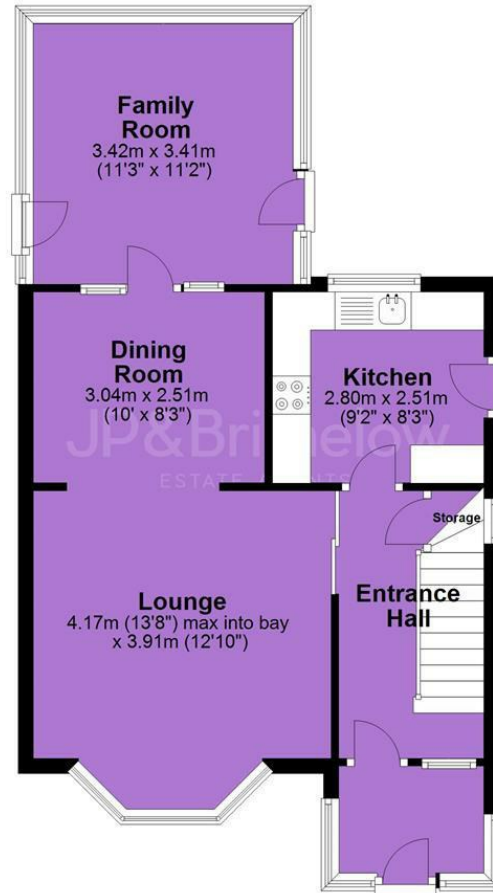

First Floor

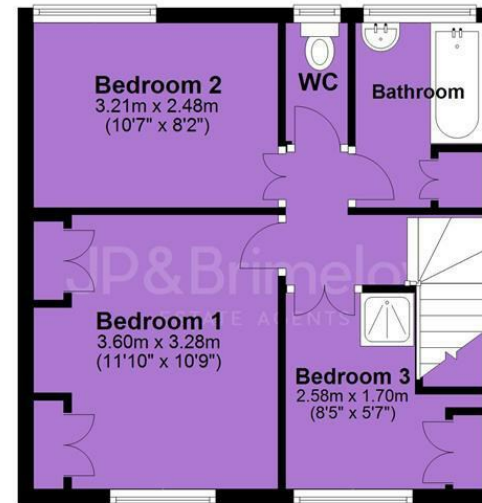

JP & Brimelow Estate Agents Ltd
430 Barlow Moor Road, Manchester, M21 8AD
Tel: 0161 8822233
E: sales@jpbrimelow.co.uk www.jpandbrimelow.co.uk



JP & Brimelow
ESTATE AGENTS

NOTICE: JP & Brimelow Estate Agents Ltd for themselves and for the vendors or lessors of this property whose agents they give notice that:

- (i) the particulars are set out as a general outline only for the guidance of intending purchasers or lessees, and do not constitute, nor constitute part of, an offer or contract;
- (ii) all descriptions, dimensions, references to the condition and necessary permissions for use and occupation, and other details are given in good faith and are believed to be correct but any intending purchasers or tenants should not rely on them as statements or representations of fact but must satisfy themselves by inspection or otherwise as to the correctness of each of them;
- (iii) no person in the employment of JP & Brimelow Estate Agents Ltd has any authority to make or give any representation or warranty whatever in relation to this property.

jpandbrimelowstateagents

@jpandbrimelow