

55 Moss Park Road, Stretford, Trafford, M32 9HZ



JP&Brimelow
ESTATE AGENTS

Offers In The Region Of £425,000

 3  1  2  D

VIDEO TOUR AVAILABLE A beautifully presented & extended THREE BEDROOM, bay fronted semi-detached property. Located on a highly popular residential road positioned off Manor Road here in Stretford. Moss Park can be found at the bottom of the road, Stretford Grammar school and Moss Park Junior School are close by, as well as Victoria Park and Stretford Civic Hall. Fantastic bus routes at the bottom of the road and the Stretford Metrolink station on Edge Lane gives you direct access into the city centre and Altrincham. In brief, this spacious accommodation consists; A porch, an entrance hall with built in storage, downstairs W.C- both benefitting from underfloor heating. A large bay fronted lounge/ diner leading through to a conservatory at the rear which has access through patio doors into the rear enclosed garden. A stylishly presented fitted kitchen with underfloor heating complete with marble tiles and quartz work tops. To the first floor there is a landing leading to three bedrooms which all benefit from built in storage. A three-piece bathroom can also be found on this floor completing this lovely home. The property benefits from gas fired central heating, a driveway providing off road parking, a rear enclosed garden and a useful shed.





EPC Chart

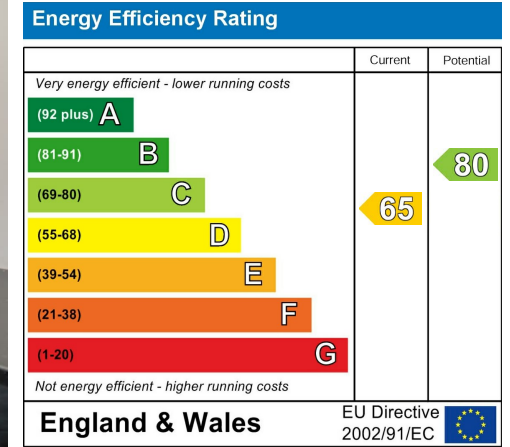

Tenure: **Leasehold** Council Tax Band: **C**

Ground Floor

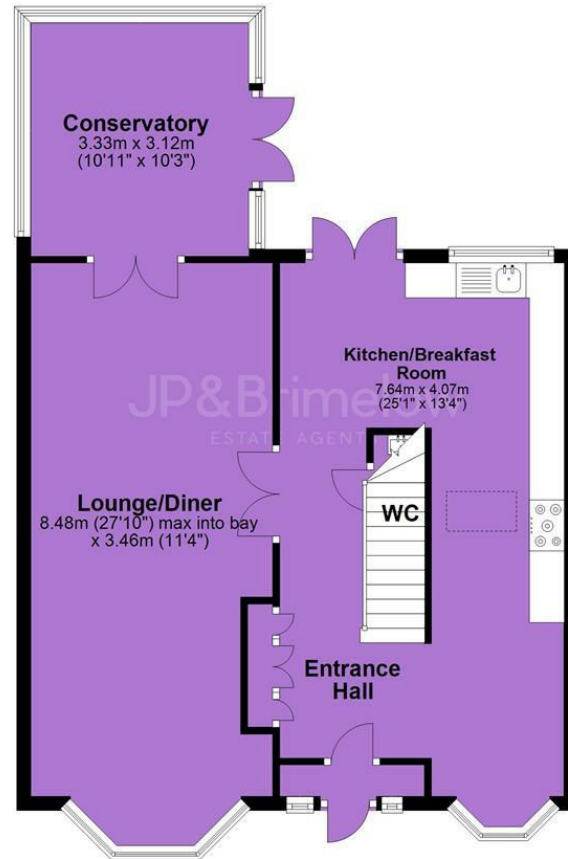

First Floor

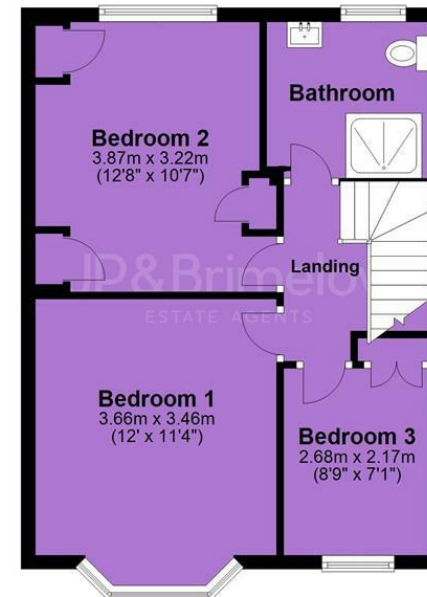

JP & Brimelow Estate Agents Ltd
430 Barlow Moor Road, Manchester, M21 8AD
Tel: 0161 8822233
E: sales@jpbrimelow.co.uk www.jpandbrimelow.co.uk



JP & Brimelow
ESTATE AGENTS

NOTICE: JP & Brimelow Estate Agents Ltd for themselves and for the vendors or lessors of this property whose agents they are give notice that:

- (i) the particulars are set out as a general outline only for the guidance of intending purchasers or lessees, and do not constitute, nor constitute part of, an offer or contract;
- (ii) all descriptions, dimensions, references to the condition and necessary permissions for use and occupation, and other details are given in good faith and are believed to be correct but any intending purchasers or tenants should not rely on them as statements or representations of fact but must satisfy themselves by inspection or otherwise as to the correctness of each of them;
- (iii) no person in the employment of JP & Brimelow Estate Agents Ltd has any authority to make or give any representation or warranty whatever in relation to this property.

jpandbrimelowstateagents

@jpandbrimelow