

The Gables, 30 Manor Drive, Chorlton, Manchester, M21 7GQ



JP&Brimelow
ESTATE AGENTS



 7  5  3 

VIDEO TOUR AVAILABLE A unique & tastefully extended, SEVEN DOUBLE BEDROOMED, detached family residence, located on a highly desirable residential tree lined road here in Chorlton.

Within walking distance to Chorlton Water Park, Burton Road in West Didsbury, fantastic transport links on your doorstep into Manchester City Centre which will provide easy access to a range of amenities including theatres, museums, art galleries and all the excitement of city life and Manchester International Airport for easy national and international flights.

This well-planned property comprises; a porch, entrance hallway, a study, a lounge with a bay window to the front aspect, a bedroom with an ensuite shower room with views into the rear enclosed lawned garden, a fabulous conservatory leading out into the lawned garden with a paved patio. A dining room, a morning room and a fitted kitchen/breakfast room can also be found on the ground floor with access out to the gated driveway.

To the first floor there are six double bedrooms, two of them benefit from ensuite bathrooms and an ensuite shower room.

The property also benefits from many period features throughout such as high ceilings with ornate decorative ceiling detail, picture rails, original stained and leaded lights throughout, an alarm system, warmed by gas fired central heating, a gated driveway providing ample off-road parking leading to a detached double garage and a private enclosed lawned garden to four sides.

£1,100,000





EPC Chart

Energy Efficiency Rating		Current	Potential
Very energy efficient - lower running costs			
(92 plus) A			80
(81-91) B			
(69-80) C			
(55-68) D		59	
(39-54) E			
(21-38) F			
(1-20) G			
Not energy efficient - higher running costs			
England & Wales		EU Directive 2002/91/EC 	



Tenure: Leasehold Council Tax Band: G

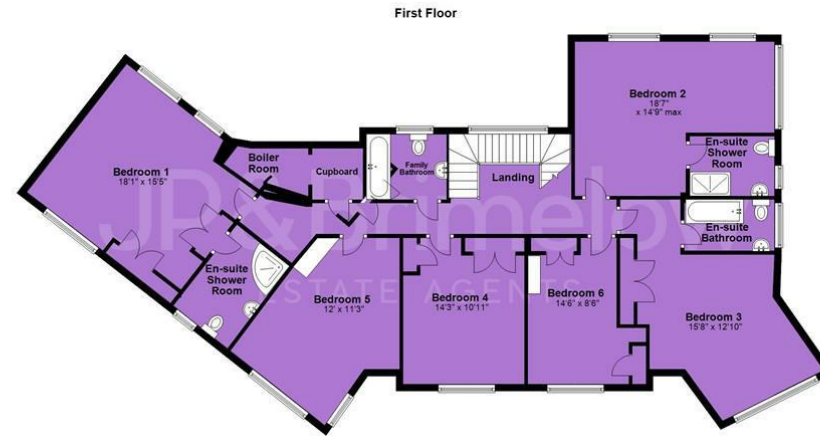
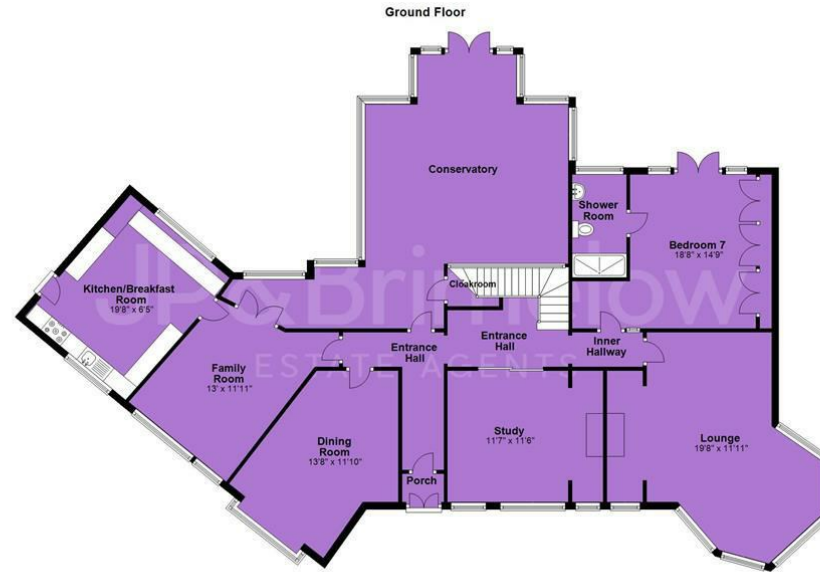

JP & Brimelow Estate Agents Ltd
 430 Barlow Moor Road, Manchester, M21 8AD
 Tel: 0161 8822233
 E: sales@jpbrimelow.co.uk www.jpandbrimelow.co.uk



JP & Brimelow
 ESTATE AGENTS

NOTICE: JP & Brimelow Estate Agents Ltd for themselves and for the vendors or lessors of this property whose agents they are give notice that:
 (i) the particulars are set out as a general outline only for the guidance of intending purchasers or lessees, and do not constitute, nor constitute part of, an offer or contract;
 (ii) all descriptions, dimensions, references to the condition and necessary permissions for use and occupation, and other details are given in good faith and are believed to be correct but any intending purchasers or tenants should not rely on them as statements or representations of fact but must satisfy themselves by inspection or otherwise as to the correctness of each of them;
 (iii) no person in the employment of JP & Brimelow Estate Agents Ltd has any authority to make or give any representation or warranty whatever in relation to this property.

jpandbrimelowstateagents
 @jpandbrimelow

