

1 Stanley Road, Whalley Range, Manchester, M16 8HT



**JP&Brimelow**  
ESTATE AGENTS



 3  1  1  D

\*\*\*VIDEO TOUR AVAILABLE\*\*\* A beautifully extended, THREE BEDROOM semi detached property, situated off Alexandra Road South, in Whalley Range. Close to St Bede's college and a stone's throw away from Alexandra Park.

The spacious property consists of an entrance hallway with useful storage, a downstairs W.C, an impressive lounge opening through to the extended fitted kitchen/diner, complete with bi-fold doors leading out to the rear South East facing garden.

Whilst to the first floor there is a landing leading to two double bedrooms, a three-piece modern bathroom suite and a further bedroom.

Local amenities nearby in both Whalley Range and Chorlton, with excellent transport links on your doorstep giving you the commuter direct access into the City Centre, Media City and Manchester International Airport.

Additional features include gas fired central heating, a gated driveway, providing ample secure off road parking for multiple vehicles and both front and rear enclosed gardens.

£450,000





## EPC Chart

| Energy Efficiency Rating                    |  | Current   | Potential |
|---|--|---|-----------|
| Very energy efficient - lower running costs |  |   |           |
| (92 plus) A                                 |  |   | 82        |
| (81-91) B                                   |  |   |           |
| (69-80) C                                   |  |   |           |
| (55-68) D                                   |  | 65  |           |
| (39-54) E                                   |  |   |           |
| (21-38) F                                   |  |   |           |
| (1-20) G                                    |  |   |           |
| Not energy efficient - higher running costs |  |   |           |
| <b>England &amp; Wales</b>                  |  | EU Directive 2002/91/EC  |           |



Tenure: Freehold Council Tax Band: B

### Ground Floor

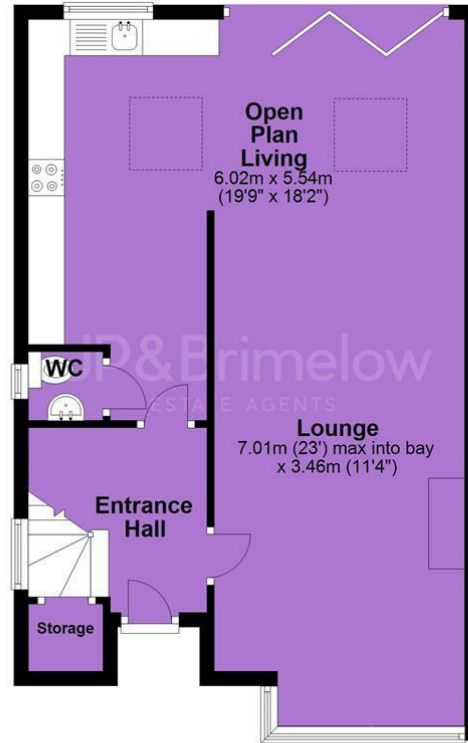

### First Floor

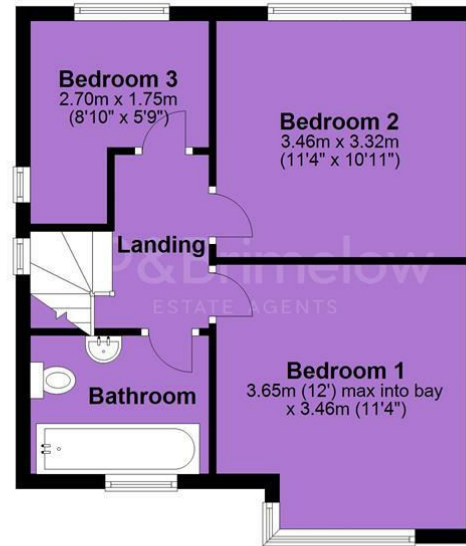

JP & Brimelow Estate Agents Ltd  
430 Barlow Moor Road, Manchester, M21 8AD  
Tel: 0161 8822233  
E: sales@jpbrimelow.co.uk www.jpandbrimelow.co.uk



**JP & Brimelow**  
ESTATE AGENTS

NOTICE: JP & Brimelow Estate Agents Ltd for themselves and for the vendors or lessors of this property whose agents they are give notice that:

- (i) the particulars are set out as a general outline only for the guidance of intending purchasers or lessees, and do not constitute, nor constitute part of, an offer or contract;
- (ii) all descriptions, dimensions, references to the condition and necessary permissions for use and occupation, and other details are given in good faith and are believed to be correct but any intending purchasers or tenants should not rely on them as statements or representations of fact but must satisfy themselves by inspection or otherwise as to the correctness of each of them;
- (iii) no person in the employment of JP & Brimelow Estate Agents Ltd has any authority to make or give any representation or warranty whatever in relation to this property.

jpandbrimelowstateagents

@jpandbrimelow

