

57 South Drive, Chorltonville, Manchester, M21 8DZ



**JP&Brimelow**  
ESTATE AGENTS



3 2 3 D

\*\*\*VIDEO TOUR AVAILABLE\*\*\* SOLD WITH NO VENDOR CHAIN. A beautifully presented & well-kept THREE DOUBLE BEDROOM, bay-fronted semi-detached property. Situated in a highly sought after Conservation area of Chorltonville.

Perfectly located and within walking distance of Beech Road, with its array of independent shops, cafes, bars and restaurants, Chorlton town centre is also within walking distance.

Inspired by the Garden Village and arts and crafts movement the estate was constructed in 1911 and was designated a Conservation Area in 1991, ensuring that Chorltonville would remain exclusively residential. Outstanding state and independent primary and secondary schools are nearby.

The property boasts many period features throughout. The property consists of; a welcoming entrance hall, W.C, living room with feature bay window to the front, a spacious lounge with fireplace and French doors out to the gardens. An extended kitchen diner with breakfast area and French doors completes the ground floor. Turning stairs lead to the first floor which reveals three good sized bedrooms, store room, shower room and separate W.C.

The property is within walking distance to the Metrolink station, giving you direct access to the city centre. Would ideally suit a couple or a family due to its location. Brookburn Primary School, Beech Road and Chorlton Park are all nearby.

The property benefits from being warmed by gas fired central heating, Solar panels, a driveway providing off road parking, a garage and enclosed rear garden.

£640,000





## EPC Chart

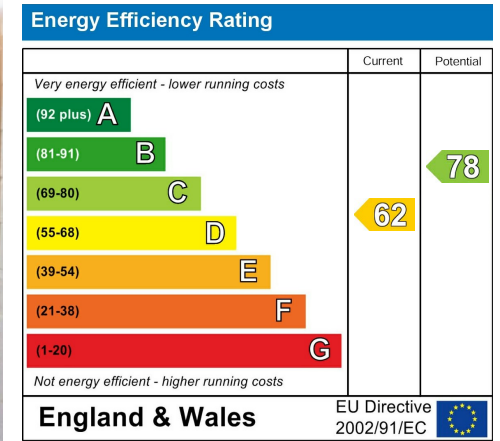

Tenure: Freehold Council Tax Band: E

### Ground Floor

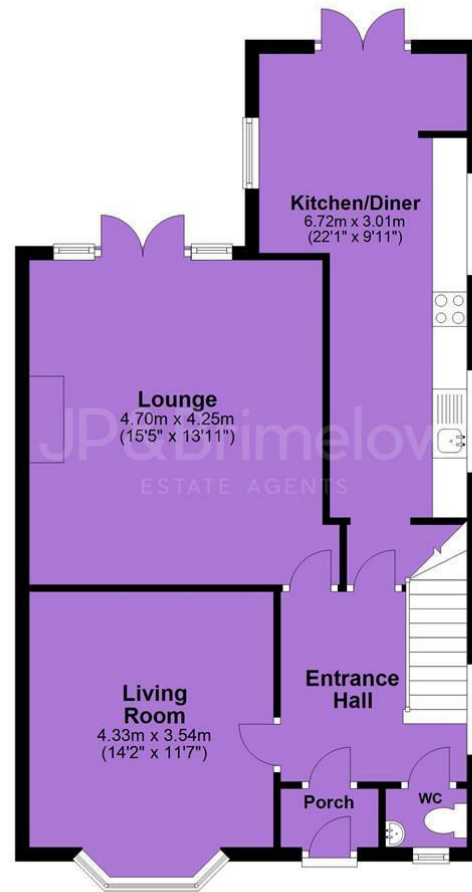

### First Floor

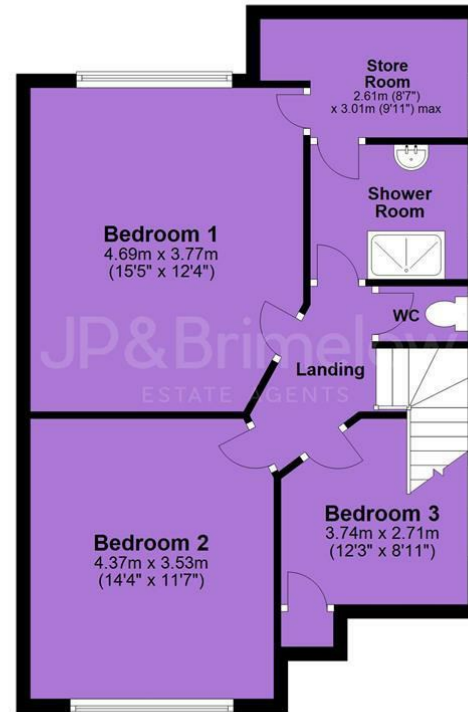

JP & Brimelow Estate Agents Ltd  
430 Barlow Moor Road, Manchester, M21 8AD  
Tel: 0161 8822233  
E: sales@jpbrimelow.co.uk www.jpandbrimelow.co.uk



**JP & Brimelow**  
ESTATE AGENTS

NOTICE: JP & Brimelow Estate Agents Ltd for themselves and for the vendors or lessors of this property whose agents they are give notice that:

- (i) the particulars are set out as a general outline only for the guidance of intending purchasers or lessees, and do not constitute, nor constitute part of, an offer or contract;
- (ii) all descriptions, dimensions, references to the condition and necessary permissions for use and occupation, and other details are given in good faith and are believed to be correct but any intending purchasers or tenants should not rely on them as statements or representations of fact but must satisfy themselves by inspection or otherwise as to the correctness of each of them;
- (iii) no person in the employment of JP & Brimelow Estate Agents Ltd has any authority to make or give any representation or warranty whatever in relation to this property.

jpandbrimelowstateagents

@jpandbrimelow

