

46 Parris Wood Road, Withington, Manchester, M20 4RW



JP & Brimelow
ESTATE AGENTS

Offers In The Region Of £355,000

 3  1  2  D

VIDEO TOUR AVIALABLE A delightful and well-presented THREE BEDROOM, semi-detached property positioned in a central location on Parris Wood Road here in Withington. A short stroll from the independent shops, bars, restaurants and cafes on Wilmslow Road. Ladybarn Park is directly opposite, Mauldeth Road train station and fantastic bus routes nearby giving you direct access into the city centre, Media City and Didsbury village. The well-planned accommodation consists off an entrance hall, dining room to the front aspect, lounge with patio doors leading out in to the rear enclosed garden, a fitted kitchen also allowing access out into the garden. Stairs leading to the first floor reveal three good sized bedrooms and a white three-piece bathroom completing this lovely home. The property benefits from being warmed by gas fired central heating, a driveway providing off road parking and a rear enclosed garden.





EPC Chart

Energy Efficiency Rating		Current	Potential
<i>Very energy efficient - lower running costs</i>			
(92 plus) A			85
(81-91) B			
(69-80) C		65	
(55-68) D			
(39-54) E			
(21-38) F			
(1-20) G			
<i>Not energy efficient - higher running costs</i>			
England & Wales		EU Directive 2002/91/EC 	



Tenure: **Freehold** Council Tax Band: **C**

Ground Floor

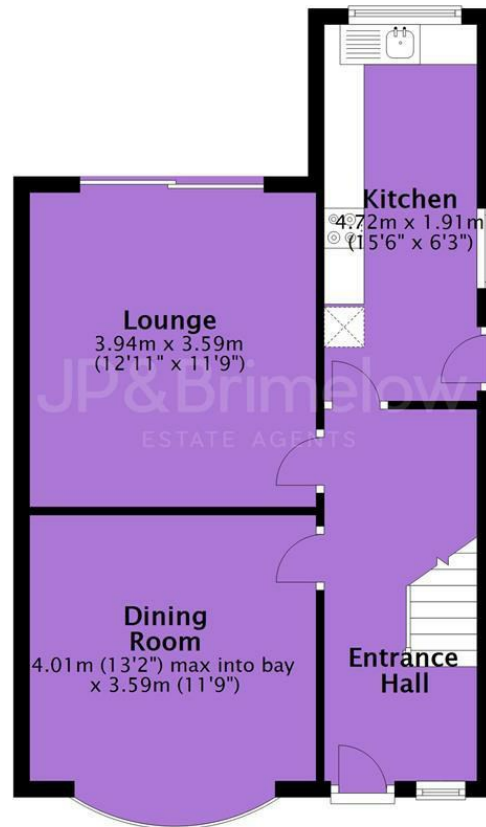

First Floor

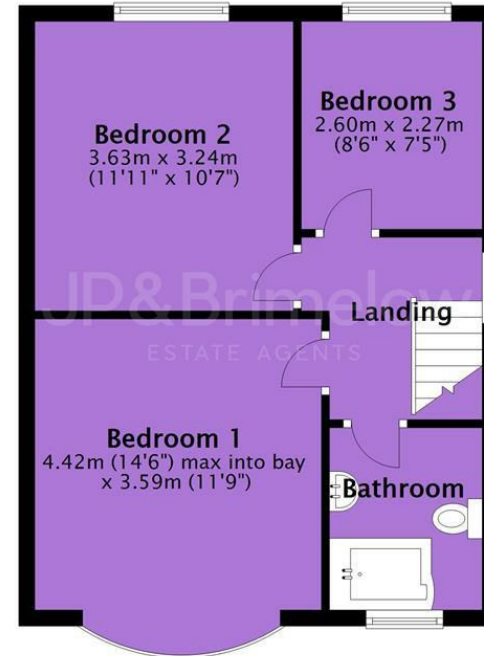

JP & Brimelow Estate Agents Ltd
430 Barlow Moor Road, Manchester, M21 8AD
Tel: 0161 8822233
E: sales@jpbrimelow.co.uk www.jpandbrimelow.co.uk



JP & Brimelow
ESTATE AGENTS

NOTICE: JP & Brimelow Estate Agents Ltd for themselves and for the vendors or lessors of this property whose agents they are give notice that:
(i) the particulars are set out as a general outline only for the guidance of intending purchasers or lessees, and do not constitute, nor constitute part of, an offer or contract;
(ii) all descriptions, dimensions, references to the condition and necessary permissions for use and occupation, and other details are given in good faith and are believed to be correct but any intending purchasers or tenants should not rely on them as statements or representations of fact but must satisfy themselves by inspection or otherwise as to the correctness of each of them;
(iii) no person in the employment of JP & Brimelow Estate Agents Ltd has any authority to make or give any representation or warranty whatever in relation to this property.

jpandbrimelowstateagents

@jpandbrimelow