

14 Waltham Road, Whalley Range, Manchester, M16 8PG



JP&Brimelow
ESTATE AGENTS



 4  2  3  E

VIDEO TOUR AVAILABLE A well-presented & delightful FOUR BEDROOM, traditional, semi-detached property situated on a highly popular residential road here in Whalley Range.

Fantastic transport links close by with the Metrolink Station at Morrisons on Wilbraham Road which gives you direct access into Manchester City Centre and Media City. Good secondary schools on your doorstep, Whalley Range cricket and tennis club are located nearby on Kingsbrook Road, close to universities, hospitals, and Manchester International Airport.

This well-planned property comprises a vestibule porch, a welcoming reception entrance hallway, lounge with a bay window to the front aspect, family room with access into the rear enclosed garden, breakfast room and fitted kitchen also with access out in the rear garden.

To the first floor there is a landing leading to four well-proportioned bedrooms, a three-piece bathroom and separate W.C completing this lovely home.

The property benefits from being warmed by gas fired central heating, high ceilings and period features, a driveway providing ample off-road parking, a large rear enclosed lawned garden and a detached garage with electric supply.

OFFERED WITH NO VENDOR CHAIN.

£595,000





EPC Chart

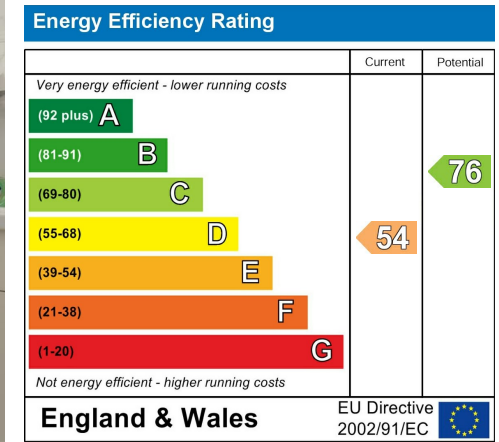

Tenure: Freehold Council Tax Band: D

Ground Floor

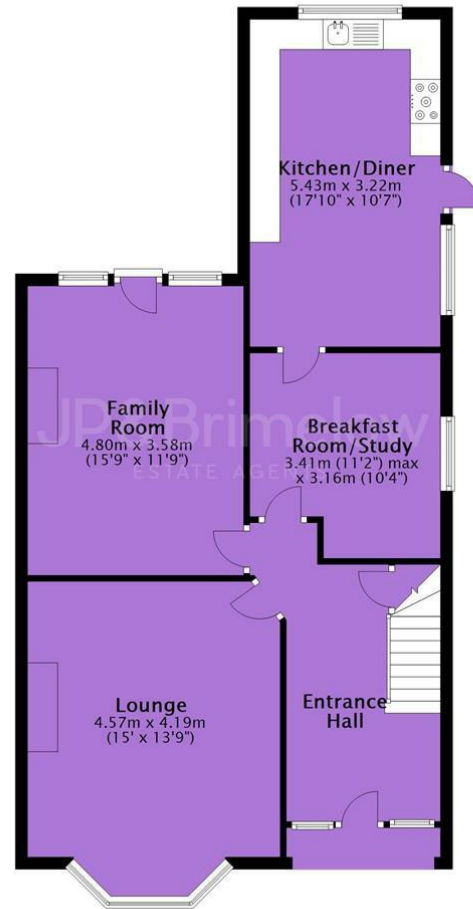

First Floor



JP & Brimelow Estate Agents Ltd
430 Barlow Moor Road, Manchester, M21 8AD
Tel: 0161 8822233
E: sales@jpbrimelow.co.uk www.jpandbrimelow.co.uk



JP & Brimelow
ESTATE AGENTS

NOTICE: JP & Brimelow Estate Agents Ltd for themselves and for the vendors or lessors of this property whose agents they are give notice that:

- (i) the particulars are set out as a general outline only for the guidance of intending purchasers or lessees, and do not constitute, nor constitute part of, an offer or contract;
- (ii) all descriptions, dimensions, references to the condition and necessary permissions for use and occupation, and other details are given in good faith and are believed to be correct but any intending purchasers or tenants should not rely on them as statements or representations of fact but must satisfy themselves by inspection or otherwise as to the correctness of each of them;
- (iii) no person in the employment of JP & Brimelow Estate Agents Ltd has any authority to make or give any representation or warranty whatever in relation to this property.

jpandbrimelowstateagents

@jpandbrimelow

