

42 Neale Road, Chorlton Green, Manchester, M21 9DQ



JP&Brimelow
ESTATE AGENTS

Offers In The Region Of £350,000



VIDEO TOUR AVAILABLE A spacious & well presented, TWO DOUBLE BEDROOM, garden fronted, period mid terrace property. Situated on a desirable tree lined road in the heart of Chorlton Green off Beech Road. Within easy walking distance to all the independent shops, bars, restaurants, Beech Road Park, Chorlton Nature Reserve and fantastic primary schools. In brief, this spacious accommodation consists of; an entrance hall, a through lounge/dining room and a fitted kitchen to the ground floor with access out into the rear enclosed garden. Whilst to the first floor there are two double bedrooms and a modern three piece fitted bathroom. The property benefits from an alarm system, warmed by gas fired central heating and an enclosed rear landscaped courtyard style garden.





EPC Chart

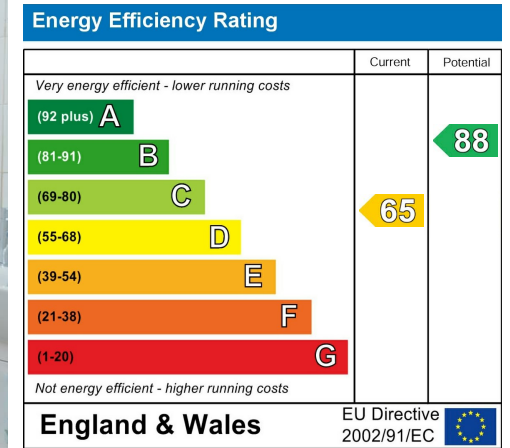

Tenure: **Freehold** Council Tax Band: **B**

Ground Floor

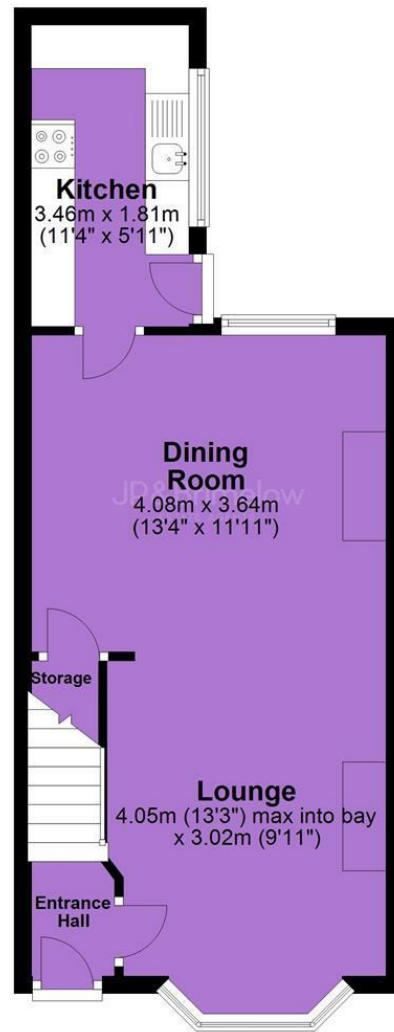

First Floor



JP & Brimelow Estate Agents Ltd
430 Barlow Moor Road, Manchester, M21 8AD
Tel: 0161 8822233
E: sales@jpbbrimelow.co.uk www.jpandbrimelow.co.uk



JP & Brimelow
ESTATE AGENTS

NOTICE: JP & Brimelow Estate Agents Ltd for themselves and for the vendors or lessors of this property whose agents they give notice that:

- (i) the particulars are set out as a general outline only for the guidance of intending purchasers or lessees, and do not constitute, nor constitute part of, an offer or contract;
- (ii) all descriptions, dimensions, references to the condition and necessary permissions for use and occupation, and other details are given in good faith and are believed to be correct but any intending purchasers or tenants should not rely on them as statements or representations of fact but must satisfy themselves by inspection or otherwise as to the correctness of each of them;
- (iii) no person in the employment of JP & Brimelow Estate Agents Ltd has any authority to make or give any representation or warranty whatever in relation to this property.

jpbbrimelowstateagents

@jpbbrimelow