

17 Shuttleworth Close, Whalley Range, Manchester, M16 8NN



**JP&Brimelow**  
ESTATE AGENTS

# Offers In The Region Of £270,000



\*\*\*VIDEO TOUR AVAILABLE\*\*\* A spacious TWO DOUBLE BEDROOM, end terrace property with a driveway and private garden. Nicely tucked away just off Nettleford Road, on the borders of Whalley Range and Chorlton. Located on a highly popular residential cul-de-sac in Whalley Range off Kingsbrook Road, with views to the rear aspect looking over Whalley Range Cricket Club. A fantastic position for the commuter travelling into Manchester city centre, Media city or Manchester airport via the direct bus route or the Metrolink station in Chorlton, on Wilbraham Road. The well-planned accommodation consists of; An entrance hallway, a lounge and a fitted kitchen/dining room to the ground floor, with access into the rear enclosed garden. Whilst to the first floor there are two double bedrooms and a fitted three-piece bathroom suite. The property is warmed by gas fired central heating and has a driveway to the front, providing off-road parking as well as a rear paved garden backing onto the Cricket club.





## EPC Chart

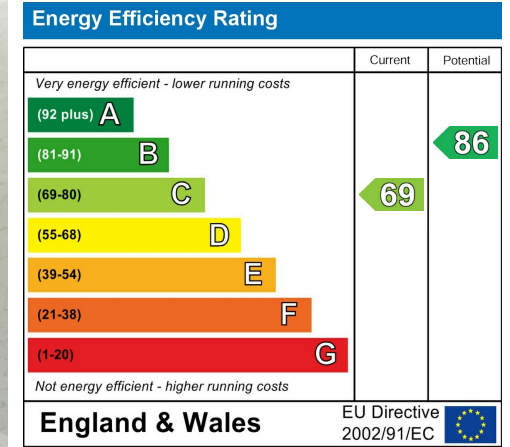

Tenure: **Leasehold** Council Tax Band: **B**

## Ground Floor



## First Floor

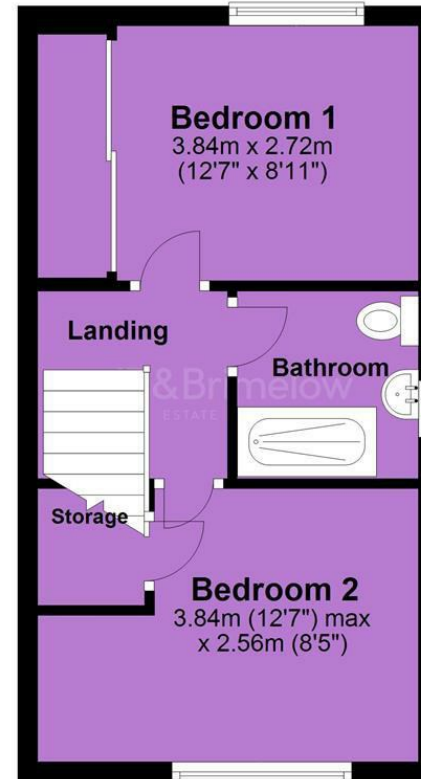

JP & Brimelow Estate Agents Ltd  
430 Barlow Moor Road, Manchester, M21 8AD  
Tel: 0161 8822233  
E: sales@jpbrimelow.co.uk www.jpandbrimelow.co.uk



**JP & Brimelow**  
ESTATE AGENTS

NOTICE: JP & Brimelow Estate Agents Ltd for themselves and for the vendors or lessors of this property whose agents they are give notice that:

- (i) the particulars are set out as a general outline only for the guidance of intending purchasers or lessees, and do not constitute, nor constitute part of, an offer or contract;
- (ii) all descriptions, dimensions, references to the condition and necessary permissions for use and occupation, and other details are given in good faith and are believed to be correct but any intending purchasers or tenants should not rely on them as statements or representations of fact but must satisfy themselves by inspection or otherwise as to the correctness of each of them;
- (iii) no person in the employment of JP & Brimelow Estate Agents Ltd has any authority to make or give any representation or warranty whatever in relation to this property.

jpandbrimelowstateagents

@jpandbrimelow