



**Harrier Way, Hardwicke, Gloucester**

Freehold

**Offers In Excess Of £290,000**

64 Harrier Way, Hardwicke,  
Gloucester, Gloucestershire, GL2 4E

OIEO £290,000

Freehold. Council Tax Band C



3 Bedrooms



2 Bathrooms



2 Receptions

### Features

- \*Upvc Double Glazing
- \* Two Off Road Parking Spaces
- \*Gas Central Heating
- \*En-Suite To Bedroom One
- \*Integrated Kitchen Appliances
- \* Ideal First Time Buy
- \*Kitchen/Diner
- \* Energy Rating B

### Michael Tuck Estate and Letting Agents

1 School Lane Quedgeley Gloucester Gloucestershire GL2 4PJ

01452 543200

estates.quedgeley@michaeltuck.co.uk

[www.michaeltuck.co.uk](http://www.michaeltuck.co.uk)

### The Property

Three Bedroom Semi-Detached Home Built In 2021 By Bovis Homes To The Popular "Magnolia" Design Located On Harrier Way, Hunts Grove.

The accommodation on the ground floor comprises of; Entrance hall, living room, cloakroom & kitchen/diner.

On the top floor we have; three good sized bedrooms & family bathroom.

Further benefits include; Upvc double glazing, gas central heating, integrated kitchen appliances, en-suite to bedroom one & two off road parking spaces!

Property for sale through Michael Tuck Estate Agents. Approximate rental value of £1350pcm, please contact Michael Tuck Lettings in Quedgeley for more details.

Call us today to arrange your viewing on 01452 543200.

### Entrance Hall

**Living Room** 13' 4" x 11' 10" (4.06m x 3.60m)

### Inner Hall

### Cloakroom

**Kitchen/Diner** 16' 9" x 9' 6" (5.10m x 2.89m)

### Landing

**Bedroom 1** 11' 6" x 10' 6" (3.50m x 3.20m)

**En-suite** 6' 5" x 4' 5" (1.95m x 1.35m)

**Bedroom 2** 9' 11" x 9' 7" (3.02m x 2.92m)

**Bedroom 3** 11' 3" x 6' 11" (3.43m x 2.11m)

**Bathroom** 7' 0" x 5' 6" (2.13m x 1.68m)

### Rear Garden

### Two Parking Spaces

### Additional Information

Additional Information provided by vendor:  
Utilities • Electricity – mains • Gas – mains • Water – mains • Sewerage – mains • Broadband – fibre to premises







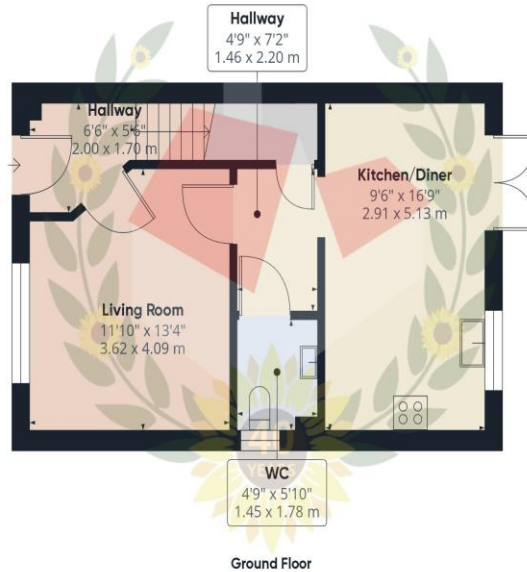

**Approximate total area<sup>(1)</sup>**  
 855.09 ft<sup>2</sup>  
 79.44 m<sup>2</sup>

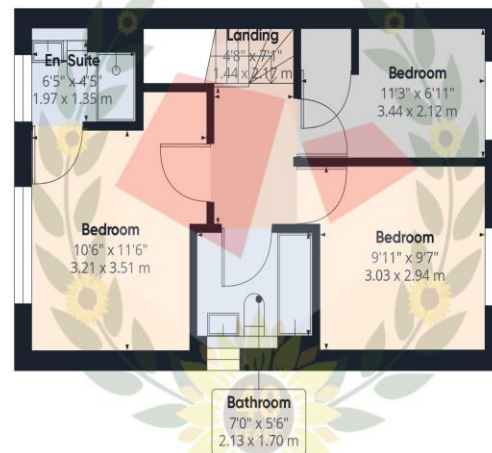

**FOR ILLUSTRATIVE PURPOSES ONLY – NOT TO SCALE**

(1) Excluding balconies and terraces

While every attempt has been made to ensure accuracy, all measurements are approximate, not to scale. This floor plan is for illustrative purposes only.

Calculations are based on RICS IPMS 3C standard.

GIRAFFE360

The position and size of doors, windows, appliances, and other features are approximate only.  
 Unauthorised reproduction prohibited

**Important notice:** Michael Tuck, its clients and any joints give notice that 1: They are not authorised to make or give any representations or warranties in relation to the property either here or elsewhere, either on their own behalf of their client or otherwise. They assume no responsibility for any statement that may be made in these particulars. These particulars do not form part of any offer or contract and must not be relied upon as statements or representation of fact. 2: Any areas, measurements or distances are approximate. The text, photographs and plans are for guidance only and are not necessarily comprehensive. It should not be assumed that the property has all necessary planning, building regulation or other consents and Michael Tuck have not tested any services, equipment or facilities. Purchasers must satisfy themselves by inspection or otherwise.

