



Bybrook Road, Tuffley, Gloucester

Freehold

£325,000

**1 Bybrook Road, Tuffley, Gloucester,
Gloucestershire, GL4 0HF**

£325,000

Freehold. Council Tax Band C



3 Bedrooms



2 Bathrooms



2 Receptions

Features

- *Extended Link Detached "Chalet Style" House
- * No Onward Chain
- *Situated on Corner Plot *Downstairs Double Bedroom and Study
- *Lounge and Extended Kitchen/Breakfast Room * Two DOUBLLE Bedrooms To First Floor
- *Downstairs WC & Upstairs Family Bathroom
- * Energy Rating TBC
- *Garage and Driveway *

Michael Tuck Estate and Letting Agents

1 School Lane Quedgeley Gloucester Gloucestershire GL2 4PJ

01452 543200

estates.quedgeley@michaeltuck.co.uk

The Property

An EXTENDED Link DETACHED "Chalet Style" House situated on a CORNER PLOT with a DOWNSTAIRS BEDROOM & STUDY and available with NO ONWARD CHAIN.

Offering flexible accommodation the ground floor comprises of Entrance Porch, Entrance Hall, Lounge, STUDY, Cloakroom, Extended Kitchen/Breakfast Room and DOUBLE Bedroom. The First Floor provided a further TWO DOUBLE BEDROOMS and Family Bathroom.

Further benefits include UPVC Double Glazing, Gas Radiator Central Heating, driveway and GARAGE

Externally the property is located on a Good sized CORNER PLOT with gardens to front, side and rear providing an incoming purchaser with further potential.

Call 01452 543200 To View!

Entry 4' 10" x 2' 0" (1.47m x 0.61m)

Hallway 10' 9" x 6' 1" (3.27m x 1.85m)

Living Room 18' 0" x 10' 11" (5.48m x 3.32m)

WC 5' 10" x 5' 7" (1.78m x 1.70m)

Kitchen/Breakfast Room 21' 1" x 9' 1" (6.42m x 2.77m)

Bedroom/ Reception Room 11' 4" x 8' 9" (3.45m x 2.66m)

Study 8' 11" x 8' 8" (2.72m x 2.64m)

Landing 12' 2" x 6' 1" (3.71m x 1.85m)

Bedroom 1 12' 10" x 11' 0" (3.91m x 3.35m)

Bedroom 2 12' 10" x 8' 10" (3.91m x 2.69m)

Bathroom 6' 0" x 5' 6" (1.83m x 1.68m)

Additional Information

Gas: Mains

Electricity: Mains

Sewerage & Water: Mains







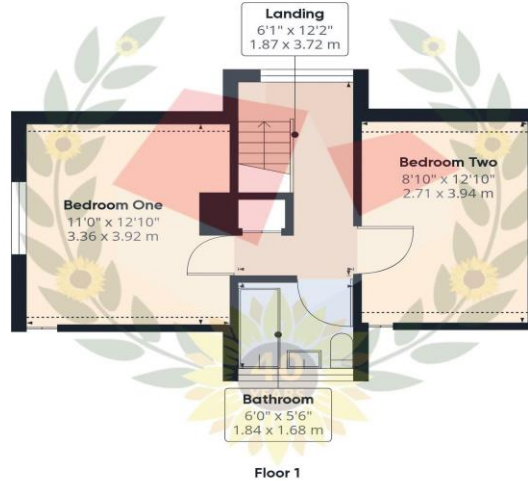
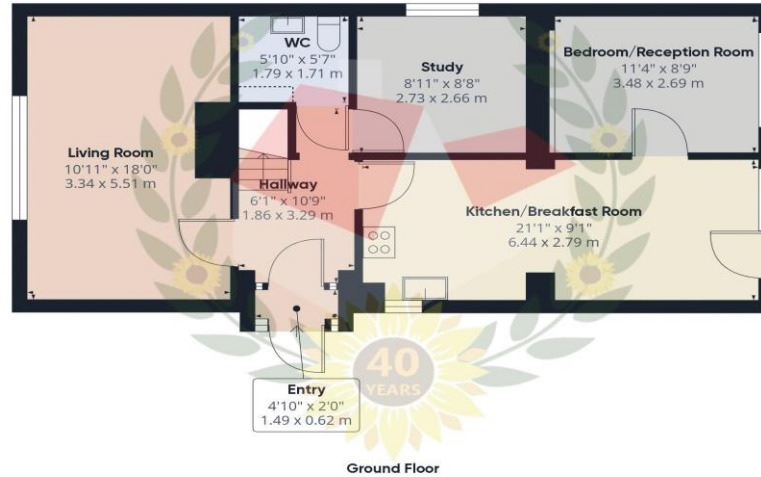

Approximate total area⁽¹⁾

1014.07 ft²
94.21 m²

Reduced headroom

24.22 ft²
2.25 m²

(1) Excluding balconies and terraces

Reduced headroom
----- Below 5 ft/1.5 m

While every attempt has been made to ensure accuracy, all measurements are approximate, not to scale. This floor plan is for illustrative purposes only.

Calculations are based on RICS IPMS 3C standard.

GIRAFFE 360

FOR ILLUSTRATIVE PURPOSES ONLY – NOT TO SCALE

The position and size of doors, windows, appliances, and other features are approximate only.
Unauthorised reproduction prohibited

Important notice: Michael Tuck, its clients and any joints give notice that 1: They are not authorised to make or give any representations or warranties in relation to the property either here or elsewhere, either on their own behalf of their client or otherwise. They assume no responsibility for any statement that may be made in these particulars. These particulars do not form part of any offer or contract and must not be relied upon as statements or representation of fact. 2: Any areas, measurements or distances are approximate. The text, photographs and plans are for guidance only and are not necessarily comprehensive. It should not be assumed that the property has all necessary planning, building regulation or other consents and Michael Tuck have not tested any services, equipment or facilities. Purchasers must satisfy themselves by inspection or otherwise.

