



**Elmgrove Road West, Hardwicke,**  
**Gloucester** Freehold

**£435,000**

**Grove Villa, Elmgrove Road West,  
Hardwicke, Gloucester,  
Gloucestershire, GL2 4PU**

**£435,000**

Freehold. Council Tax Band E



**4 Bedrooms**



**1 Bathrooms**



**2 Receptions**

**Features**

- \*Upvc Double Glazing
- \* Two Reception Rooms
- \*No Onward Chain
- \*Large Utility Room
- \*Garage & Off Road Parking
- \* Private Road
- \*Large Enclosed Rear Garden
- \* Energy Rating D

**Michael Tuck Estate and Letting Agents**

1 School Lane Quedgeley Gloucester Gloucestershire GL2 4PJ

01452 543200

estates.quedgeley@michaeltuck.co.uk

**The Property**

Four Bedroom Detached Home With Large Rear Garden Situated Down A Private Road In A Highly Sought After Area Of Hardwicke That Is Elmgrove Road West. The accommodation on the ground floor includes; Entrance hall, living room, kitchen, dining room, cloakroom & a large utility room. On the top floor we have; Four good sized bedrooms & family bathroom. Further benefits include; Gas central heating, upvc double glazing, single garage & off road parking and a large enclosed rear garden. Call us today to arrange your viewing on 01452 543200!

**Entrance Hall**

**Living Room** 20' 4" x 9' 10" (6.19m x 2.99m)

**Kitchen** 11' 6" x 8' 10" (3.50m x 2.69m)

**Dining Room** 10' 11" x 9' 11" (3.32m x 3.02m)

**Cloakroom**

**Utility room** 16' 5" x 8' 0" (5.00m x 2.44m)

**Landing**

**Bedroom 1** 10' 11" x 10' 0" (3.32m x 3.05m)

**Bedroom 2** 10' 10" x 9' 11" (3.30m x 3.02m)

**Bedroom 3** 8' 11" x 8' 9" (2.72m x 2.66m)

**Bedroom 4** 8' 11" x 8' 8" (2.72m x 2.64m)

**Bathroom** 5' 7" x 5' 5" (1.70m x 1.65m)

**Garage & Off Road Parking**

**Additional Information**

Additional Information provided by vendor:  
Utilities • Electricity – mains • Gas –  
mains • Water – mains • Sewerage – mains











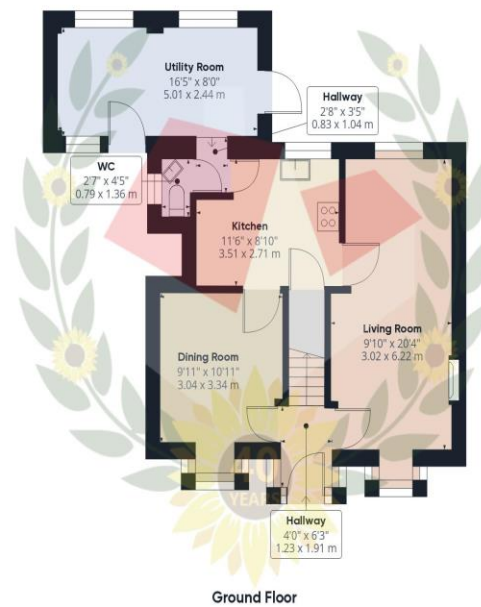

Ground Floor

Approximate total area<sup>(1)</sup>

1056.88 ft<sup>2</sup>  
98.19 m<sup>2</sup>

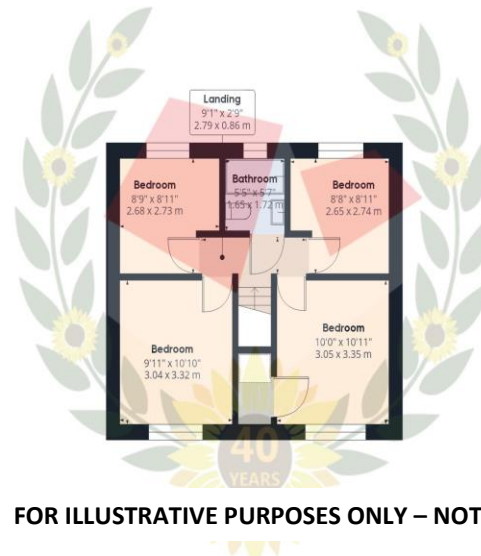

**FOR ILLUSTRATIVE PURPOSES ONLY – NOT TO SCALE**

The position and size of doors, windows, appliances, and other features are approximate only.  
Unauthorised reproduction prohibited

(1) Excluding balconies and terraces

While every attempt has been made to ensure accuracy, all measurements are approximate, not to scale. This floor plan is for illustrative purposes only.

GIRAFFE360

**Important notice:** Michael Tuck, its clients and any joints give notice that 1: They are not authorised to make or give any representations or warranties in relation to the property either here or elsewhere, either on their own behalf of their client or otherwise. They assume no responsibility for any statement that may be made in these particulars. These particulars do not form part of any offer or contract and must not be relied upon as statements or representation of fact. 2: Any areas, measurements or distances are approximate. The text, photographs and plans are for guidance only and are not necessarily comprehensive. It should not be assumed that the property has all necessary planning, building regulation or other consents and Michael Tuck have not tested any services, equipment or facilities. Purchasers must satisfy themselves by inspection or otherwise.

