



Gatehouse Court, Barnsley Road, Dodworth, S75 3LT

£135,000

🛏 2 🚿 2 🛋 1



AN EXCEPTIONALLY WELL-PRESENTED FIRST FLOOR FLAT FEATURING TWO SPACIOUS DOUBLE BEDROOMS, A MODERN INTERIOR AND AN IMPRESSIVE OPEN-PLAN LIVING AREA. OFFERED WITH NO ONWARDS VENDOR CHAIN!

This beautifully presented luxury apartment is positioned on the first floor of this modern complex, located in the desirable village of Dodworth. An ideal property for the professionals, as well as couples, retirees and downsizers as well as first time buyers and property investors.

Located on the outskirts of this sought-after village, with its pleasant village High Street nearby, which features a range of independent shops, cafes, pharmacist and doctors' surgery, as well as a supermarket and several highly rated pubs and restaurants around the village. There are well regarded schools in the area, as well as three hotels, a Bannatyne Gym adjacent to the apartment complex.

Dodworth provides stunning country walks within close proximity, whilst also offering direct access to the M1 motorway network at Junction 37 as well as the rail network from Dodworth Station.

Entrance Hall

Enter this inviting flat through a charming wooden door, leading you into the entrance hall. The entrance hall provides access to Bedroom 1 and a hallway for easy flow throughout the home.

Bedroom 1 (13'5" x 9'3")

A spacious and well-proportioned double bedroom located at the front of the flat, featuring a front-facing double-glazed window. This bedroom also includes access to an en-suite shower room for added convenience.

En-Suite Shower Room

This modern, stylish en-suite is finished with a white three-piece suite, including a step-in shower, a low-flush WC, and a wash hand basin set into a sleek vanity unit. Additional features include a



GROUND FLOOR
697 sq.ft. (64.8 sq.m.) approx.

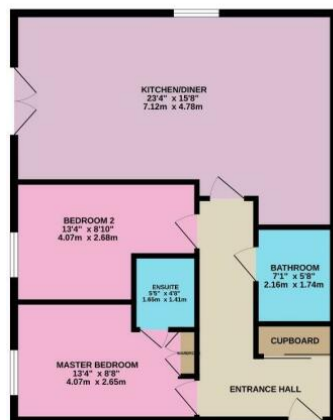

TOTAL FLOOR AREA: 697 sq.ft. (64.8 sq.m.) approx.
We have endeavored to make this plan as accurate as possible, but we cannot be held responsible for any errors or omissions. The plan is for information only and should not be used for any other purpose.

- FIRST FLOOR FLAT
- TWO DOUBLE BEDROOMS
- EN-SUITE & HOUSE BATHROOM
- MODERN KITCHEN & BATHROOMS
- EXTREMELY WELL PRESENTED
- OPEN PLAN LIVING/ KITCHEN
- FEATURE BALCONY
- SECURE GATED PARKING
- CLOSE TO M1 MOTORWAY LINKS
- IDEAL FTB, INVESTOR OR COUPLE PURCHASE

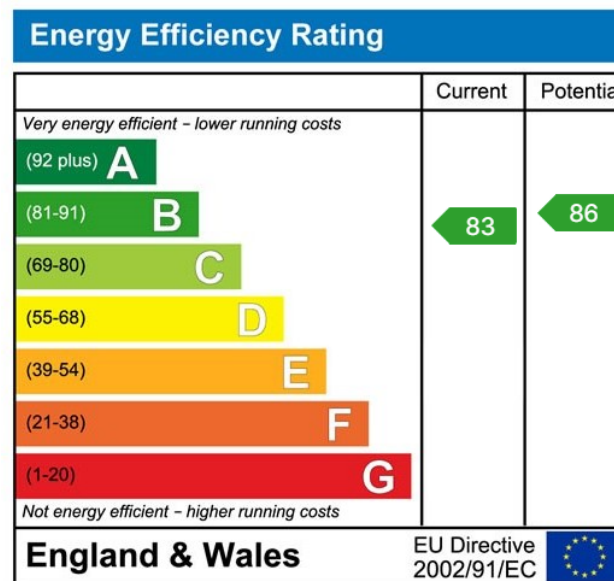

Lancasters Property Services
Property Professionals For Over 230 Years
 Independent Estate Agents, Surveyors & Property Management
Email: mail@lancasters-property.co.uk
 In association with Lancasters Property Management Ltd.

Lancaster House, 20 Market St.
Penistone S36 6BZ
 Tel: (01226) 763307