



Glossop Road, Little Hayfield, High Peak, SK22 2NR

Guide Price £1,075,000

5 5 3



Nestled in an idyllic setting, this exceptional five-bedroom luxury detached home has been meticulously restored to blend modern elegance with versatile, stylish living spaces. Enveloped by breath-taking panoramic views and pristine open countryside, this home offers a serene retreat designed for sophisticated living.

Nestled in the heart of the breath-taking Peak District National Park, The Nook is a beautifully restored detached stone property that seamlessly blends historic charm with modern elegance. Thoughtfully designed to highlight its natural surroundings, this stunning home offers exceptional space and light throughout. At the centre of the home is a bright, open-plan kitchen and dining area—a perfect gathering spot that opens directly onto the outdoors through French doors, inviting al fresco dining and relaxation. Two elegant reception rooms boast charming period features and cozy open fireplaces, while five spacious double bedrooms each enjoy a unique, bespoke en-suite.

Situated on a raised, private plot, The Nook offers unobstructed, panoramic views of the surrounding countryside. With footpaths and bridleways to Kinder Scout and the Pennine Bridleway right outside your door, the property provides immediate access to nature and adventure. Ideally located midway between Hayfield and Glossop, residents enjoy easy connections to the motorway, nearby train stations, and regular services to both Manchester and Sheffield.

Ground Floor

Entrance

Enter this stunning property through a composite entrance door that opens into an inviting entrance hallway. Here, stairs lead up to the first floor, while convenient access is provided to the library and the inner hall.

Inner Hall

The inner hall connects to the kitchen-diner, the downstairs cloakroom, and the left side of the property, where you'll find a selection of well-appointed bedrooms.

Library



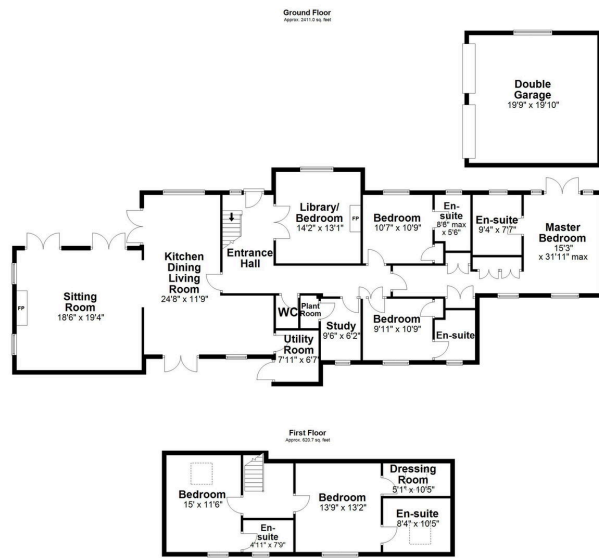

Total area: approx. 3031.7 sq. feet
 Draft Plan For Guidance Purposes Only All measurements are to walls, windows, doors, and openings including fire escape and stairs and are shown for information only. This document is not to be relied upon as a representation of the actual floor plan or of the property.
 The Nook, Glossop Road, Little Hey Field

- LUXURY DETACHED HOME
- FIVE DOUBLE BEDROOMS & EN-SUITE BATHROOMS
- FULLY RESTORED TO A STUNNING STANDARD THROUGHOUT
- STYLISH & FLEXIBLE ACCOMMODATION
- RENNOVATION INCLUDING REWIRING, ROOFING, WINDOWS, HEATING & DRAINAGE SYSTEM WITH STUNNING COUNTRYSIDE VIEWS
- EFFICIENT AIR SOURCE HEAT PUMP SYSTEM
- LARGE DRIVEWAY & DOUBLE GARAGE
- 1/2 ACRE PLOT ON PRIVATE GATED GROUNDS
- LOCATED WITHIN THE PEAK DISTRICT NATIONAL PARK

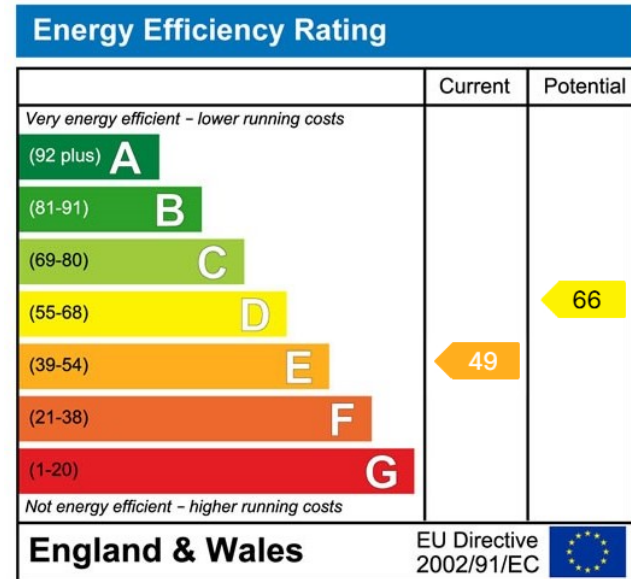

Lancasters Property Services
 Property Professionals For Over 230 Years
 Independent Estate Agents, Surveyors & Property Management
 Email: mail@lancasters-property.co.uk
 In association with Lancasters Property Management Ltd.

Lancaster House, 20 Market St.
 Penistone S36 6BZ
 Tel: (01226) 763307