



Sheffield Road, Penistone, S36 6HE

Offers In Region Of £134,950

 2  1  1



TAKE A LOOK AT THIS! A WELL PRESENTED TWO DOUBLE BEDROOM STONE FRONTED TERRACE PROPERTY, WHICH IS SITUATED WITHIN CLOSE PROXIMITY TO THIS POPULAR PENNINE MARKET TOWN. BEING RECONFIGURED ON THE FIRST FLOOR TO OFFER FLEXIBLE AND SPACIOUS ACCOMMODATION.

- STONE FRONTED TERRACE
- WELL PRESENTED THROUGHOUT
- ENCLOSED GARDEN
- CLOSE TO LOCAL SCHOOLS
- EXCELLENT TRANSPORT LINKS
- TWO DOUBLE BEDROOMS
- RECONFIGURED ON FIRST FLOOR
- OFF STREET PARKING
- IMMEDIATE ACCESS TO PENISTONE CENTRE
- IDEAL FTB, INVESTOR OR DOWNSIZER PURCHASE

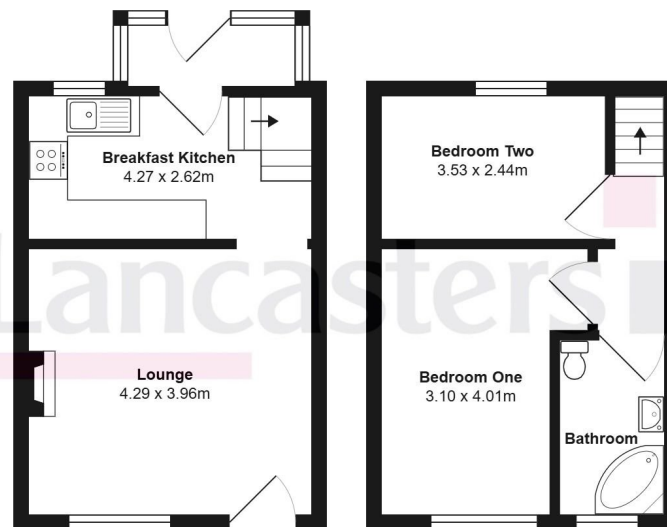

All measurements are approximate and for display purposes only