



Denby Park Drive, Grange Moor, Wakefield, WF4 4EE

Fixed Price £300,000

 2  1  1



A stunning bungalow offering 2 double bedroom whilst enjoying spacious open plan living and gardens to front and rear. The property occupies a sought after village position on the outskirts of open countryside, has off road parking and an attached single garage.

- STUNNING OPEN PLAN LIVING
- DINING KITCHEN
- GARDENS TO FRONT & REAR
- OPEN COUNTRYSIDE
- NO UPWARDS CHAIN
- 2 DOUBLE BEDROOMS
- PARKING & GARAGE
- LOCAL SERVICES & AMENITIES
- ACCESS TO BUS & TRAIN SERVICES
- M1 & M62 ACCESS

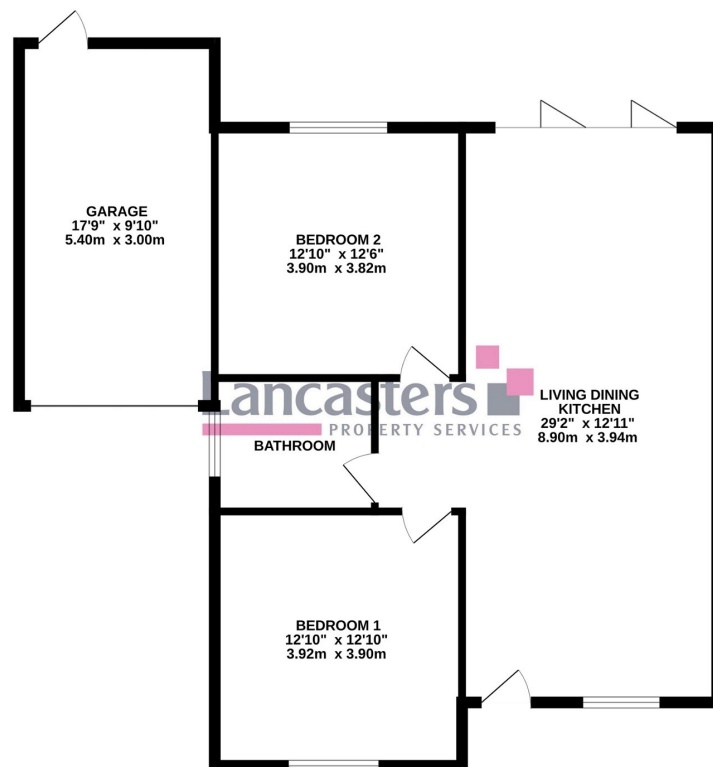

Whilst every attempt has been made to ensure the accuracy of the floorplan contained here, measurements of floors, windows, rooms and any other items are approximate and no responsibility is taken for any error, omission or mis-statement. This plan is for illustrative purposes only and should be used as such by any prospective purchaser. The services, systems and appliances shown have not been tested and no guarantee as to their operability or efficiency can be given.
Made with Metropex ©2024