



## Heathercliff Way, Penistone, Sheffield, S36 6FN

Offers Over £399,950

 4  2  2



- EXCEPTIONAL THROUGHOUT
- BI-FOLDING DOORS OPENING TO A SOUTH FACING LANDSCAPED GARDEN
- PARKING FOR SEVERAL VEHICLES
- SOUGHT AFTER LOCATION
- LOCAL SERVICES & AMENITIES
- AMAZING OPEN PLAN LIVING KITCHEN & LOUNGE
- 4 BEDROOMS
- PART EXCHANGE CONSIDERED UPTO £250,000
- TRANS PENNINE TRAIL
- OPEN COUNTRYSIDE & M1 ACCESS

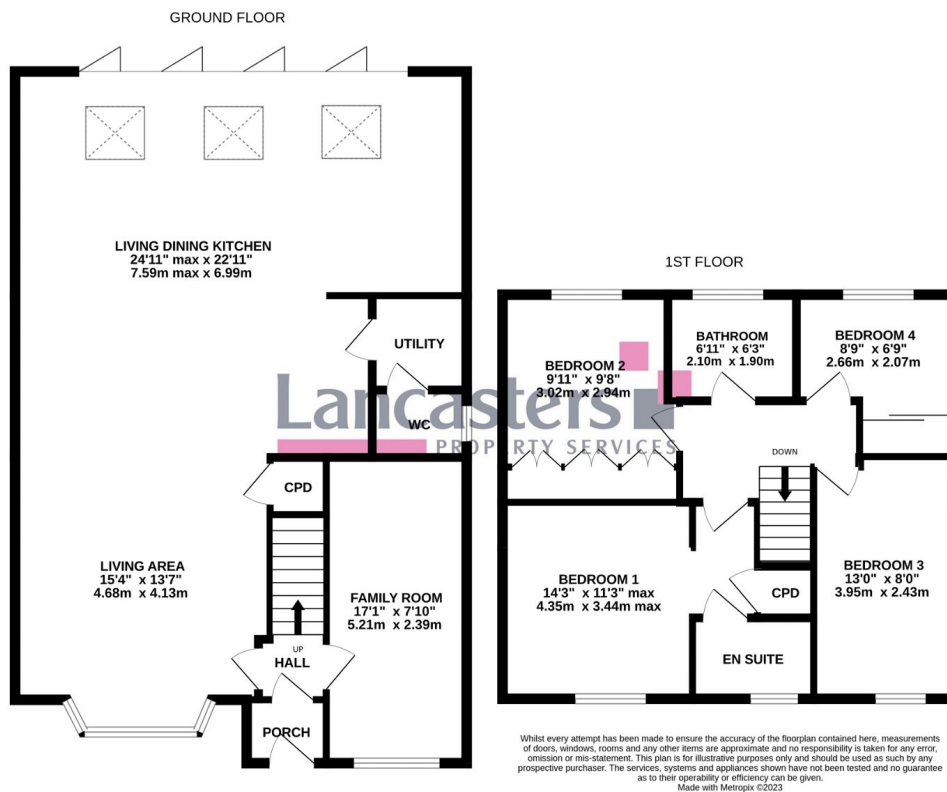

A stunning 4 bedroom detached family home modernised to an exceptional standard throughout boasting a substantial ground floor extension with bi-folding doors opening directly onto the rear garden inviting an abundance of natural light indoors.