

Experience, Knowledge, Drive and Service

We are an Independent Estate Agency with a great wealth of experience. Covering Chessington, North Cheam, Morden, Worcester Park, Stoneleigh, West Ewell and Epsom, the partners have well over 160 years of experience in the industry, many of which have been spent working locally. We feel that we bring many great characteristics to the marketplace, in particular the 'know how' required to deliver excellent results, the drive required to work as hard as it takes for our customers and a real desire to deliver superb levels of service. We know that moving house, or indeed letting one, can be complicated and stressful. We also respect that in many cases we are dealing with your home and all the emotional ties that go with it. We understand and will always do what it takes to make matters run as smoothly as possible.

We offer a comprehensive list of services including Sales, Lettings and Mortgage Advice. Whatever your circumstances and plans, please contact us, we will be only too happy to help and all of our advice and guidance is free. All of our valuations and lettings appraisals are also free and we operate a no sale/let - no fee policy

- Knowledgeable team with over 160 years experience
- All viewings accompanied
- No upfront fees and no sale/let - no fee policy
- Superb internet coverage with free enhanced marketing packages
- Computer linked offices
- Floorplan and video tours on most Property Details
- Tailored service levels for Landlords
- Agreed sales fully managed through to completion
- Always competitive on fees

Free Valuations

If you are considering selling or letting your property we can carry out a free, no obligation valuation and market appraisal. Rest assured that with our unrivalled experience and local knowledge you will be given expert information, advice and guidance.

Mortgage Advice

We have a free Mortgage Service available from our Independent Financial Adviser. We can advise on products from the whole of the mortgage market and of course the whole process is managed from application to completion including regular progress updates for all our clients.

11 Plough Road, West Ewell, Surrey



- Edwardian Cottage
- Two Double Bedrooms
- First Floor Bathroom
- Two Receptions
- Private Rear Garden
- No Onward Chain
- Viewings Highly Recommended
- Potential To Extend STPP

Guide Price

£425,000 Freehold

Ground Floor

Approx. 39.8 sq. metres (428.0 sq. feet)

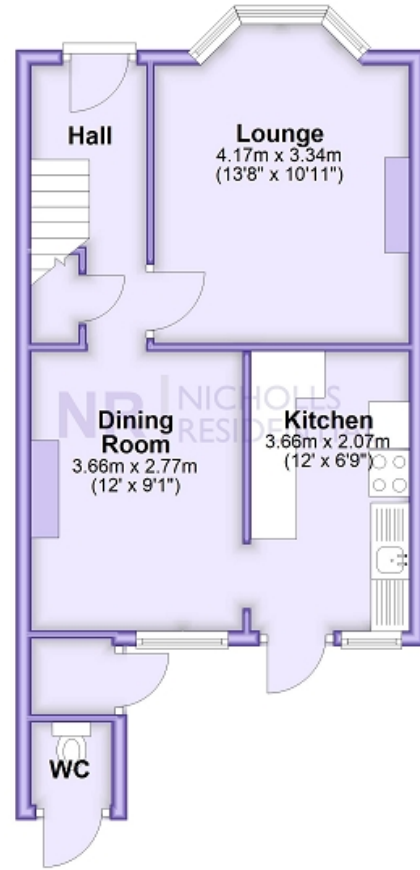

First Floor

Approx. 36.5 sq. metres (393.2 sq. feet)



This floor plan and related floor plans are for layout guidance only. Not drawn to scale unless stated. All measurements are approximate. Whilst every care is taken in the preparation of this plan, please check all dimensions before making any decision reliant upon them.

Guide Price: - £425,000 to £440,000 "Ewhurst Terrace" built 1906. Nicholls Residential are pleased to offer to the market this Edwardian terrace cottage. The property is situated in one of the areas prime roads close to schools, shops and transport links. The ground floor accommodation consists of an entrance hall, a cosy front sitting room with fireplace and bay window to the front, with the dining room and kitchen set to the rear. Access to the garden can be gained via the kitchen. To the first floor there are two double bedrooms, both fitted with wardrobes, and a bathroom. The property benefits from double glazed windows and gas central heating (new boiler installed 2023) and there is potential to extend, subject to planning permission.

Outside to the rear there is a private garden laid to lawn with a small patio area and path leading through. Viewing is highly recommended; this really is a delightful home.



Energy Efficiency Rating		
	Current	Potential
Very energy efficient - lower running costs		
(92+) A		
(81-91) B		90
(69-80) C	70	
(55-68) D		
(39-54) E		
(21-38) F		
(1-20) G		
Not energy efficient - higher running costs		
England, Scotland & Wales EU Directive 2002/91/EC		

The energy efficiency rating is a measure of the overall efficiency of a home. The higher the rating the more energy efficient the home is and the lower the fuel bills will be.

