



Apartment

127 SPRINGBANK, NORWICH, NR1 2LH

PCM

£1,000

FEATURES

- Top Floor Flat
- Well Presented
- Two Bedrooms
- Sitting/Dining Room



2 Bedroom Apartment located in Norwich

Welcome to this spacious two-bedroom apartment located in the area of Springbank, Norwich. Situated close to the city, this ex-local authority property offers a perfect blend of urban convenience and countryside.

Upon entering, you will be greeted by a well-presented interior that exudes warmth and comfort. The apartment boasts two cosy bedrooms, ideal for a small family or those looking for a guest room or home office space.

One of the standout features of this property is the countryside views that can be enjoyed from the comfort of your own home.

Don't miss out on the chance to make this great apartment your new home. Contact us today to arrange a viewing and experience the charm of Springbank living for yourself.

SECOND FLOOR

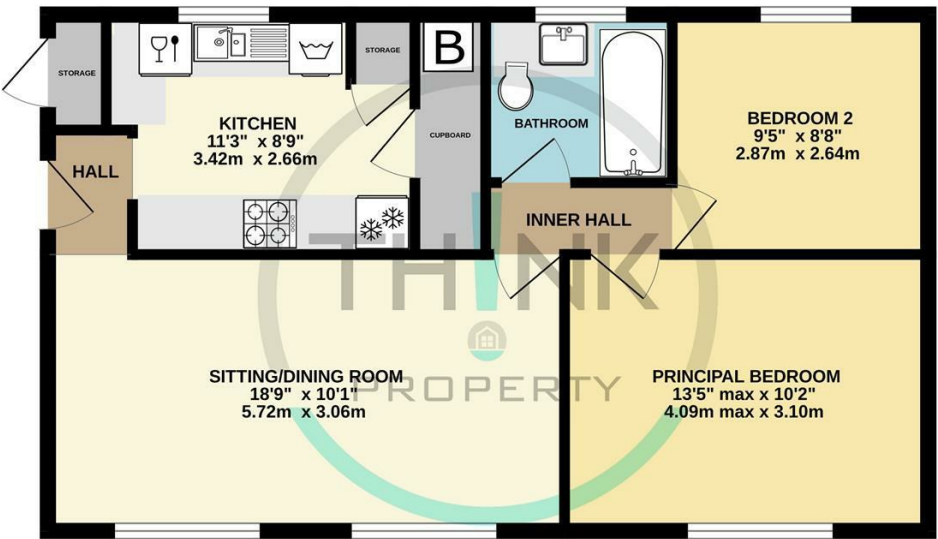

Whilst every attempt has been made to ensure the accuracy of the floorplan contained here, measurements of doors, windows, rooms and any other items are approximate and no responsibility is taken for any error, omission or mis-statement. This plan is for illustrative purposes only and should be used as such by any prospective purchaser. The services, systems and appliances shown have not been tested and no guarantee as to their operability or efficiency can be given.
Made with Metropix ©2024

Call us on
01603 338433

norwich@thinkproperty.ltd
<https://www.thinkproperty.ltd/>

Council Tax Band
A

Energy Efficiency Rating		
	Current	Potential
Very energy efficient - lower running costs		
(92 plus) A		
(81-91) B		
(69-80) C	75	75
(55-68) D		
(39-54) E		
(21-38) F		
(1-20) G		
Not energy efficient - higher running costs		
England & Wales		EU Directive 2002/91/EC

Agents Note: Whilst every care has been taken to prepare these particulars, they are for guidance purposes only. All measurements are approximate and are for general guidance purposes only and whilst every care has been taken to ensure their accuracy, they should not be relied upon and potential buyers are advised to recheck the measurements.

